

T-2 Buckeye "Camouflaged Trainer"

Historie

CZ

Od roku 1959, kdy vstoupil do služby, až do roku 2004, kdy byl North American T-2 Buckeye vyřazen z výcvikového programu, byl prvním proudovým strojem námořnictva USA, na kterém létali do výcviku zařazení letci. US Navy objednalo tento letoun v roce 1956, s tím, že v rámci několikastupňového výcviku bude zařazen za vrtulový T-28 Trojan. Sloužil k seznámení s proudovou technikou před přechodem na bojové stroje. První prototyp označený YT-2J-1 vzletl 31. 1. 1958. První verze T2J-1 byla jednomotorová. Poháněl ji motor J34-WE-48. Této verze bylo postaveno 201 kusů, od roku 1962 byla v novém systému označování přeznačena na T-2A.

US Navy požadovalo úpravu na dvoumotorový stroj s větší bezpečností. Proto North American připravil a zavedl do výroby verzi T-2B se dvěma motory J60-P-4. Postaveno bylo 97 kusů, poté výroba přešla na verzi T-2C s motory J85-GE-4.

Té bylo postaveno 231 kusů. Bojové jméno společné pro všechny verze bylo Buckeye - jírovec neboli kaštan. T-2 Byly vyráběny v Columbusu v Ohiu a jírovec je státním stromem státu Ohio. Na konci své služby u US Navy byla část strojů upravena na terčové a označena DT-2B nebo DT-2C.

Kromě toho, že T-2 sloužily skoro padesát let k výcviku letců US Navy, byly také exportovány. Verzi označovanou T-2D odebralo letectvo Venezuely, T-2E složí v Řeckém vojenském letectvu.

V USA nyní létá několik T-2 jako soukromé jety.

rozpětí: 11,6 m, délka: 11,8 m, max. rychlost v úrovni moře: 862 km/h, dolet: 1723 km, dostup: 13 045 m

History

EN

North American T-2 Buckeye was the first US Navy jet trainer aircraft since 1959 when it entered service until 2004 when it was withdrawn from pilots' training program. It was ordered by the US Navy in 1956 as intermediate trainer for training conversion from T-28 Trojans. It served for jet powered aircraft familiarization prior conversion to combat aircraft.

The first prototype YT-2J-1 took off on January 1, 1958. The first version T2J-1 was powered by single J34-WE-48 jet engine. 201 machines of this version were produced and since 1962 when new designation system was introduced the aircraft was re-designated to T-2A.

For better safety the US Navy demanded the aircraft to be powered by two jet engines. Therefore North American designed and introduced T-2B version powered by two J60-P-4 jet engines. 97 machines of this version were produced and then the production switched to T-2C version powered by two J85-GE-4 jet engines.

T-2C was produced in 231 pieces. The combat name common to all versions was Buckeye - Ohio chestnut tree. T-2s were produced in Columbus Ohio and the buckeye is the Ohio's state tree. At the end of its career some US Navy machines were converted for target towing and re-designated DT-2B or DT-2C.

Except of the fact that T-2s served for training almost half a century they were also exported. T-2D was purchased by the Venezuelan Air Force; T-2E still serves with the Hellenic Air Force.

Several T-2s are in private hands in the USA.

Wingspan: 11.6 m, Length: 11.8 m, Max. Speed at sea level: 862 km/h, Range: 1,723 km, Service Ceiling: 13,045 m.

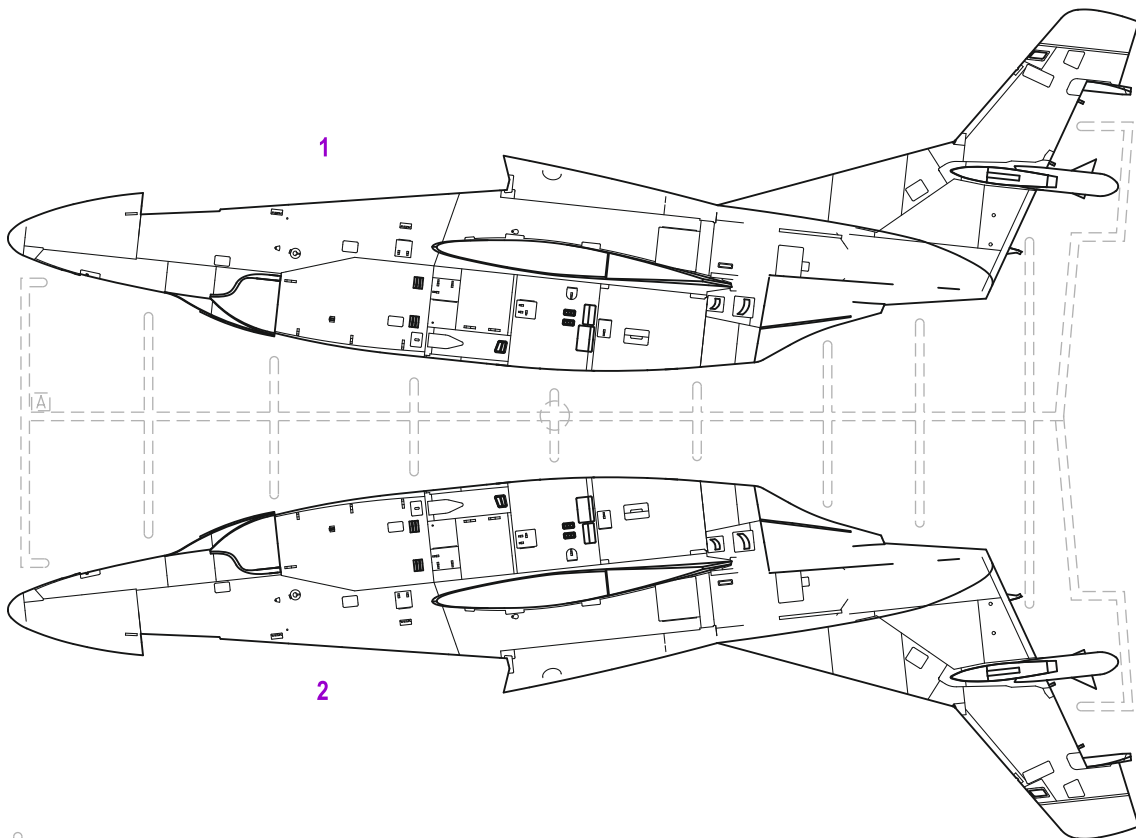

A

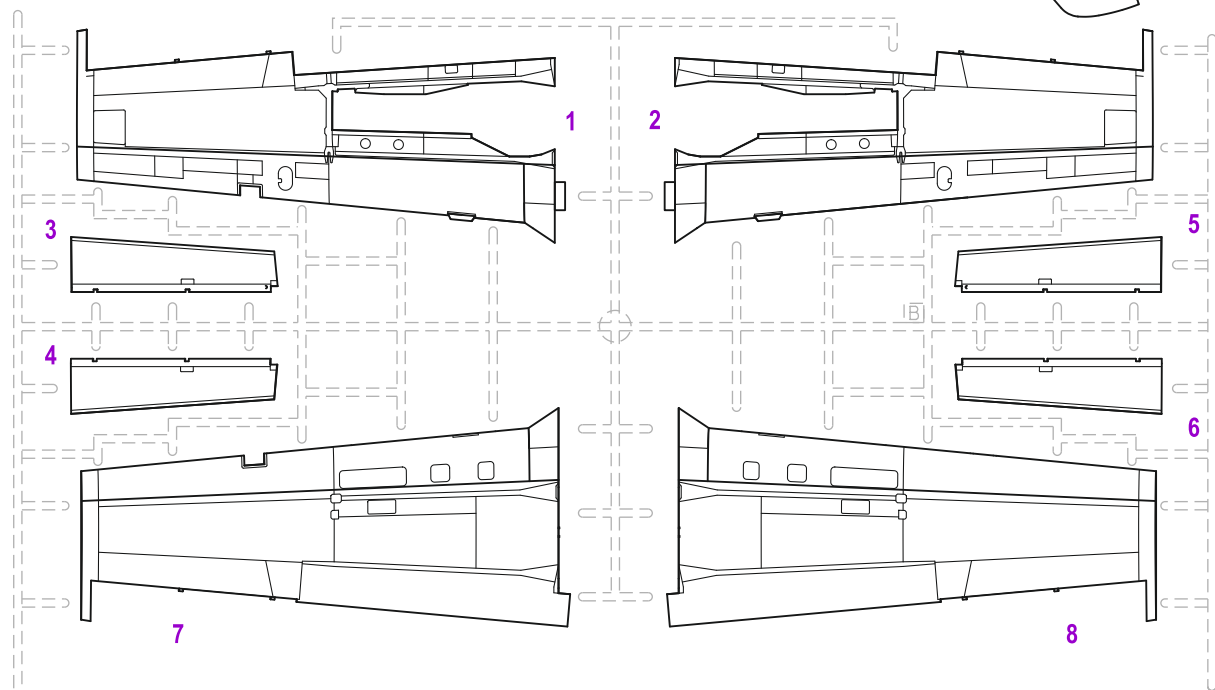

B

CLEAR Parts(CP)

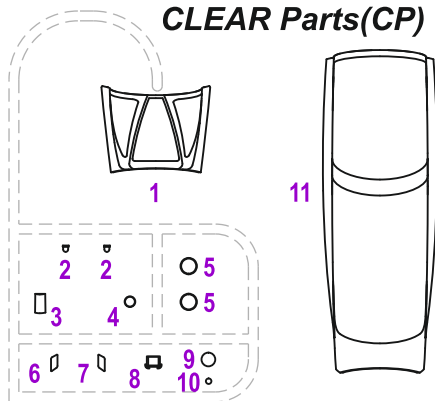

PUR Parts(PUR)

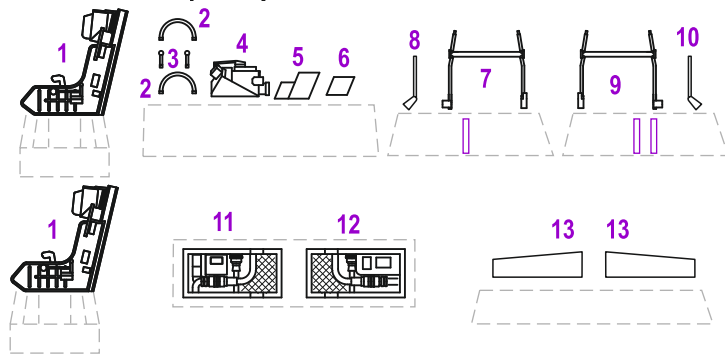

SYMBOLS



MOŽNOST VOLBY
OPTIONAL
NACH BELIEBEN
OPTION



POUŽÍŤ KYANOAKRYLÁTOVÉ LEPIDLO
INSTANT CYANOACRYLATE GLUE
ZYANOAKRYLÁTKLEBER
ADHÉSIF CYANOACRYLAT



OHNOUT
BEND
BIEGEN
COURBER



ZHOTOVIT NOVÉ
SCRATCH BUILD
FERTIGSTELLEN
ACHEVER



ŘEZAT/VRTAT
CUT OFF/DRILL
ENTFERNEN
DETACHER

GSI **A**
colours code

NATRÍT
COLOUR
FARBEN
PEINDRE

C

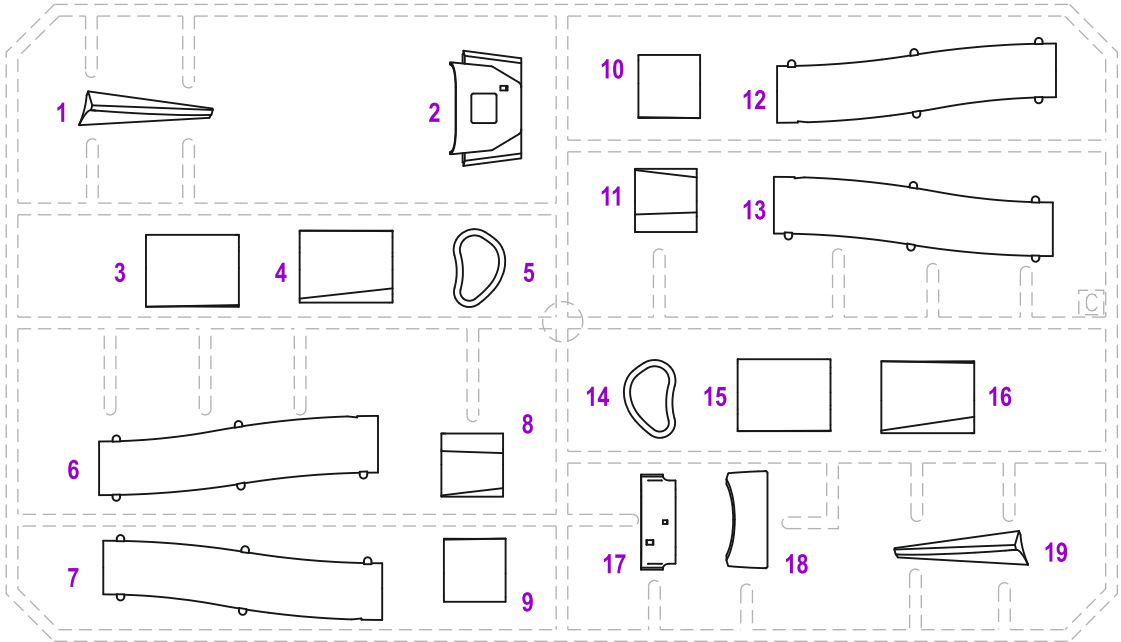

D

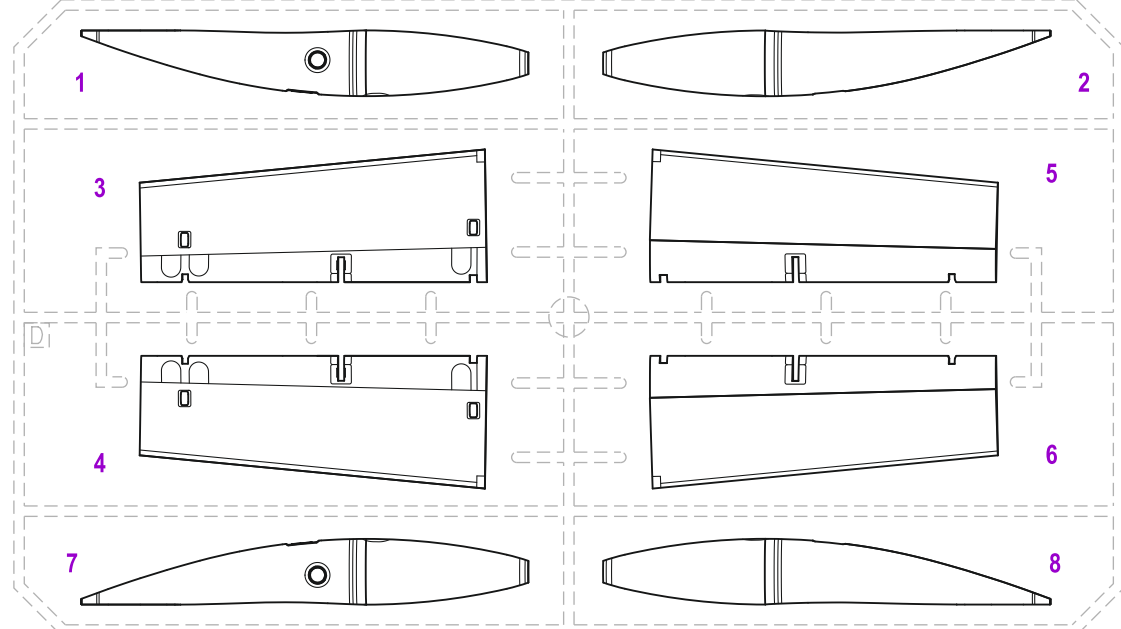

E

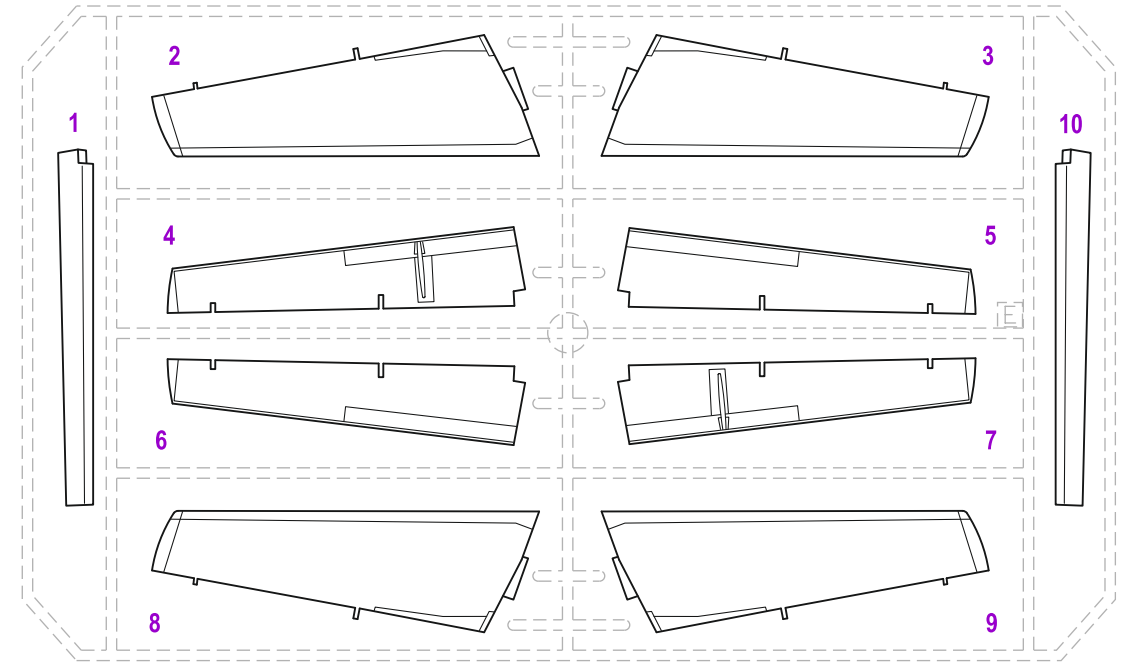

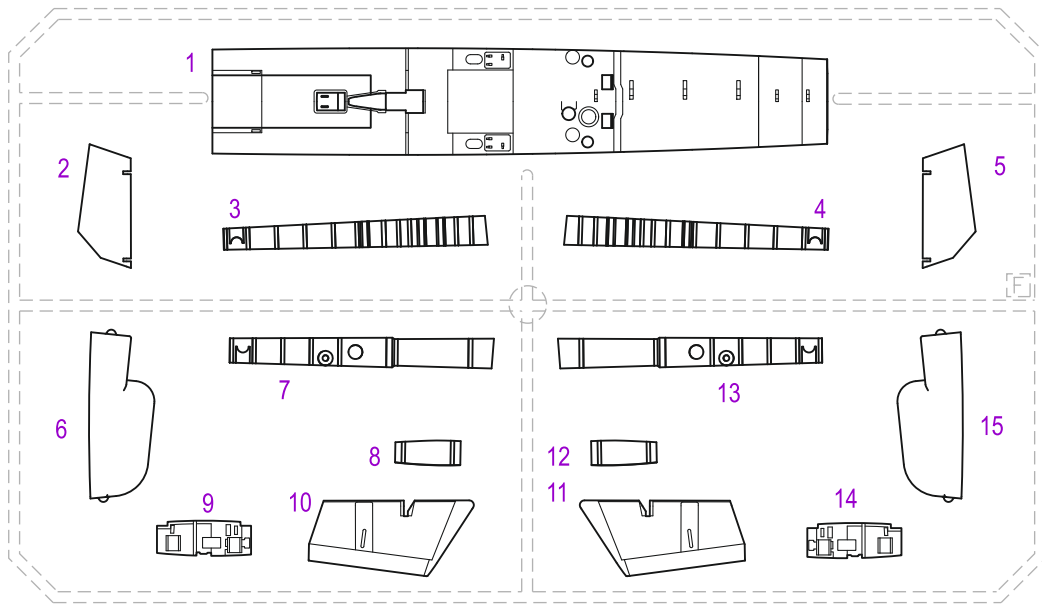
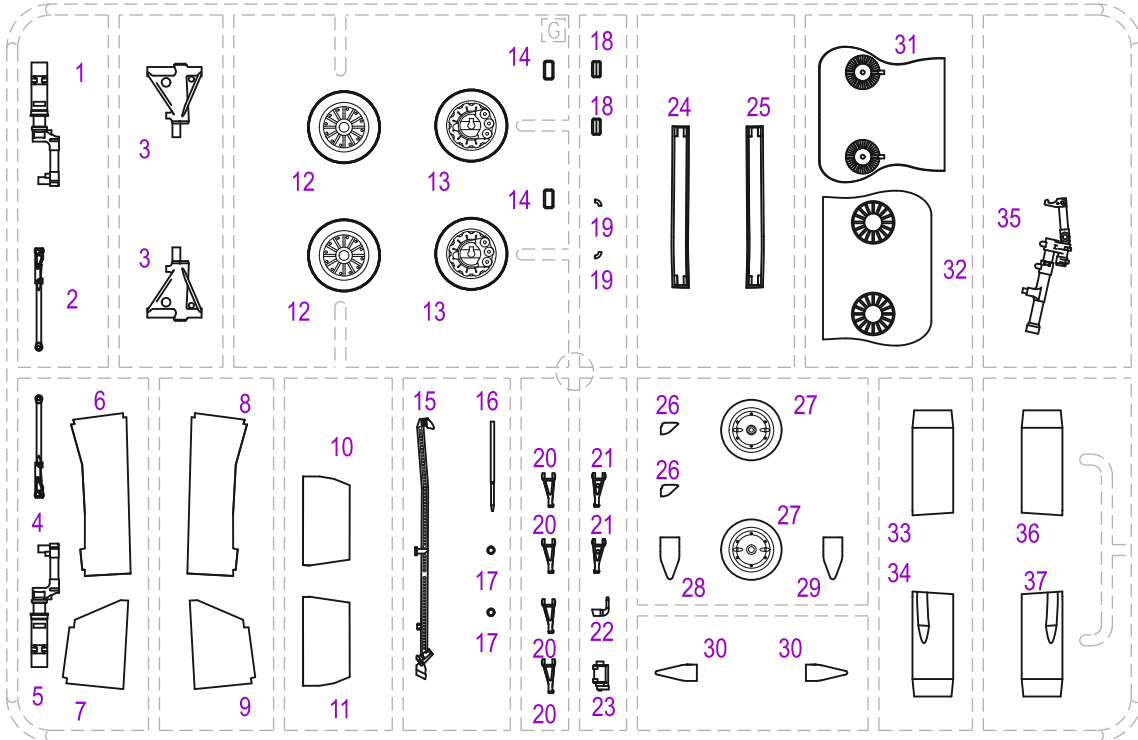
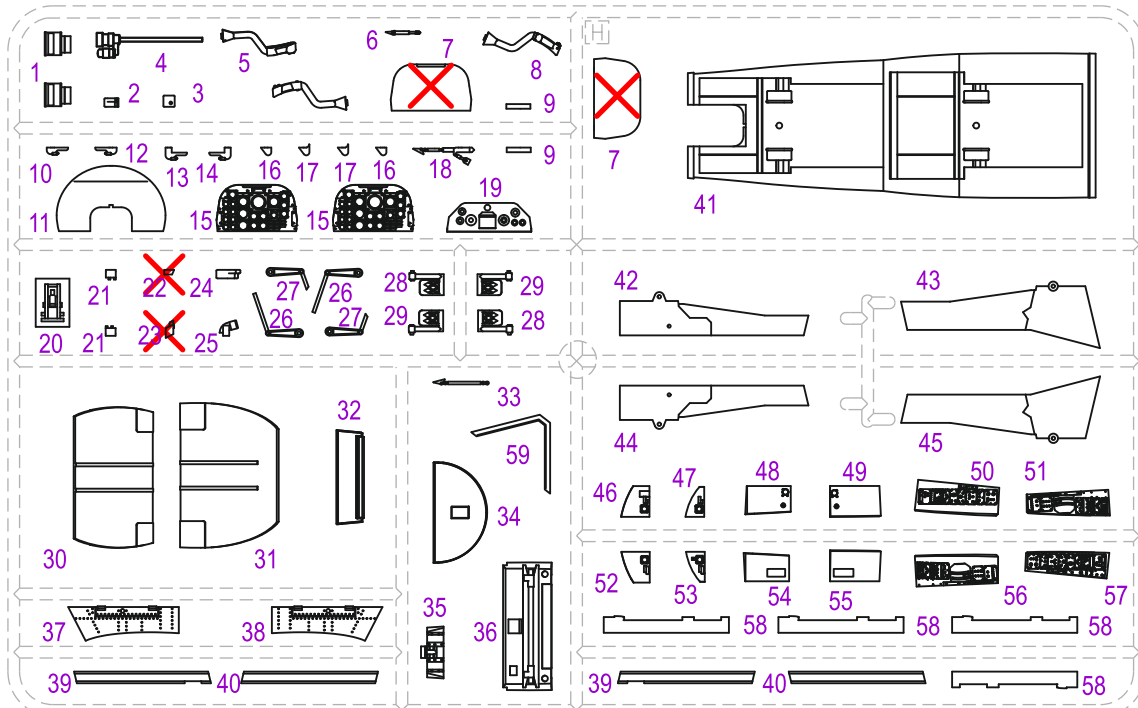
F**G****H**

Tento díl nepoužít
Do not use this part



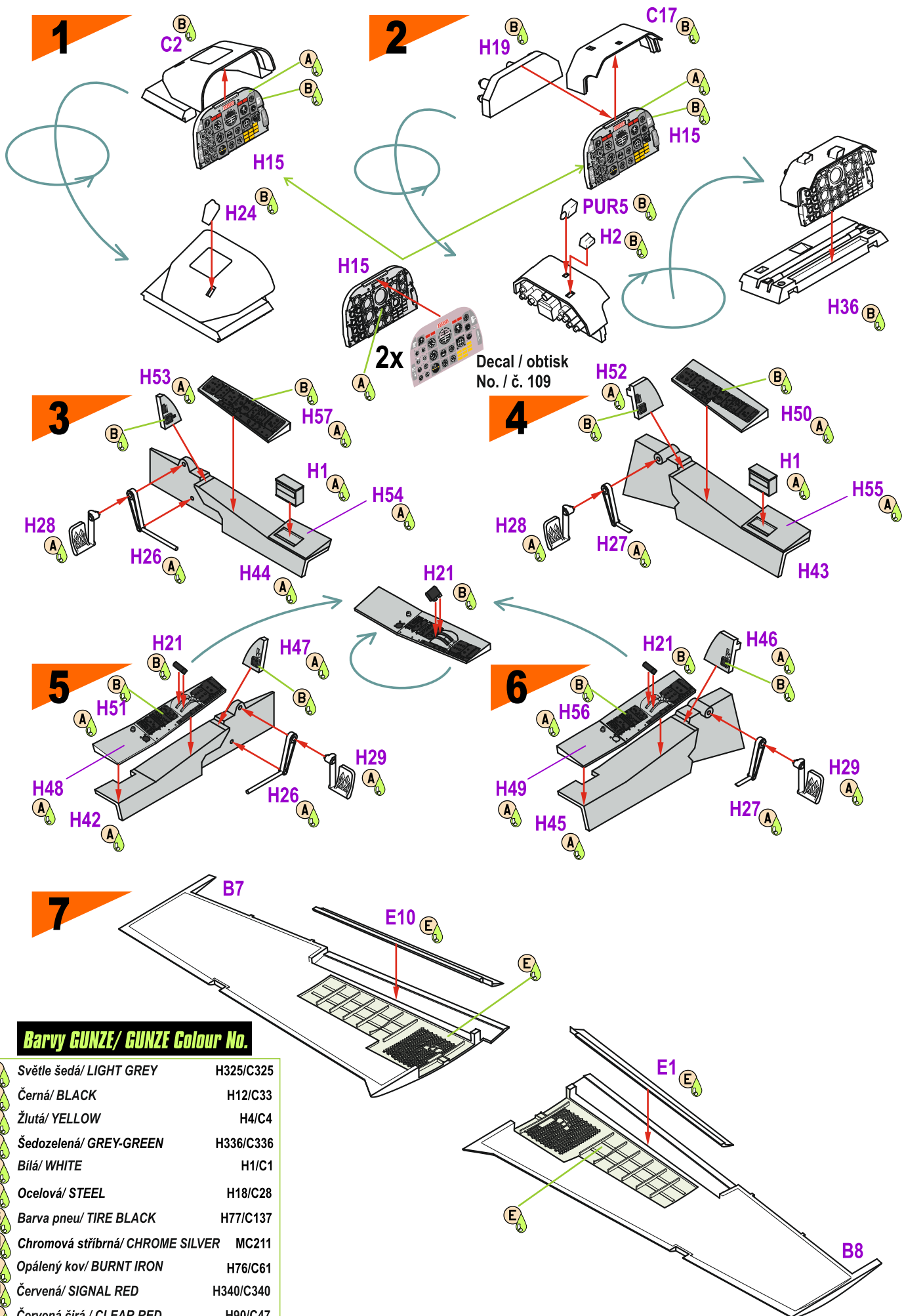

Barvy GUNZE/ GUNZE Colour No.

A	Světle šedá/ LIGHT GREY	H325/C325
B	Černá/ BLACK	H12/C33
C	Žlutá/ YELLOW	H4/C4
D	Šedozelená/ GREY-GREEN	H336/C336
E	Bílá/ WHITE	H1/C1
F	Ocelová/ STEEL	H18/C28
G	Barva pneu/ TIRE BLACK	H77/C137
H	Chromová stříbrná/ CHROME SILVER	MC211
I	Opálený kov/ BURNT IRON	H76/C61
J	Červená/ SIGNAL RED	H340/C340
K	Červená čirá / CLEAR RED	H90/C47

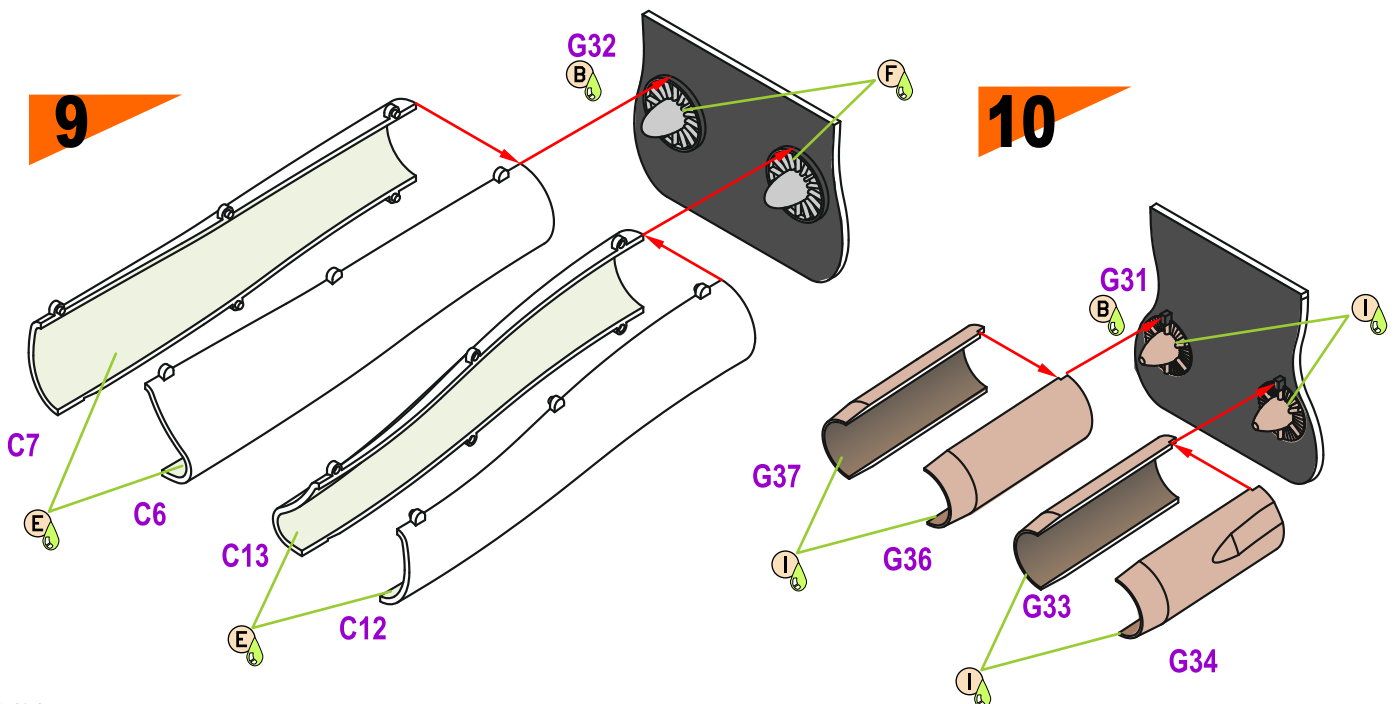
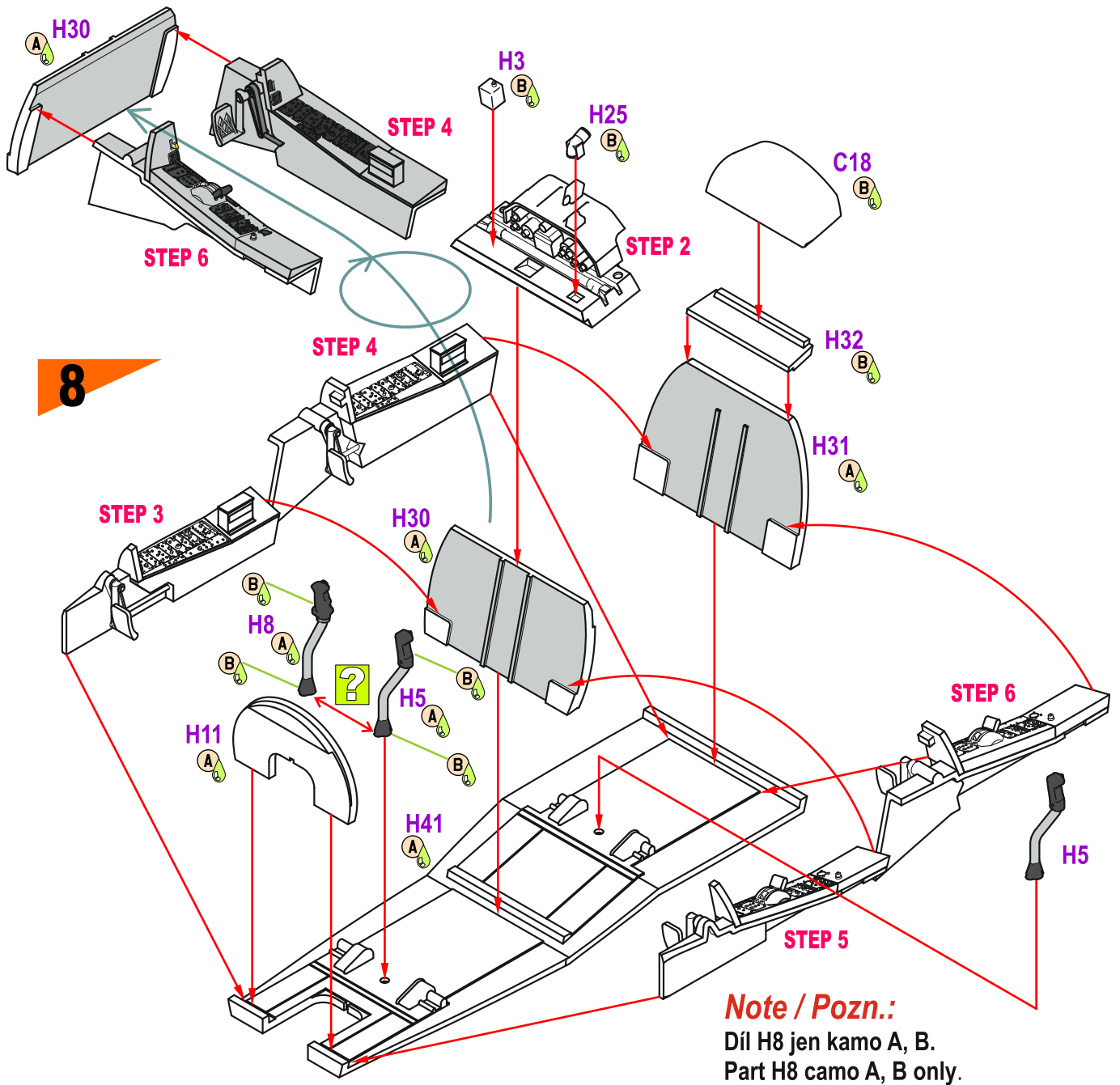

11

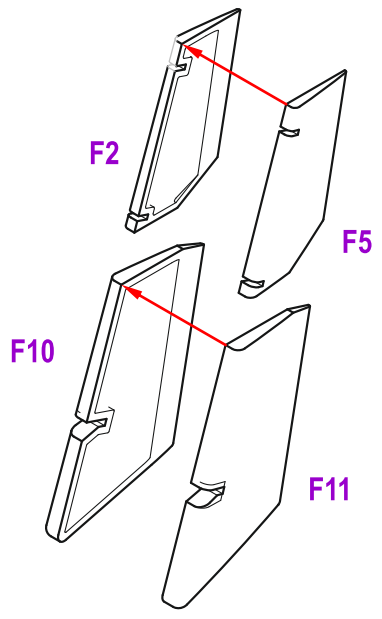

12 2x

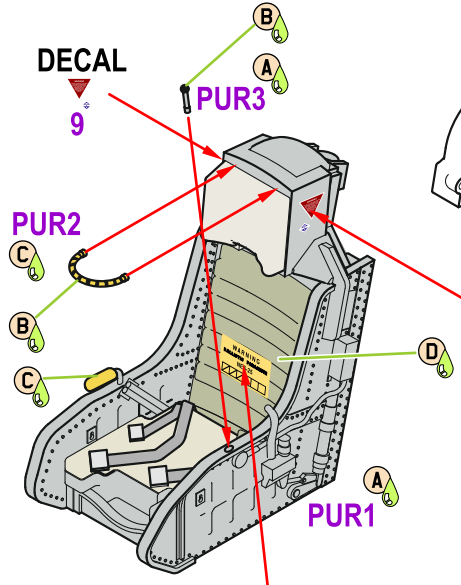

13

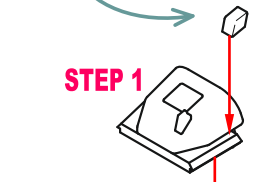
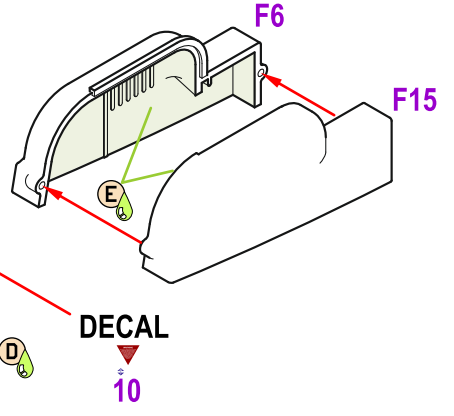

14

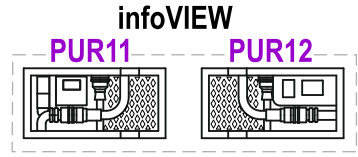
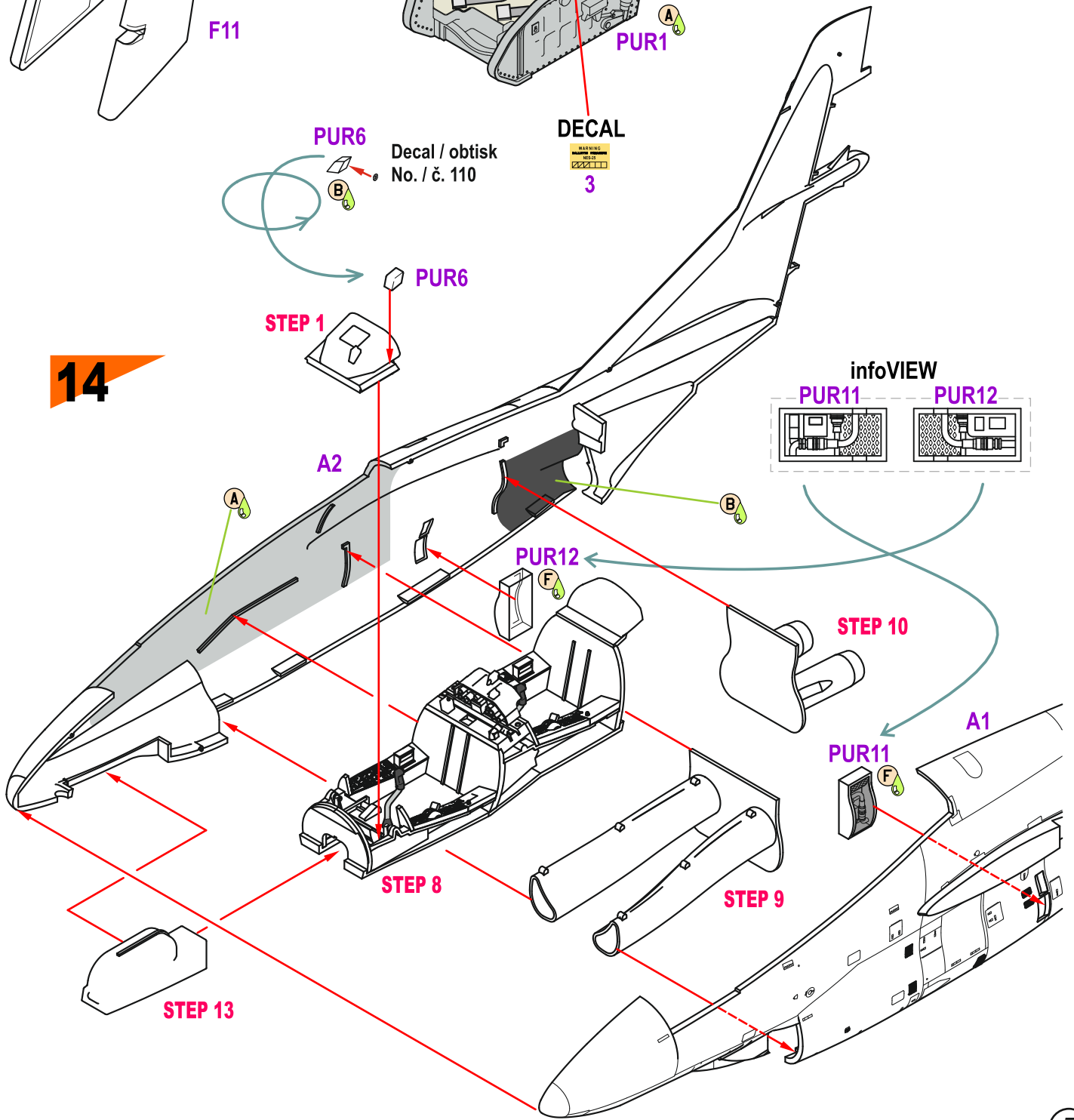

15

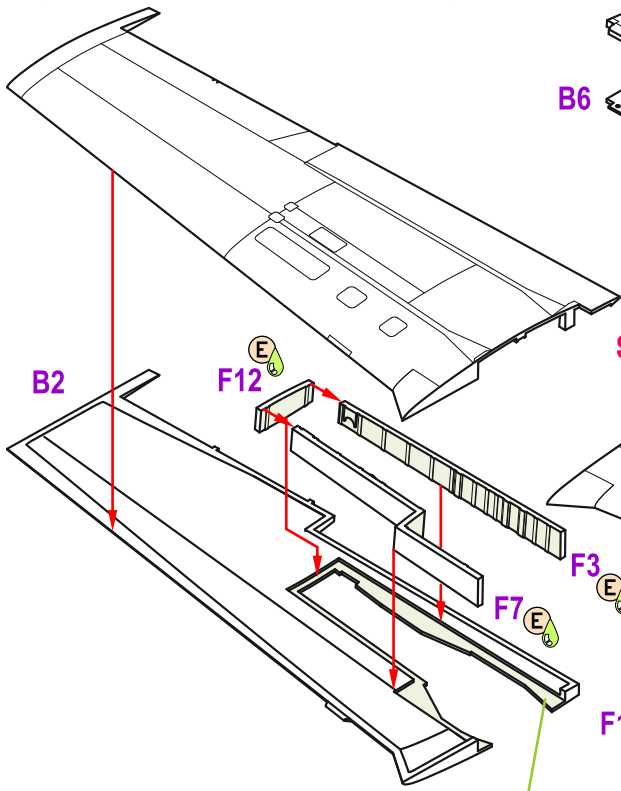

16

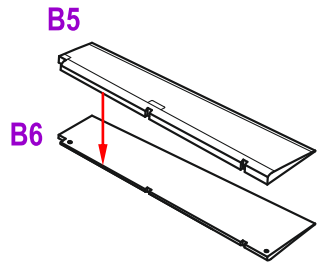

17

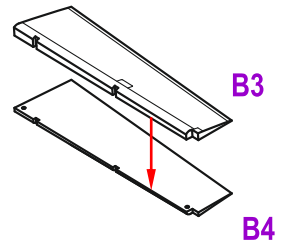

STEP 7

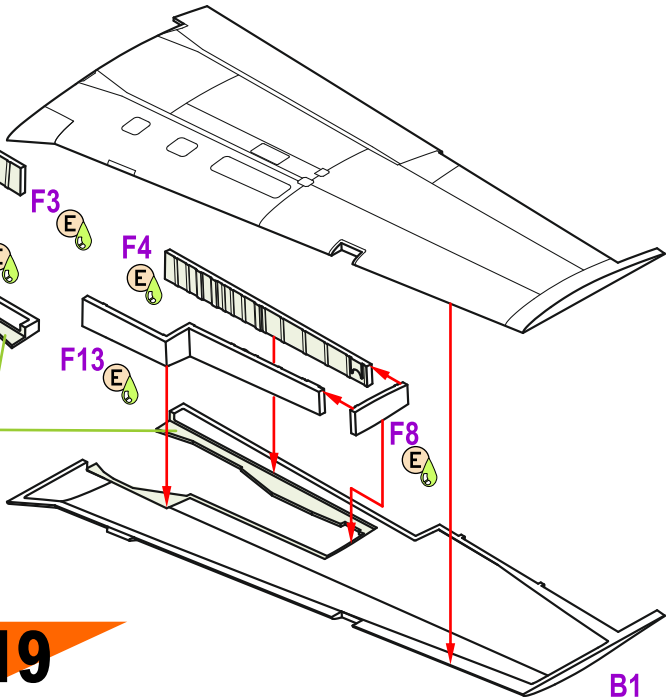

18

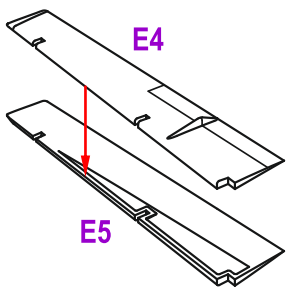

19

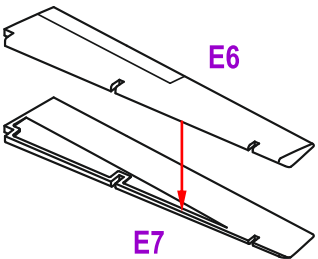

20

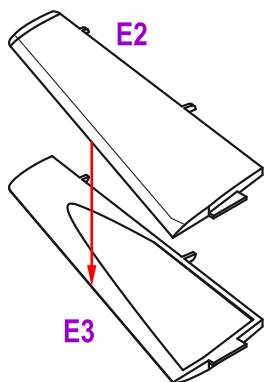

21

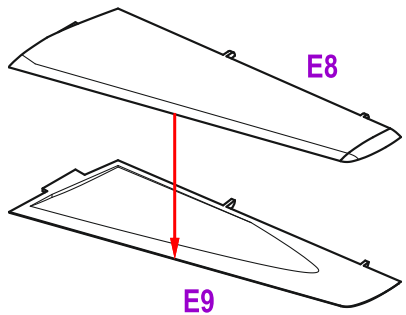

22

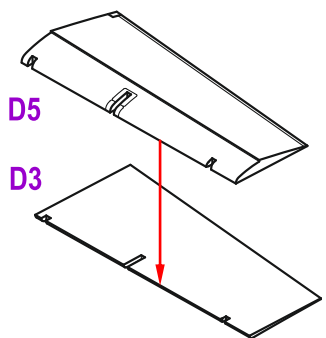

23

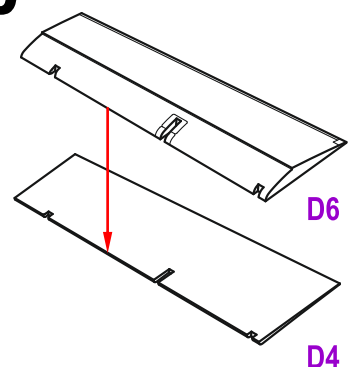

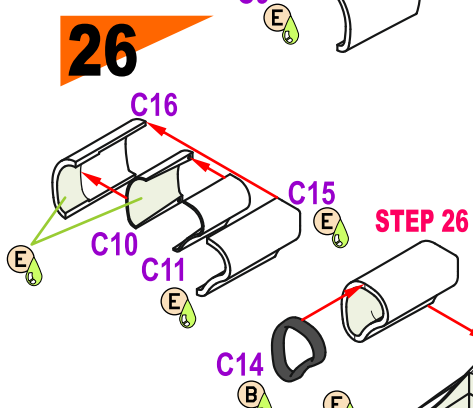
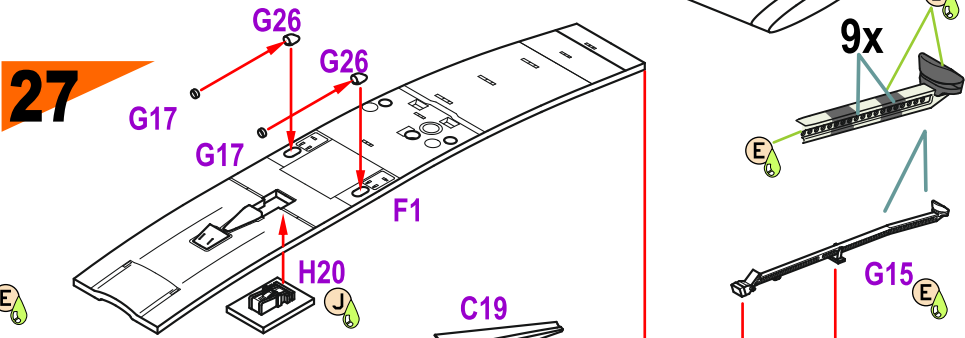
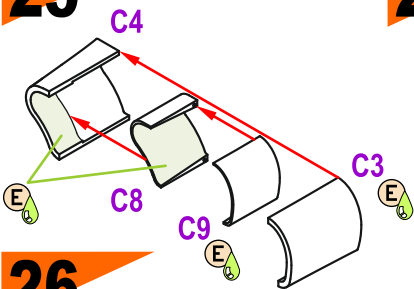
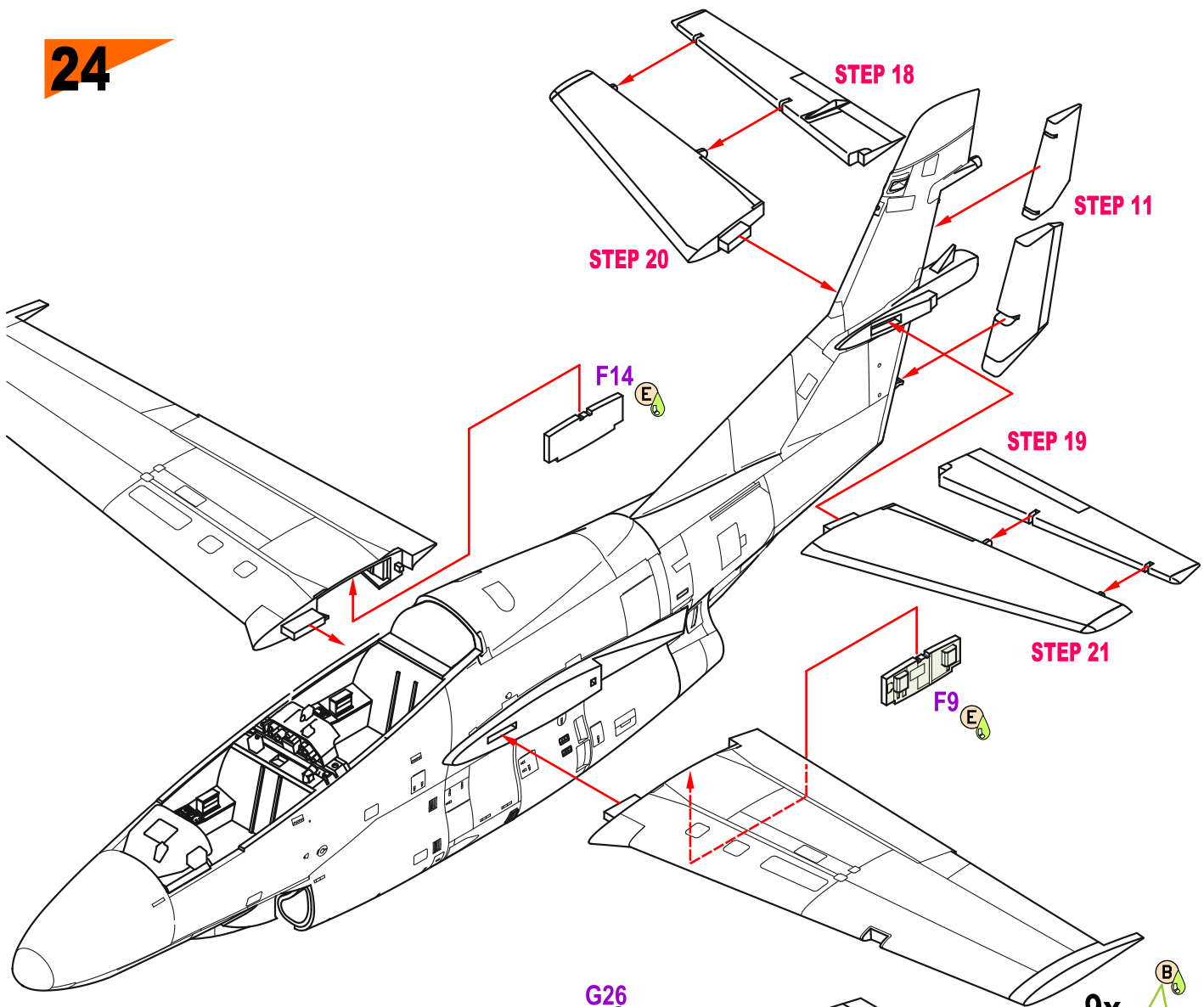

STEP 26

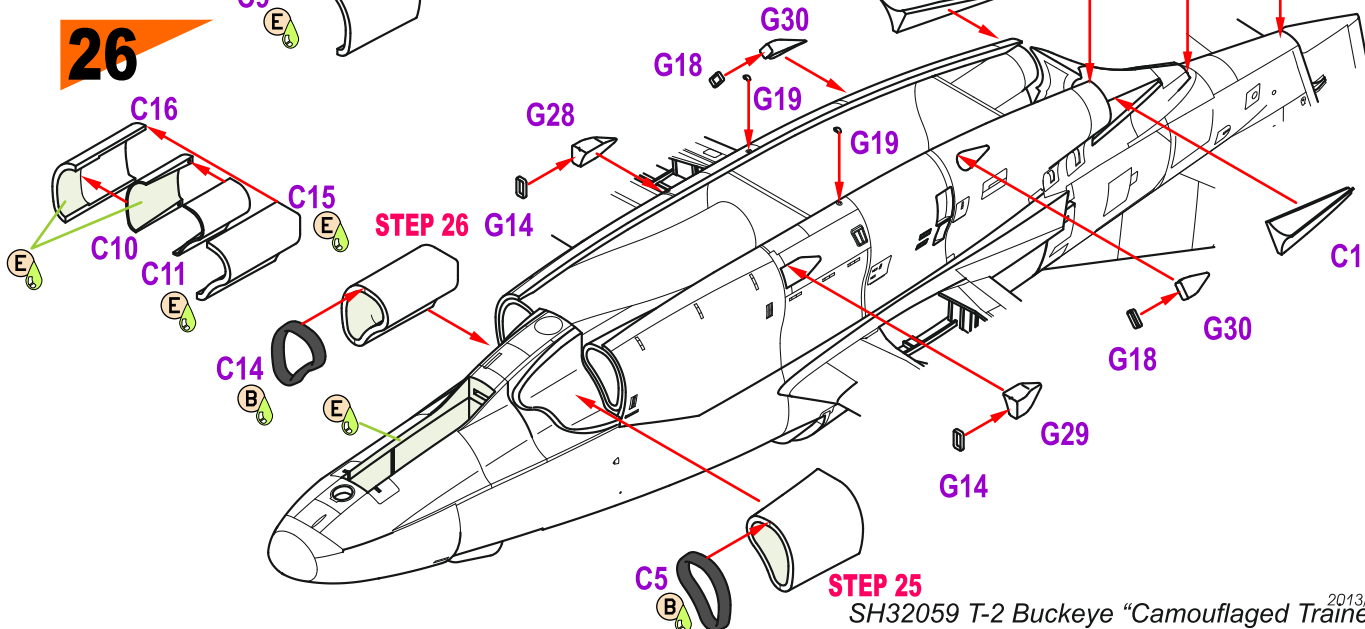

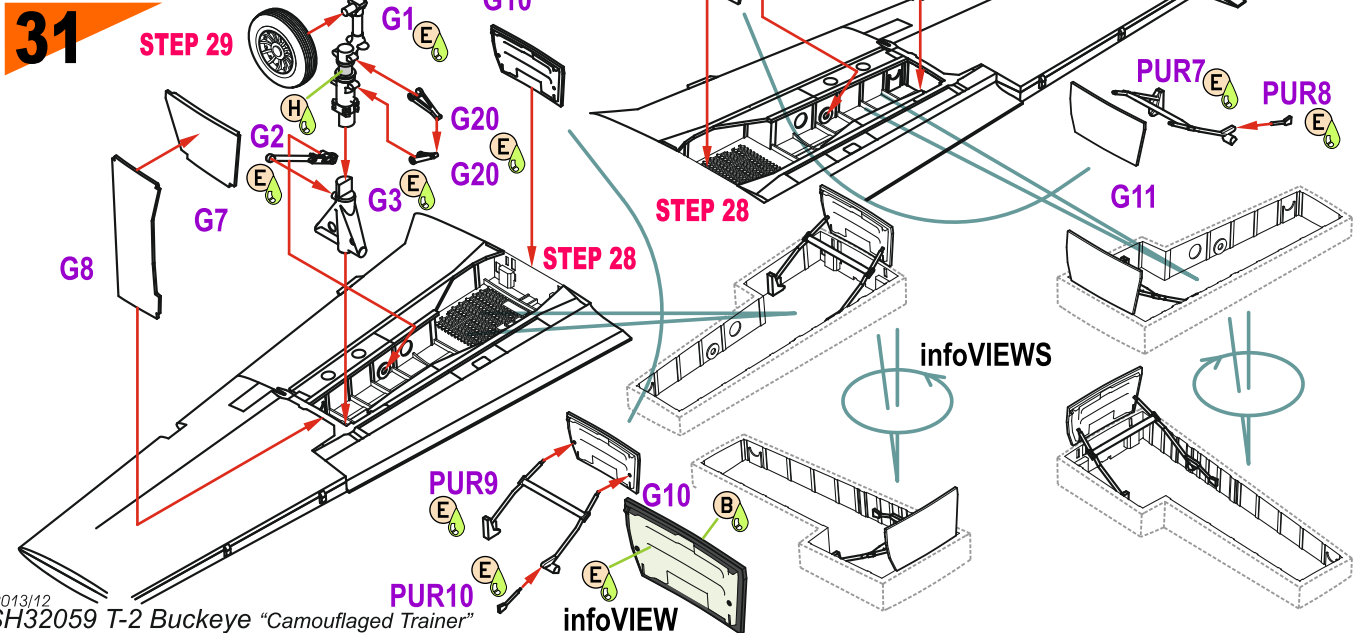
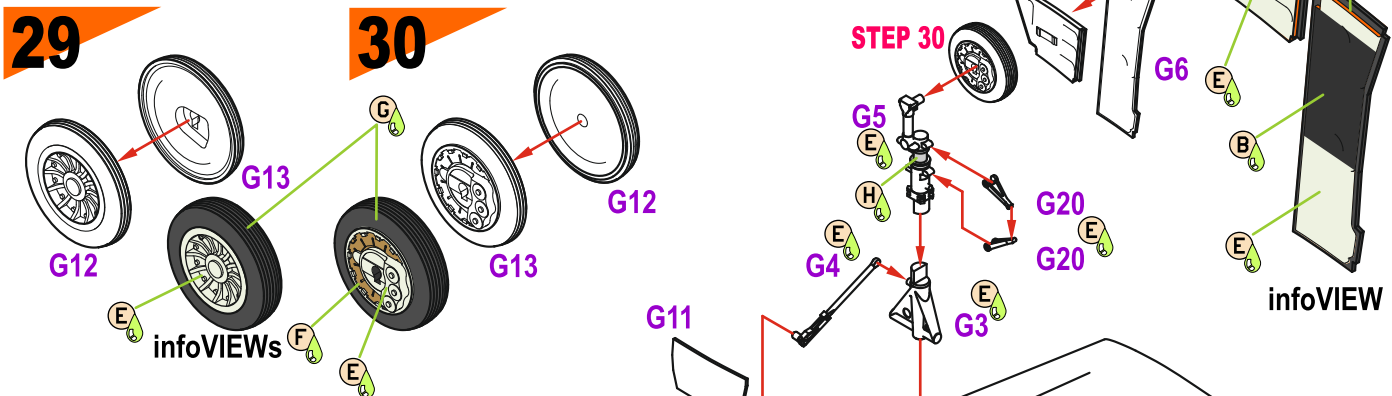
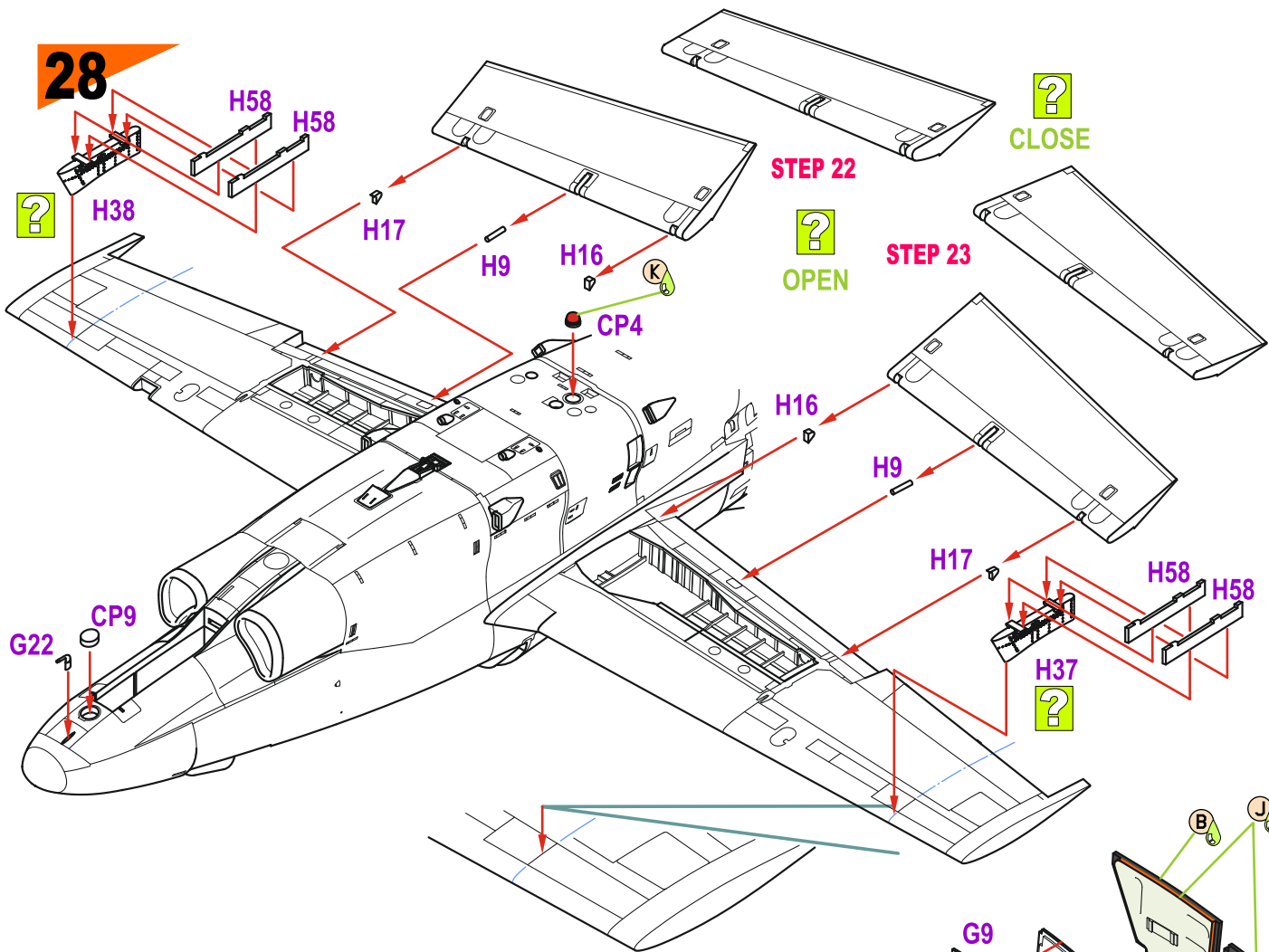

32

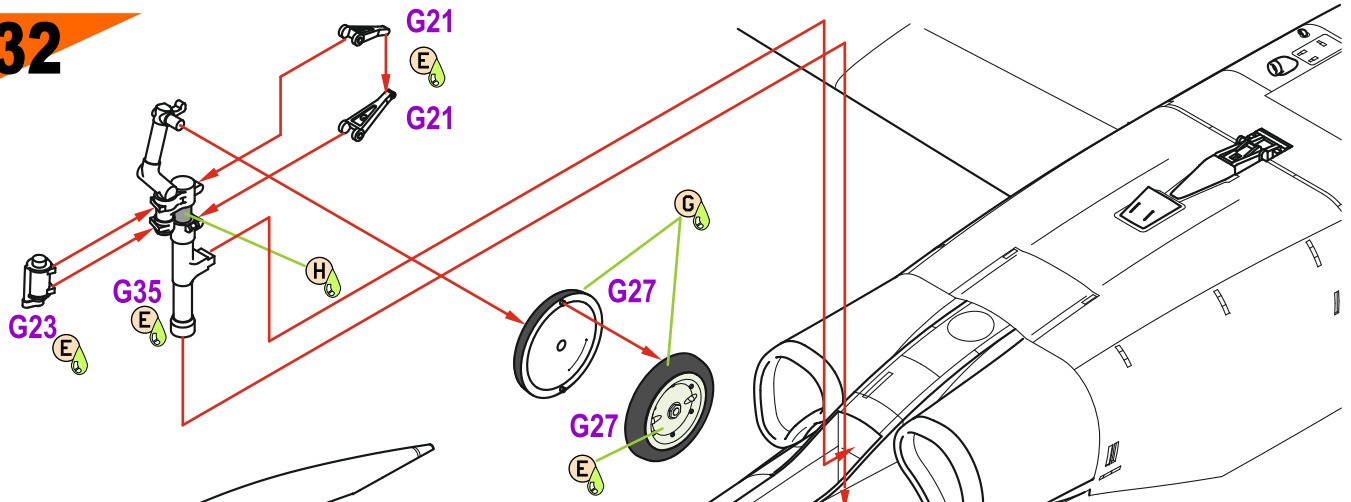

33

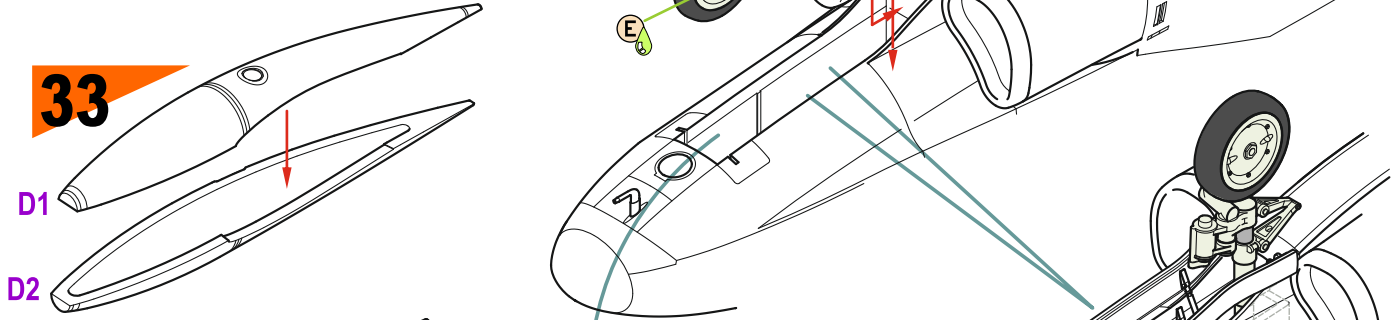

34

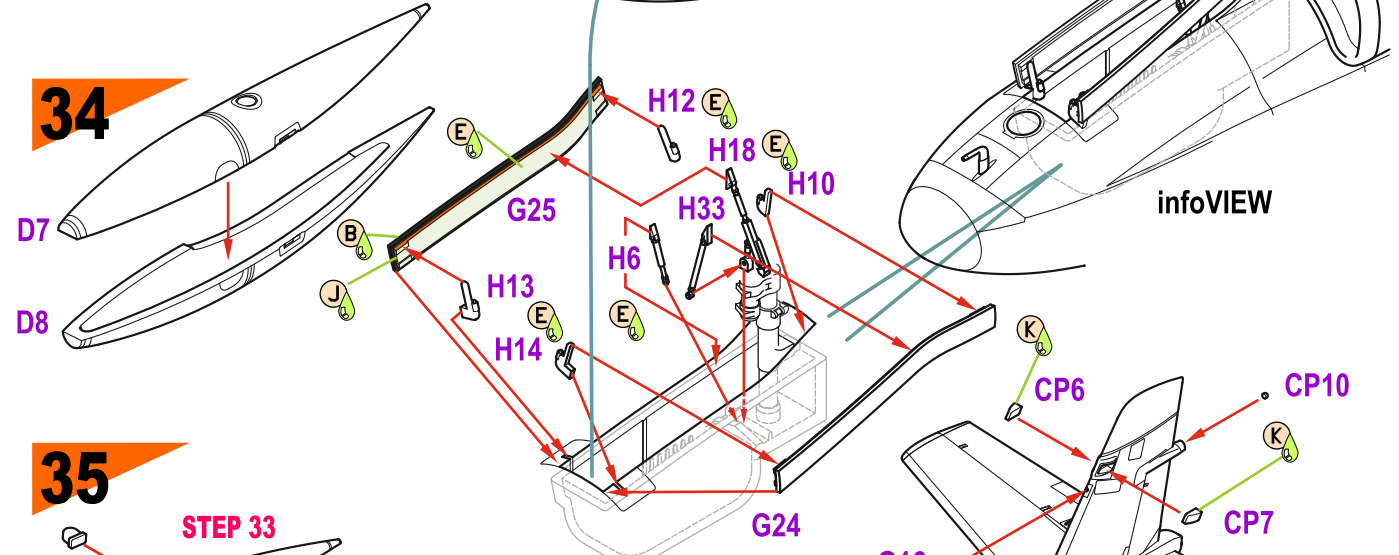

35

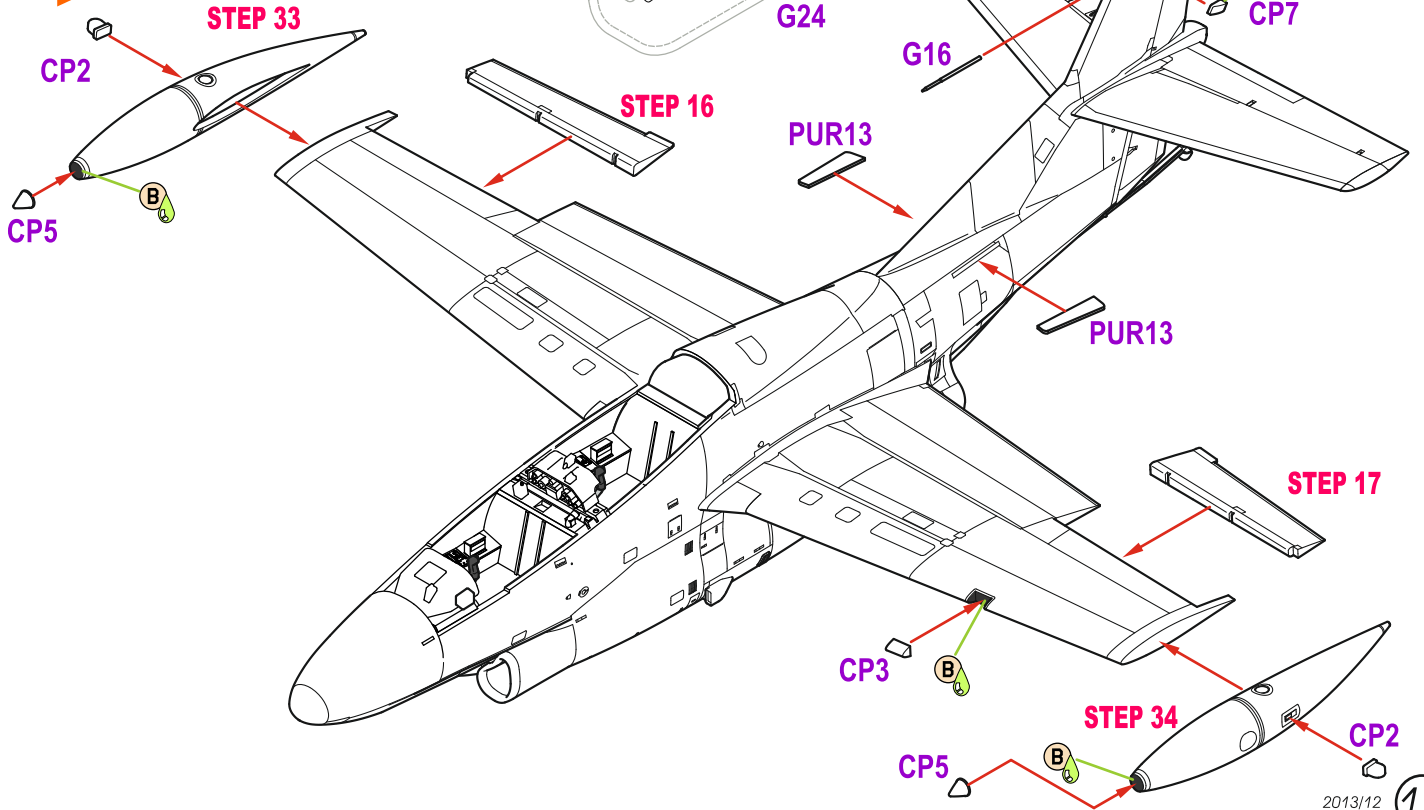

36

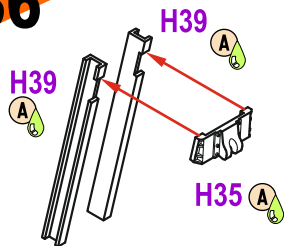

37

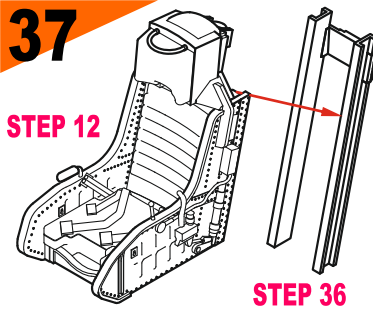

38

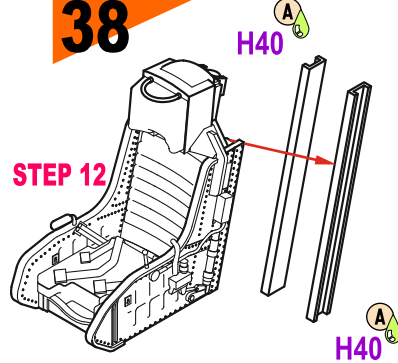

39

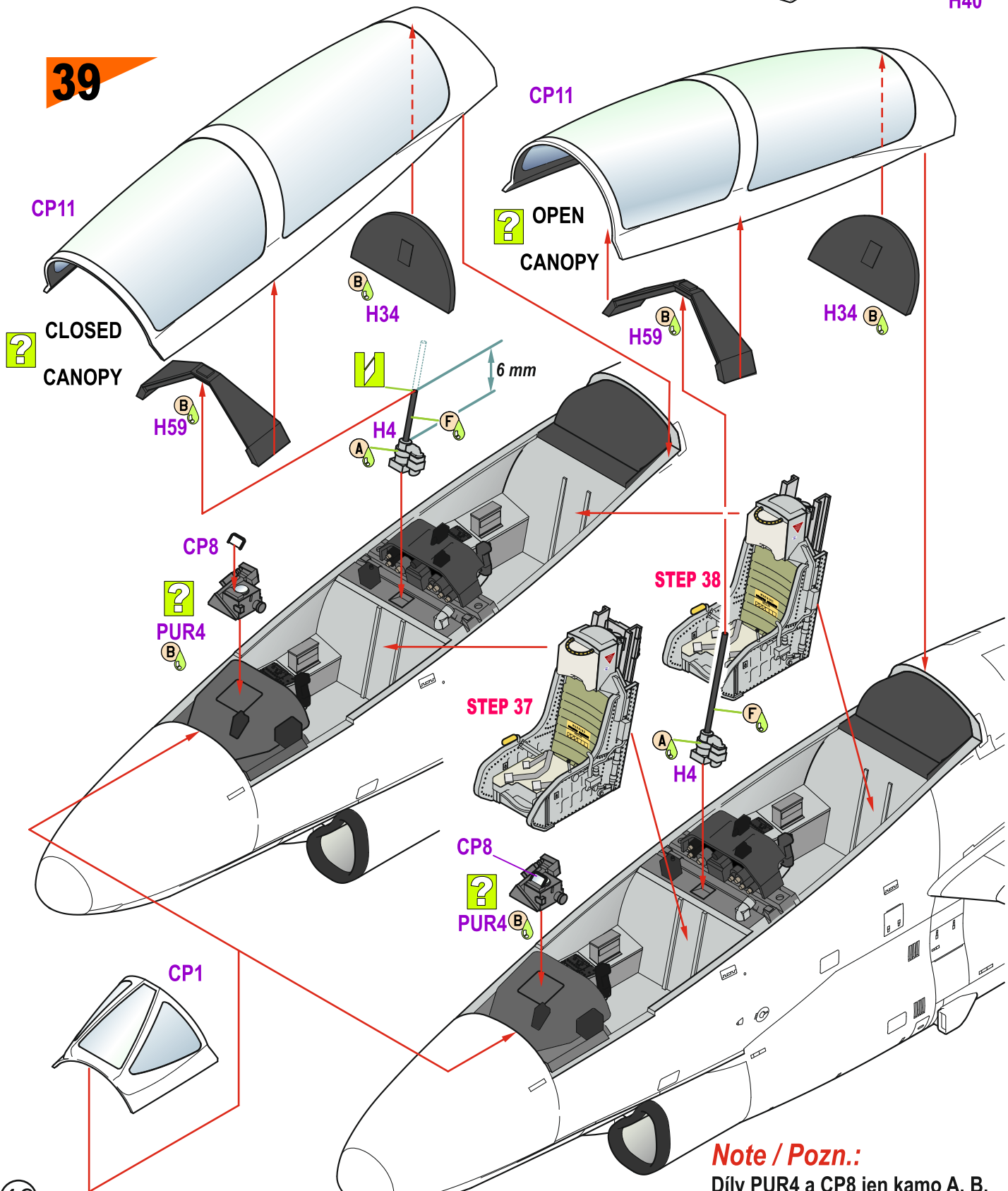

Note / Pozn.:
Dily PUR4 a CP8 jen kamo A, B.
Parts PUR4 and CP8 camo A, B only.

POPISKY PRO KAMUFLÁŽE A a B (stroje v kamuflážích C, D a E popisky nenesly)
 STENCILS FOR CAMO A & B (Camo C, D and E didn't have the stencils applied)

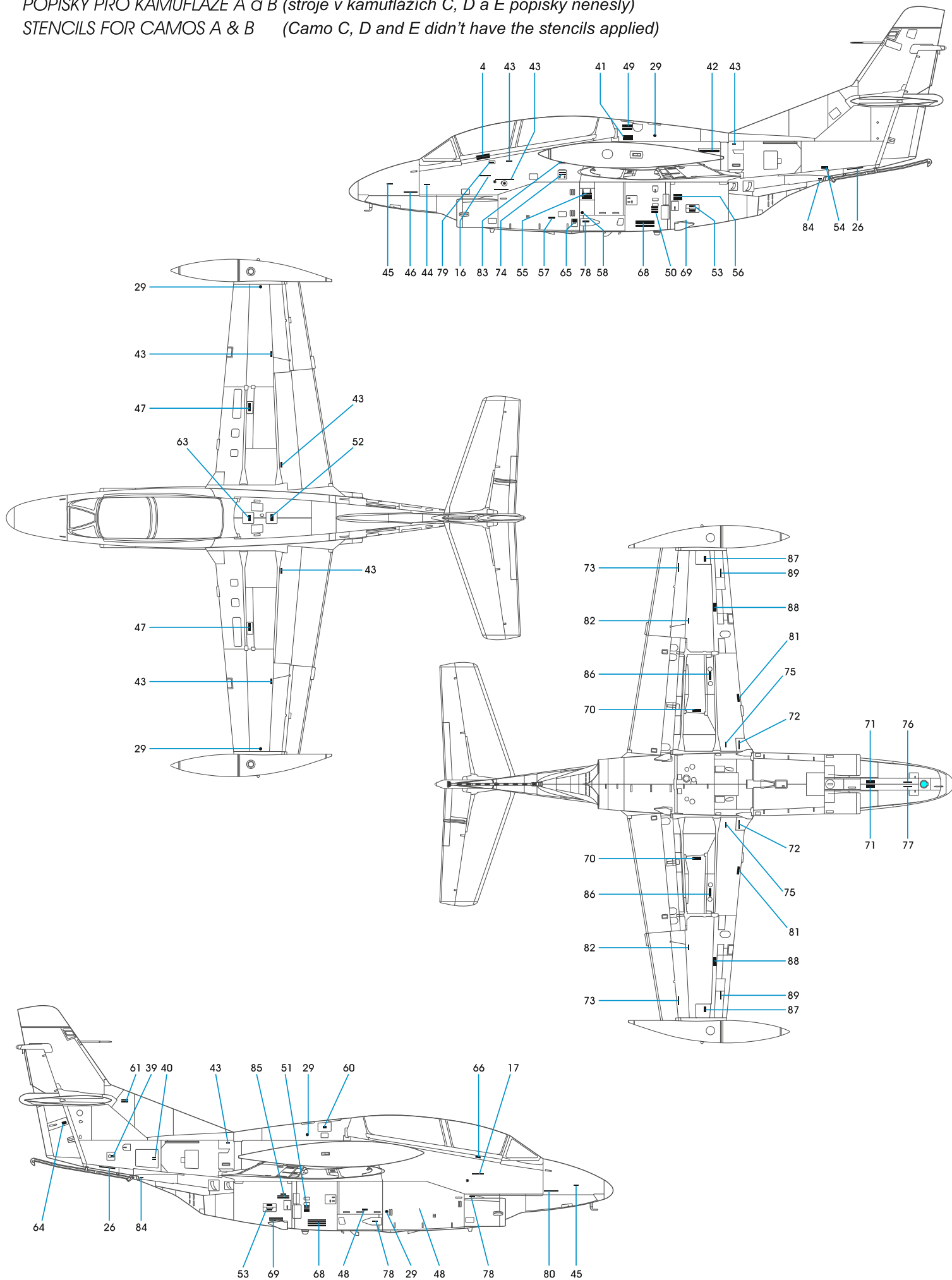

SH32059 T-2 Buckeye "Camouflaged Trainer"

T-2E, Bu. No. 160082, 362 MEA "Nestor", základna Kalamata, Řecké vojenské letectvo, 2007. Letoun byl vybaven minimálně jedním podkřídelním závěsníkem s adaptérem.

T-2E, Bu. No. 160082, 362 MEA "Nestor", Kalamata air base, Hellenic Air Force, 2007. This aircraft was equipped with at least one wing pylon with adaptor.

CAM. A

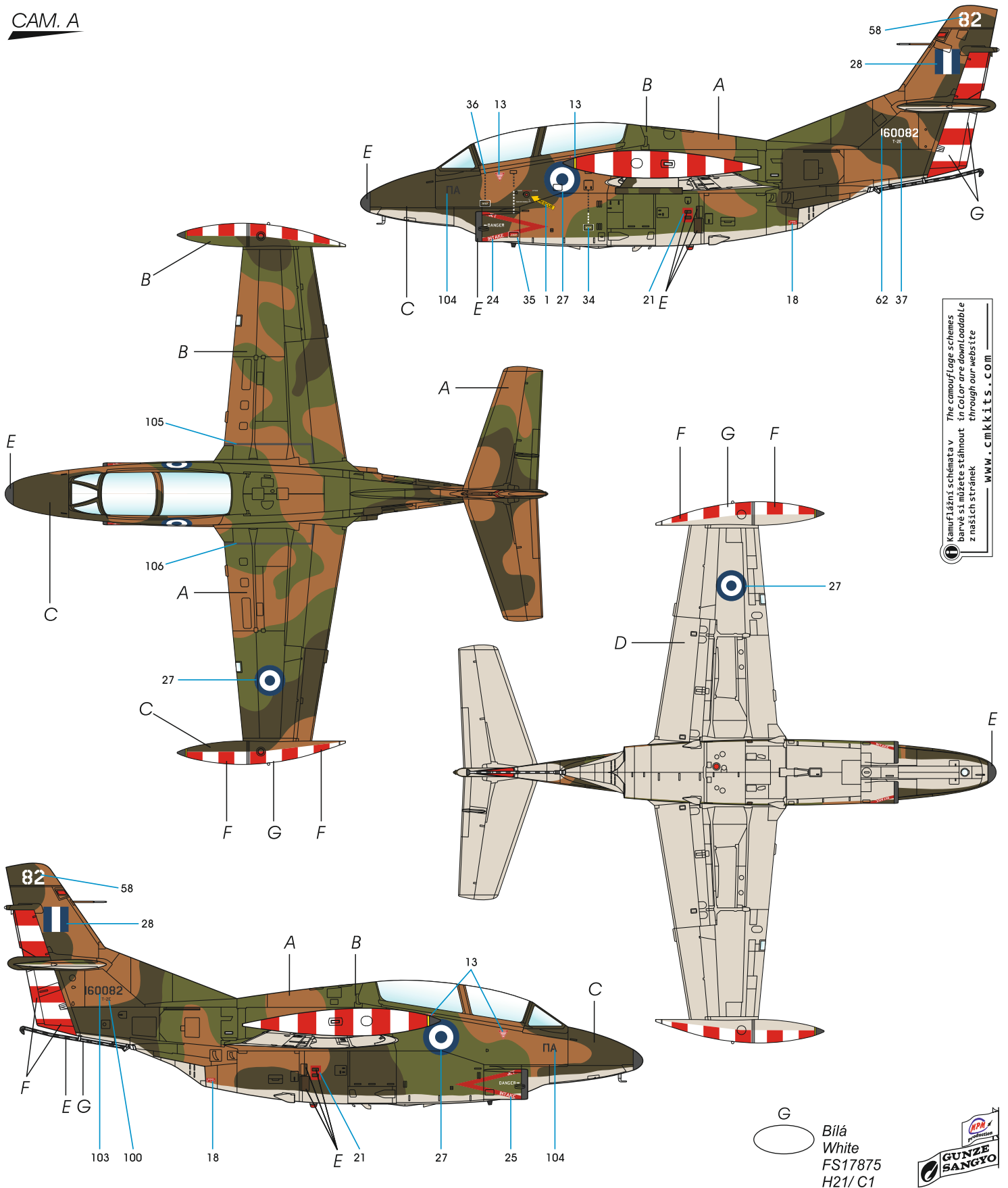

Kamuflažní schémata v této barvě si můžete stáhnout z našich stránek
 The camouflage schemes in color are downloadable through our website
 WWW.CMKKITS.COM

- A**

Tříslivá Tan
FS30219
H310/ C310
- B**

Středně zelená
Medium Green
FS34102
H303/ C303
- C**

Tmavě zelená
Dark Green
FS34079
H309 / C309
- D**

Světle šedá
Light Grey
FS33622
H311/ C311
- E**

Matná černá
FLat Black
FS37038
H12 / C33
- F**

Červená
Signal Red
FS12197
H340/ C340

G
 Bílá
 White
 FS17875
 H21/ C1



T-2E, Bu. No. 160083, 362 MEA "Nestor", základna Kalamata, Řecké vojenské letectvo, 2007. Letoun byl vybaven minimálně jedním podkřídelním závěsníkem s adaptérem.

T-2E, Bu. No. 160083, 362 MEA "Nestor", Kalamata air base, Hellenic Air Force., 2007. This aircraft was equipped with at least one wing pylon with adaptor.



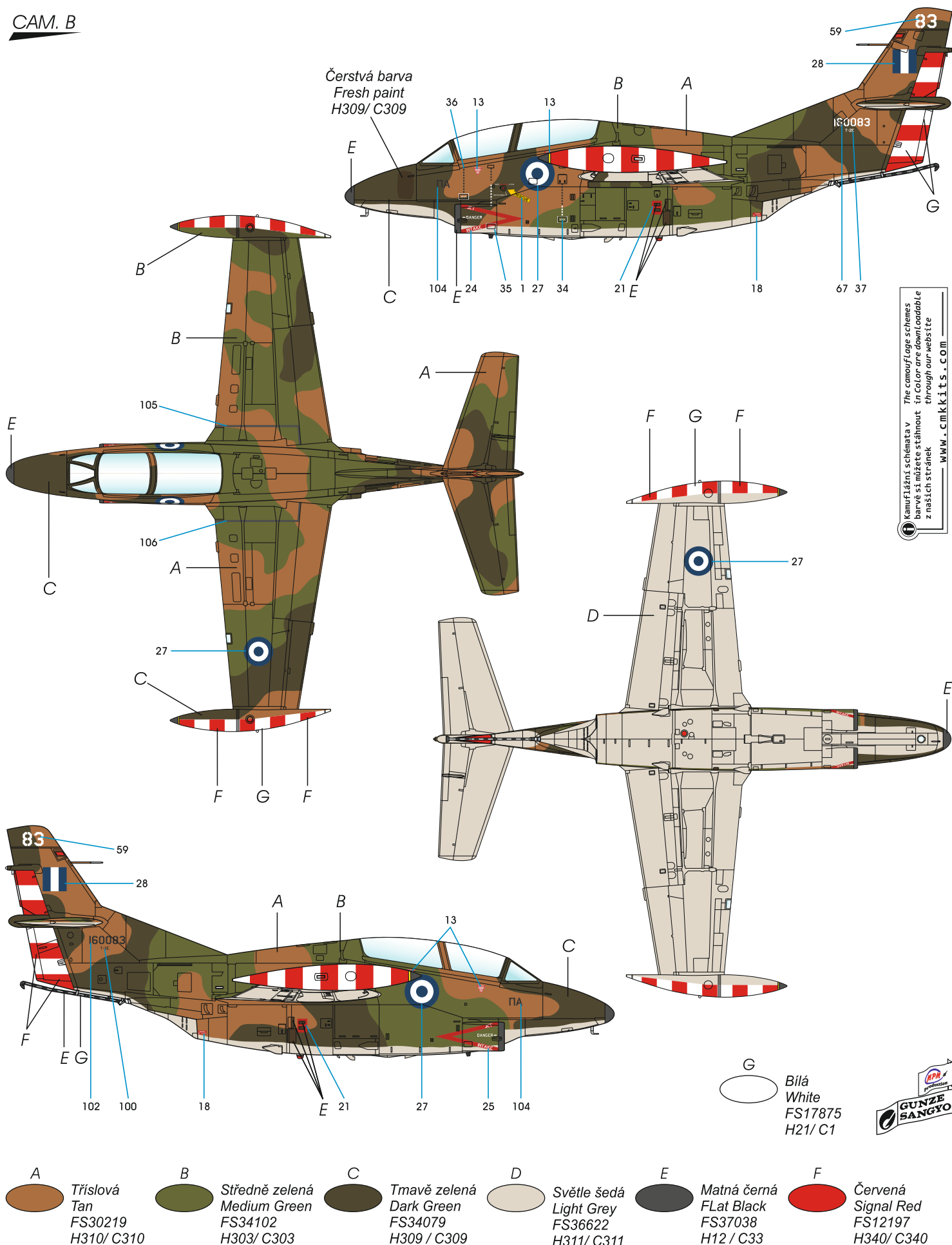

CAM. B



Kamuflažní schémata v
 barvách můžete stáhnout
 z našich stránek
 through our website
 WWW.CMKKITS.COM

G
 Bílá
 White
 FS17875
 H21 / C1

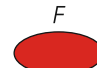

- | | | | | | |
|---|---|---|--|--|--|
| 
A
Tříslivá
Tan
FS30219
H310 / C310 | 
B
Středně zelená
Medium Green
FS34102
H303 / C303 | 
C
Tmavě zelená
Dark Green
FS34079
H309 / C309 | 
D
Světle šedá
Light Grey
FS36622
H311 / C311 | 
E
Matná černá
Flat Black
FS37038
H12 / C33 | 
F
Červená
Signal Red
FS12197
H340 / C340 |
|---|---|---|--|--|--|

CAM. C

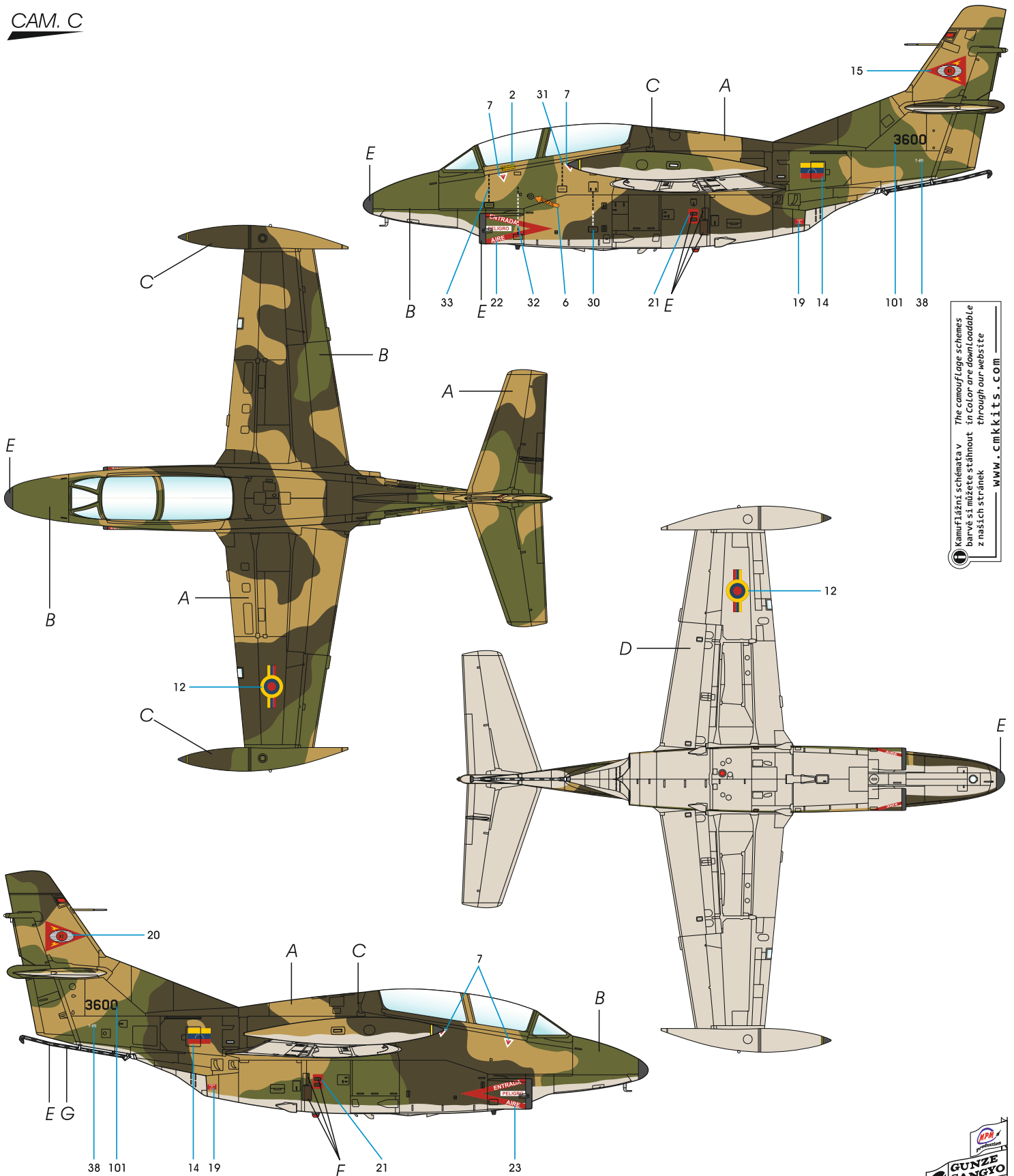

- | | | | | | |
|--|--|---|---|--|--|
| 
A
Písková
Sand
FS30257
H321/ C321 | 
B
Středně zelená
Medium Green
FS34102
H303/ C303 | 
C
Tmavě zelená
Dark Green
FS34079
H309 / C309 | 
D
Světle šedá
Light Grey
FS36622
H311/ C311 | 
E
Matná černá
FLat Black
FS37038
H12 / C33 | 
G
Bílá
White
FS17875
H21/ C1 |
|--|--|---|---|--|--|

CAM. D

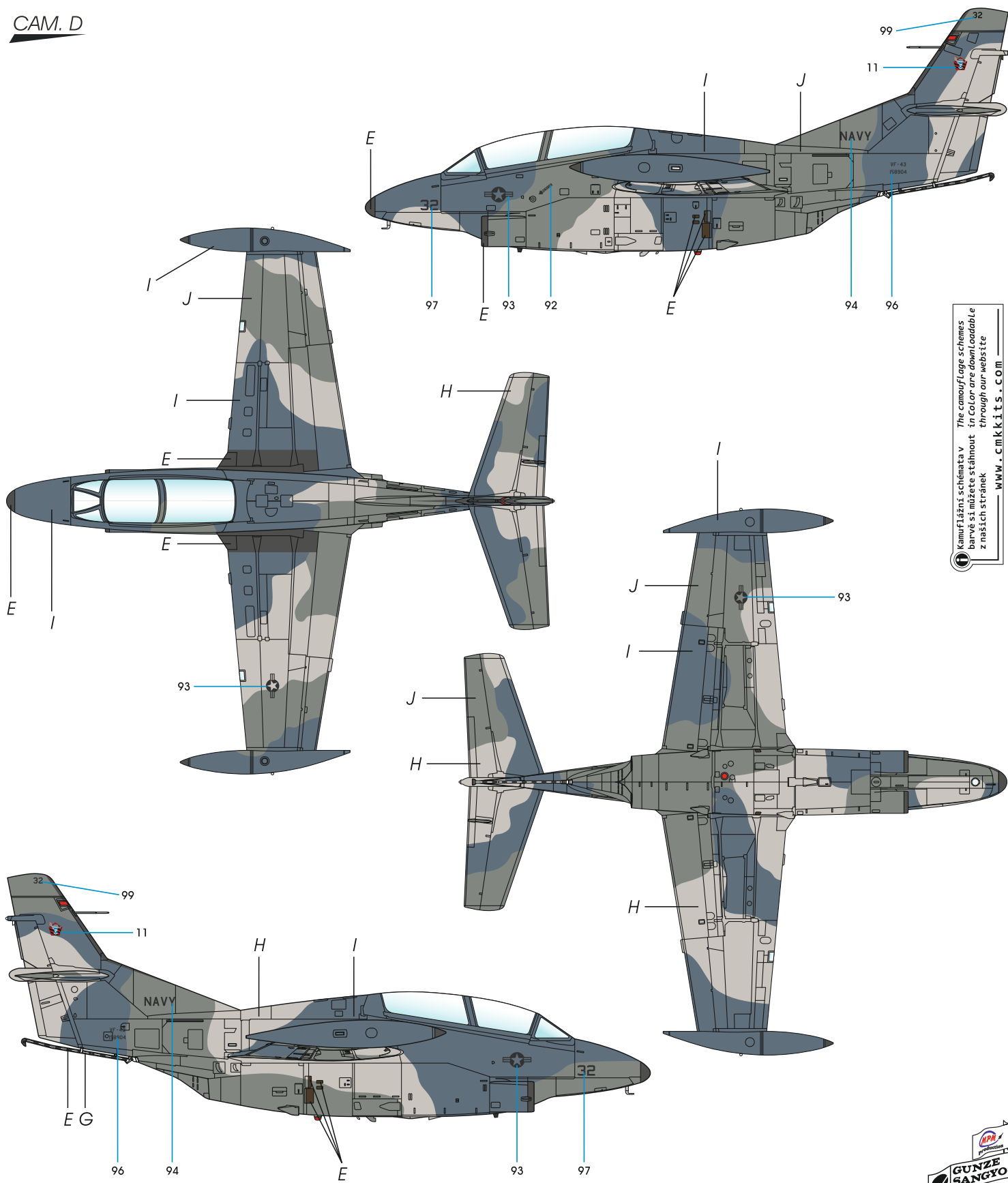

Kamuflažní schémata v této barvě jsou stáhnout z našich stránek
 The camouflage schemes in color are downloadable through our website
 WWW.CMKKITS.COM

- | | | | | |
|---|---|--|---|-------------------------------------|
| | | | | |
| Matná černá
FLat Black
FS37038
H12 / C33 | Rací šedá
Gull Grey
FS36440
H315/ C315 | Přečtová modrá
Intermediate Blue
FS35164
C366 | Tmavá rací šedá
Dark Gull Grey
FS36231
H317 / C317 | Bílá
White
FS17875
H21/ C1 |



CAM. E

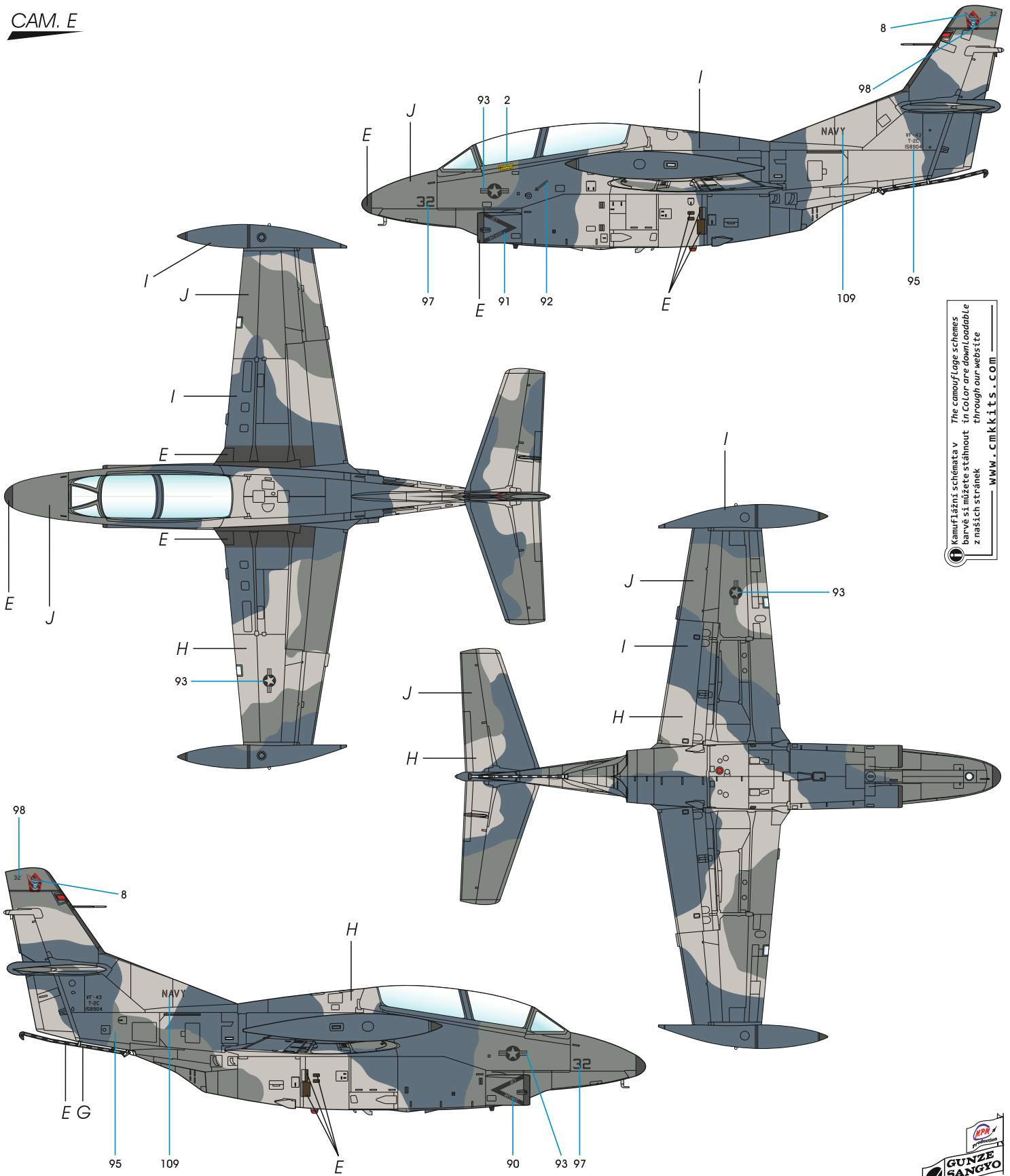

Kamuflážní schémata v in Color are downloadable
barvá si můžete stáhnout through our website
z našich stránek WWW.CMKKITS.COM

- | | | | | |
|---|--|--|--|---|
| <p>E</p> <p>Matná černá
FLat Black
FS37038
H12 / C33</p> | <p>H</p> <p>Racčí šedá
Gull Grey
FS36440
H315/ C315</p> | <p>I</p> <p>Přechodová modrá
Intermediate Blue
FS35164
C366</p> | <p>J</p> <p>Tmavá racčí šedá
Dark Gull Grey
FS36231
H317 / C317</p> | <p>G</p> <p>Bílá
White
FS17875
H21/ C1</p> |
|---|--|--|--|---|





BC1002



Heinkel He 162A Spatz

Best Choice kit includes plastic parts (Revell kit), highly detailed resin parts, huge decal sheet and coloured photo-etched parts. Each kit contains numbered certificate.

SH32022



X-15A-2

special
HOBBY

SH32026

special
HOBBY



P-39Q Airacobra "Makin Airacobras"

SH32028

special
HOBBY



**"Soviet Guard Regiment"
P-39N/Q Airacobra**

SH32029

special
HOBBY



X-15-1 "Two XLR-11 Engines"

SH32031

special
HOBBY



X-15A-2 "with Ground Dolly"

special
HOBBY

SH32044



Fiat G.50-II "Finnish Aces"

SH32048

special
HOBBY



F-80C Shooting Star "Over Korea"

Large Jet Intake F-16C Block 30 and Late



1/32 F-16 kit not included

5034 F-16C Block 30 and Late - Large Jet Intake 1/32
(Contains large jet intake for General Electric engine and F.O.D. cover) for Tamiya kit

F-16C Exhaust nozzle General Electric



1/32 F-16 kit not included

5035 F-16C - Exhaust nozzle GE engine 1/32
(Contains new exhaust nozzle for General Electric engine and F.O.D. cover) for Tamiya kit

5054 F-104G Starfighter

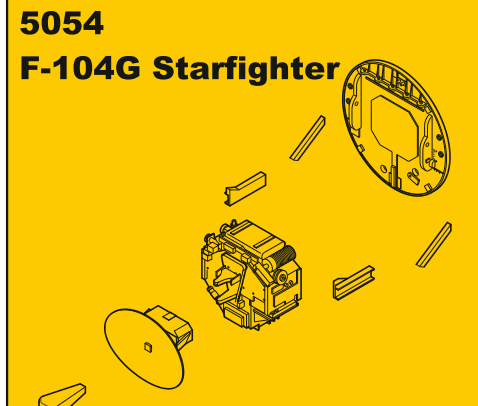

Radome set for Hasegawa kit

5055 F-104 Starfighter

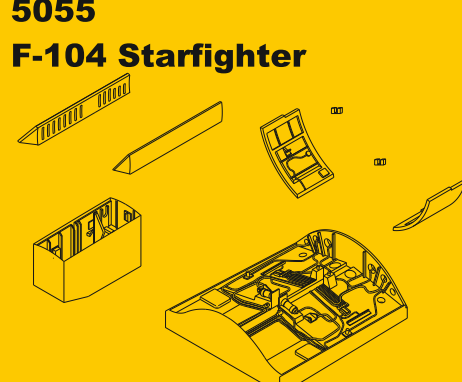

Undercarriage set for Hasegawa kit

5056 F-104G Starfighter

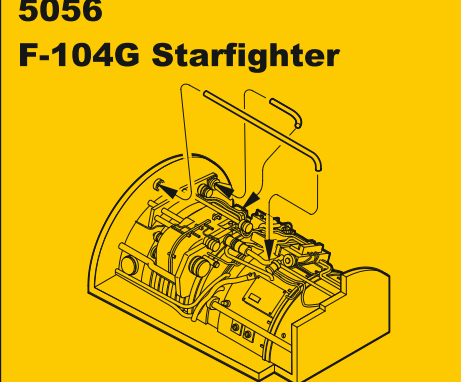

Engine set for Hasegawa kit

5057 F-104G Starfighter

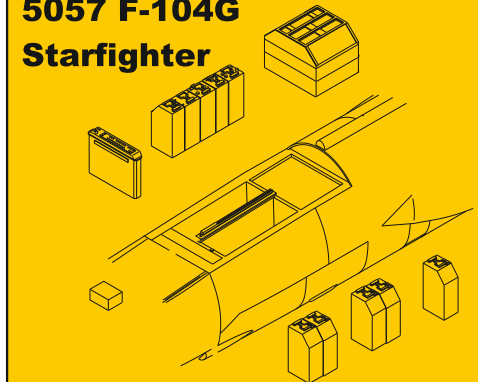

Electronics boxes (behind cockpit) for Hasegawa kit

5058 F-104 Starfighter

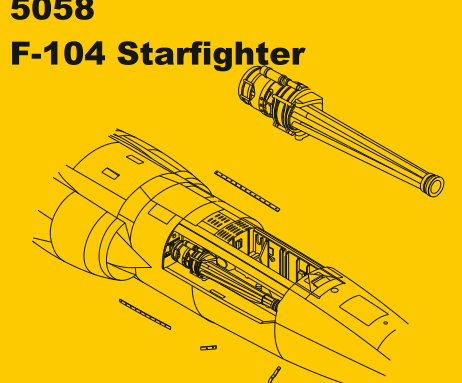

Gun bay for Hasegawa kit

5058 F-104 Starfighter



Interior set for Hasegawa kit

BAe Hawk T.1a Interior set
Color photo etched parts included

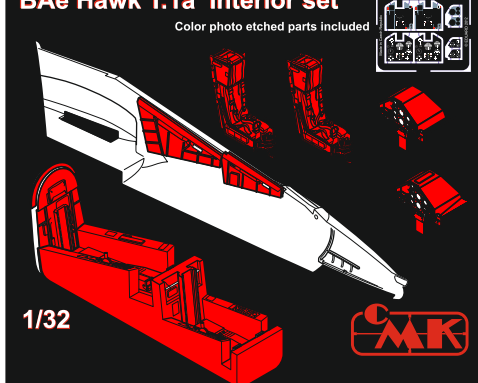

1/32

5075 BAe Hawk T.1a - Interior set 1/32
(contains new cockpit tub, ejection seats, instrument panels with canvas and photo-etched parts) for Revell kit

USE CMK TOOLS AND WEATHERING PIGMENTS FOR YOUR KITS.

H1010 HANDLE FOR OUR SAWS - PRICELESS TOOL FOR RESIN PARTS ADJUSTMENT



H1011 CMK SANDING STICK - FOUR DIFFERENT GRIT OF SANDING PAPERS ON ONE SANDING STICK.



Star Dust
weathering pigments

ALL OF THE ABOVE ITEMS CAN BE FOUND AND ORDERED VIA OUR OFFICIAL WEBSITE AND E-SHOP.....

WWW.CMKKITS.COM