



Fiat G.50bis/N

1/32

CZ

V továrně Fiat byl 26. února 1937 zalétán nový letoun konstruktéra G. Gabrielliho Fiat G.50. Byl odpovědí na požadavek Regia Aeronautica na novou standardní stíhačku. Vítězem soutěže se staly dva stroje. Jako nejlepší byl vybrána Macchi C.200, na druhém místě skončil Fiat G.50 Freccia (Šíp). I ten byl ale přijat do výzbroje Regia Aeronautica. Nové Fiaty byly otestovány v boji ve Španělské občanské válce, což se projevilo na úpravách podvozku, kabiny a dalších detailů. V roce 1938 si otestovali novou stíhačku i Finové, hledající vhodné stroje pro posílení svého letectva. Schylovalo se k válce a komunistický Sovětský svaz stupňoval nátlak a územní nároky. Úspěšné testy v Itálii vedly k objednaní série třiceti pěti kusů. Stroje byly dodávány postupně, díky tomu byly do Finska dodány Fiaty ze třech mírně odlišných výrobních sérií. Vzhledem k pozdějším finským úpravám se od sebe jednotlivé stroje dosti lišily. Na základě značky výrobce dostaly přezdívku Fiiu. První stroje přišly přes Německo, další kvůli tehdy platnému paktu Molotov-Ribbentrop šli lodí do Švédska a dále vzduchem do Finska. Díky tomu Fiaty stihly zasáhnout do Zimní války (30. listopadu 1939 až 13. března 1940). Sovětský Svaz zahájil bez vyhlášení války útok kvůli území Karélie, na který si dělal nárok. Už 13. ledna 1940 kpt. Ehrnrooth sestřelil na Fiatu FA-1 bombardér SB-2. Přitom měl Fiat testovat v rámci zkušební jednotky. Další sestřely přidali piloti jednotky LLv 26. Zde Fiaty nahradily Bristol Bulldog. Za období Zimní války sestřelili Finové třináct útočníků a pozbyli jedinou stíhačku. I přes deklarovanou neutralitu bylo Finsko napadeno 25. června Sovětskými bombardéry. Finsko tak vstoupilo do války za získání ztracených území, tzv. Pokračovací války po boku Německa (25. června 1941 až 5. září 1944). I v této válce si Fiaty vedly dobře. A to i proti silicím nepříteli, který disponoval stále výkonnějšími stíhačkami. Postupně však zastarávaly a v roce 1944 byly silně opotřebované Fiaty předány HLeLv 30 a k cvičným jednotkám. Poslední dolétaly v roce 1946 v letecké škole. Během Pokračovací války sestřelili Finové dalších 82 nepřátel. Sestřeleny byly jen čtyři Fiaty, tři ve vzdušných bojích a jeden protivzdušnou obranou. Mnohem větší počet Fiatů byl zničen při haváriích. Rozpětí: 12,38 m, Délka: 8,29 m, Výška: 2,96 m, Maximální rychlost: 423 km/h, Dolet: 1 000 km, Výzbroj: 2 synchronizované kulometry Breda-Safat ráže 12,7 mm

EN

On 26 February 1937 was at Fiat factory airfield test flown new aircraft designed by G Gabrielli. This aircraft was a response to the Regia Aeronautica's request for new standard fighter. Nevertheless there were two winners. The best was chosen Aermacchi C.200 and on the second place was Fiat G.50 Freccia (Arrow). Both aircraft were accepted by Regia Aeronautica. New Fiats were combat tested in Spanish Civil War and subsequently influenced the modifications of undercarriage, canopy and other details. In 1938 Finnish pilots, looking for suitable aircraft to strengthen their air forces, test flown this new fighter. The war was about to break out and the Communist Soviet Union graduated its restraint and territorial demands. Following successful trials in Italy led Finland to order 35 aircraft series. The aircraft were delivered subsequently and this led to the fact that delivered Fiats were of three slightly different series. Moreover the subsequent Finnish modification distinguished each particular aircraft. The original producer's designation the aircraft were nicknamed Fiiu. The first machines had been delivered via Germany the rest of them due to the Molotov-Ribbentrop Pact were delivered by ships to Sweden and then flown to Finland. The Fiats arrived in time even to participate in Winter War (30 November 1939 13 March 1940). Soviet Union began undeclared war because of Karelia that was claimed before. On 13 January 1940 Cpt Ehrnrooth flying in Fiat FA-1 shot down SB-2 bomber. He originally had to test fly the aircraft within the trial unit. More victories were added by pilots from LLv 26 unit where Fiats replaced Bristol Bulldogs. During Winter War Finnish pilots shot down 13 attackers and lost just one aircraft. Even though Finland declared its neutrality it was again on 25 June attacked by Soviet bombers. Finland together with Germany entered the war for lost territories, later so called Continuation War (25 June 1941 5 September 1944). Finnish pilots flying Fiats scored well again even against strengthened enemy equipped with more powerful fighter aircraft. Finnish Fiats begun to grow obsolete and in 1944 were heavily worn off Fiats passed over to HLeLv 30 and training units. The last Fiat ended its career in 1946 in aviation school. During Continuation War Finnish pilots shot down 82 enemy aircraft. Own losses included 4 Fiats; three of them being lost in air combats one due to AA fire. Many Fiats were destroyed during accidents.

Wingspan: 12.38 m, Length: 8.29 m, Height: 2.96 m, Max. Speed: 423 kmh, Range: 1,000 km, Armament: 2 synchronized 12,7 mm Breda-Safat machine guns.

Plastic parts

A

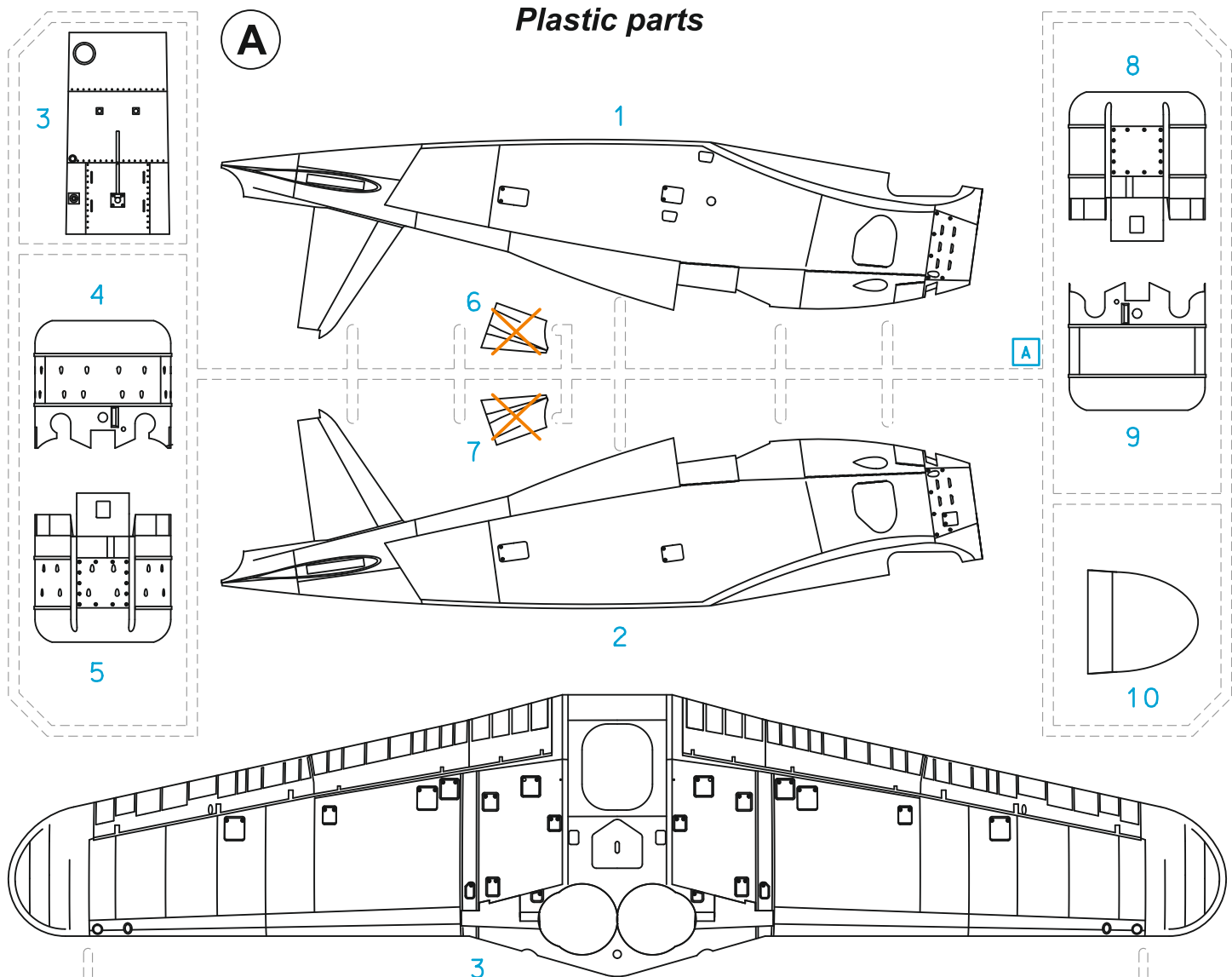

B

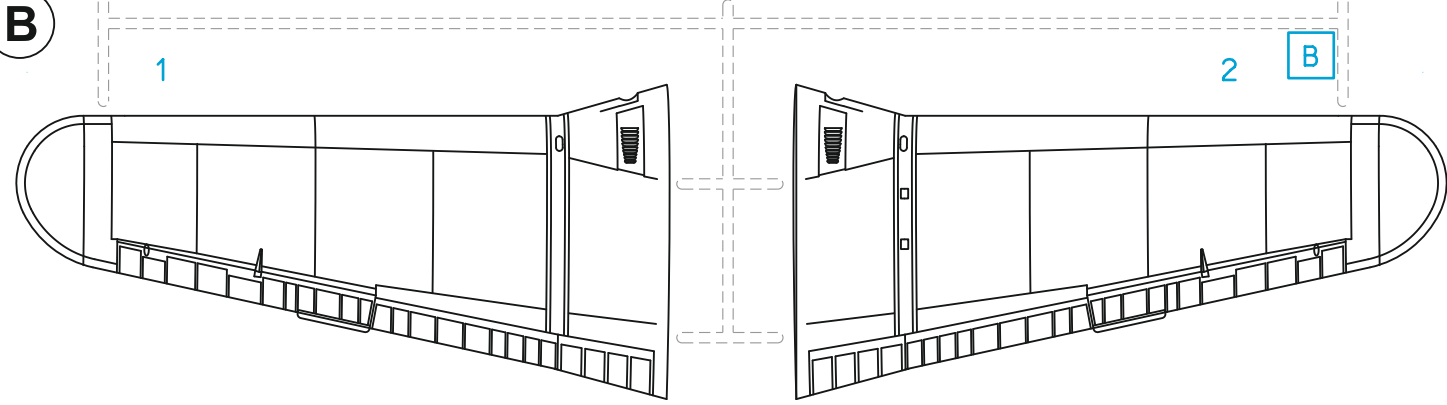

PUR Parts(PUR)

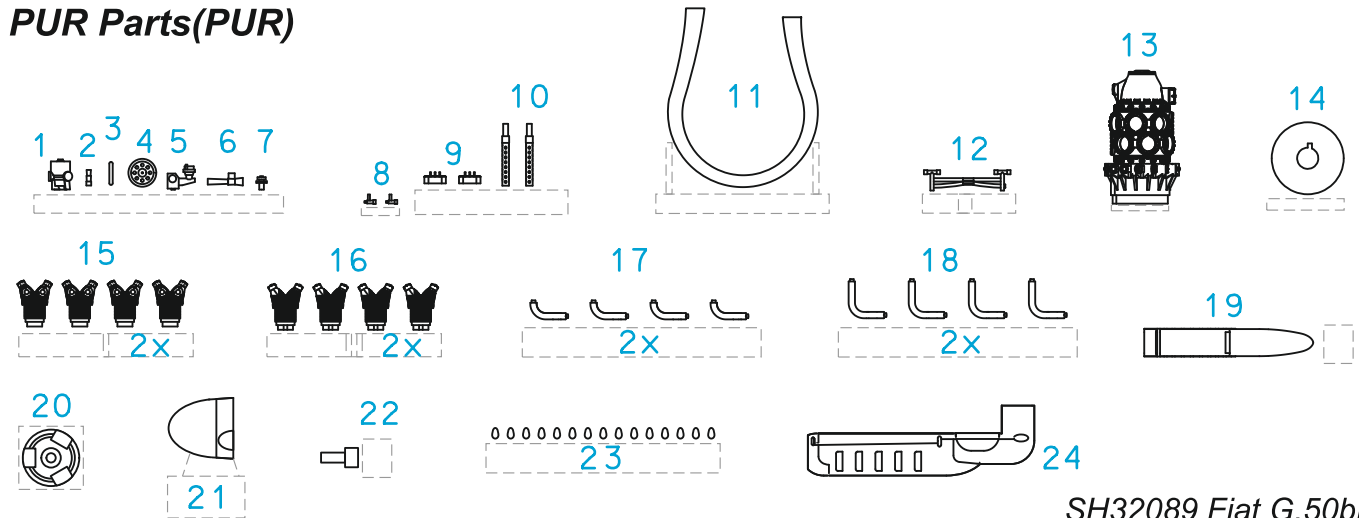

Printed parts (PRP)

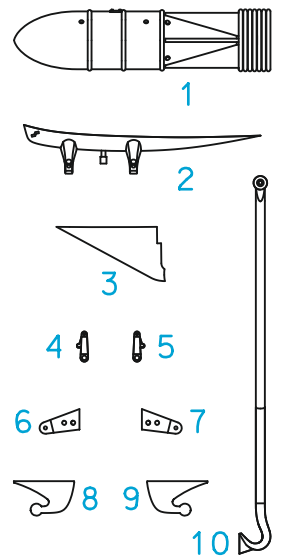

Mask parts (MP)

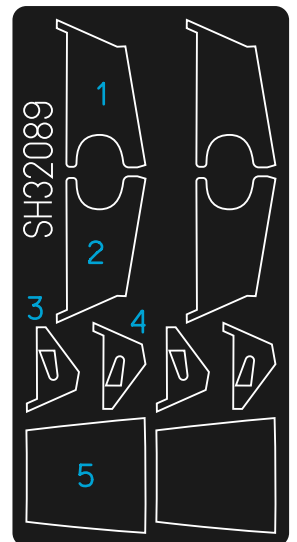

C

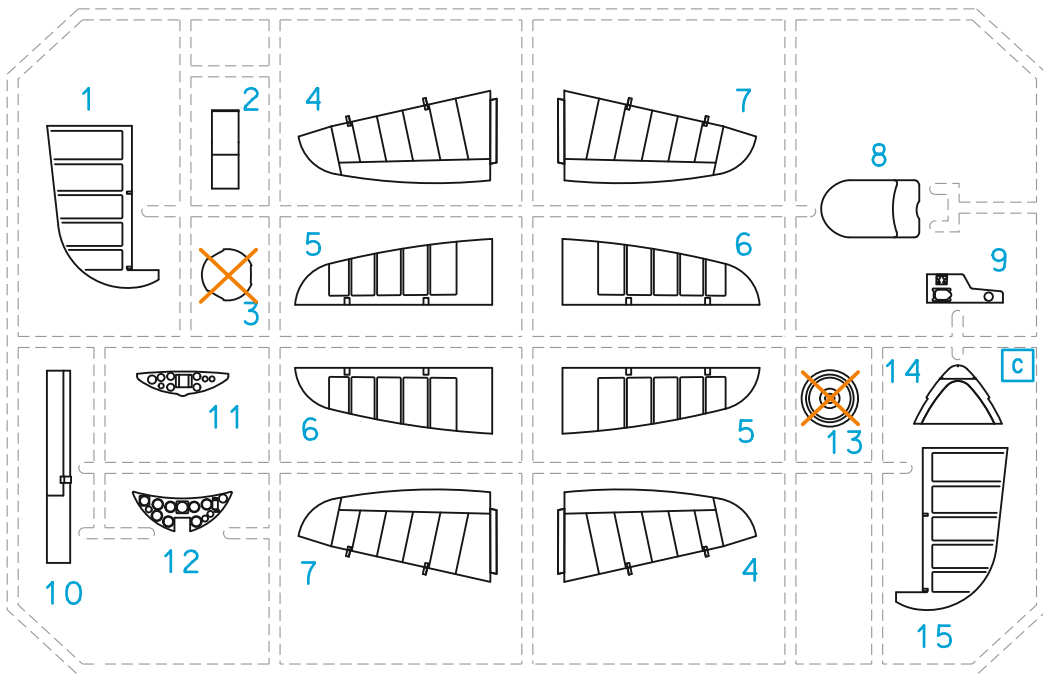

D

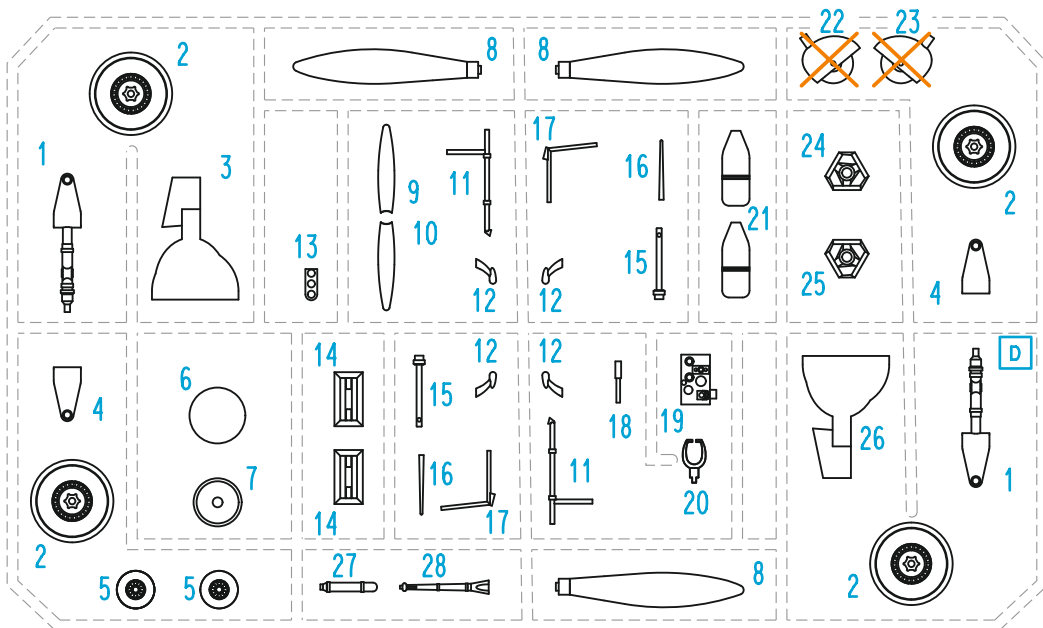

CLEAR Parts (CP)

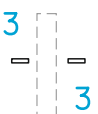
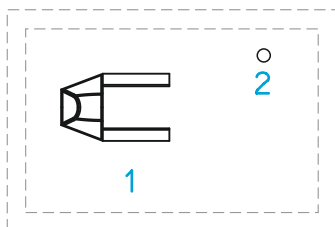

FILM (F)

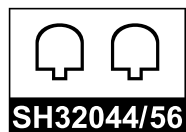
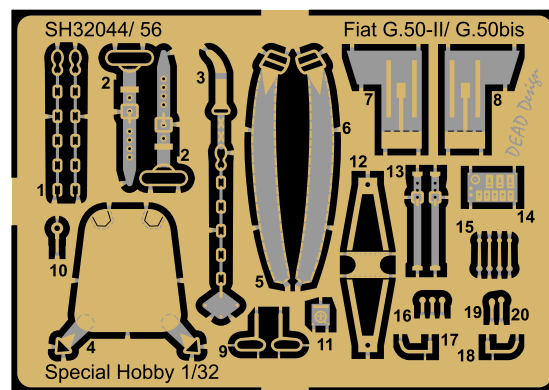

PHOTO-ETCHED Parts (L1-L20)



Barvy GUNZE/ GUNZE Colour No.

A	Černá/ BLACK	H12/C33
B	Základová barva/ PRIMER	H74/C26
C	Pneu. šedá/ TIRE BLACK	H77/C137
D	Tmavý kov/ DARK IRON	MC214
E	Hliník/ ALUMINIUM	MC218
F	Ocel. šedá/ STEEL GREY	H75/C25
G	Piátno/ TAN	H27/C44
H	Opálený kov/ BURNT IRON	H76/C61
I	Kůže/ LEATHER	H17/C29
J	Modrá/ BLUE	H5/C5
K	Šedá/ GREY	H311/C311
L	Červená/ RED	H4/C4

✗ Tento díl nepoužít
Do not use this part

SYMBOLS

? MOŽNOST VOLBY
OPTIONAL
NACH BELIEBEN
OPTION

POUŽIT KYANOAKRYLÁTOVÉ LEPIDLO
INSTANT CYANOACRYLATE GLUE
ZYANOAKRYLÁTKLEBER
COLLE CYANOACRYLAT

OHNOUT
BEND
BIEGEN
COURBER

ZHOTOVIT NOVÉ
SCRATCH BUILD
FERTIGSTELLEN
ACHEVER



ŘEZAT/VRTAT
CUT OFF/DRILL
ENTFERNEN
DETACHER

GSI
colour code

NATRÍT
COLOUR
FARBEN
PEINDRE

1

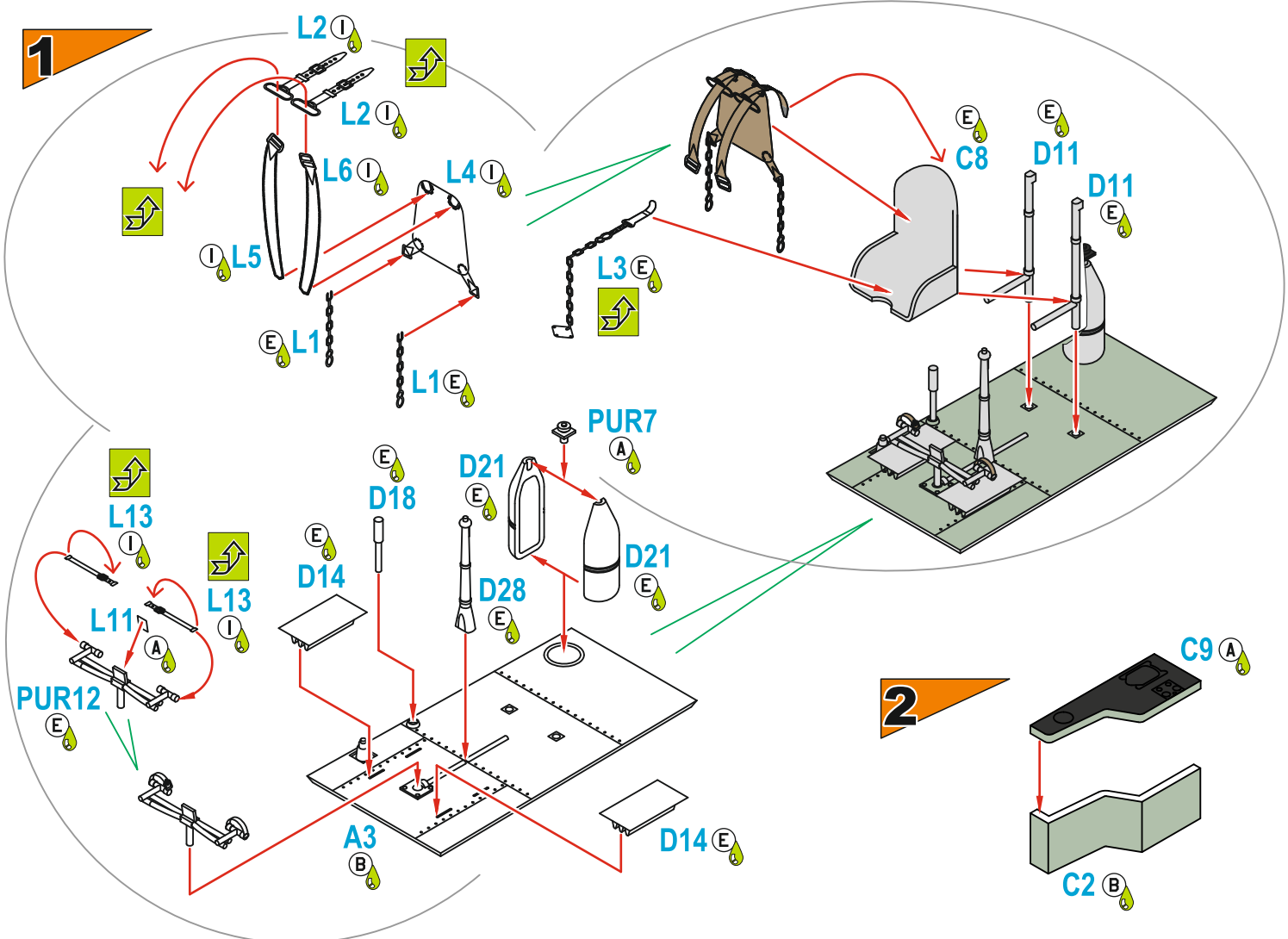

2

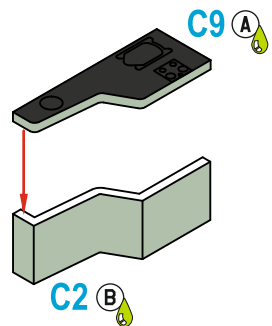

3

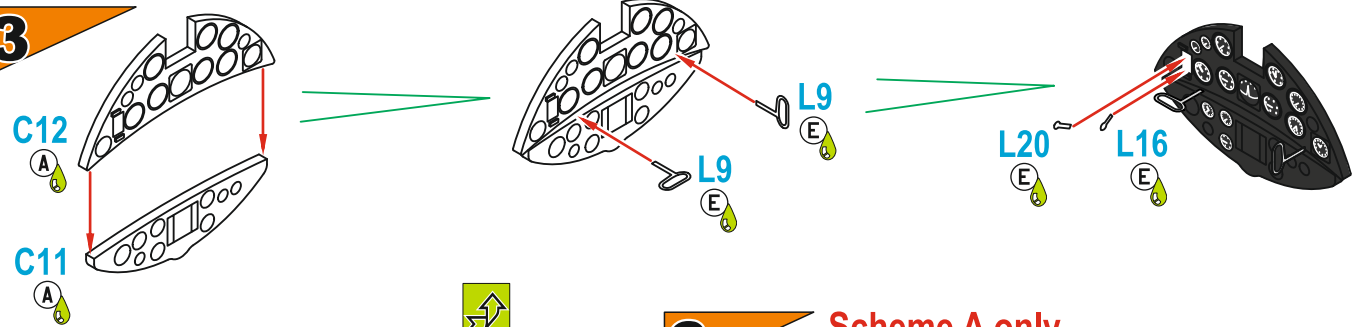

4

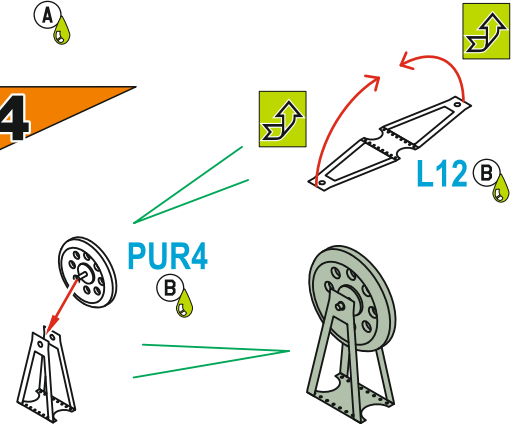

5

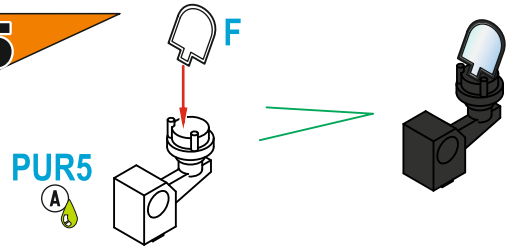

6

Scheme A only

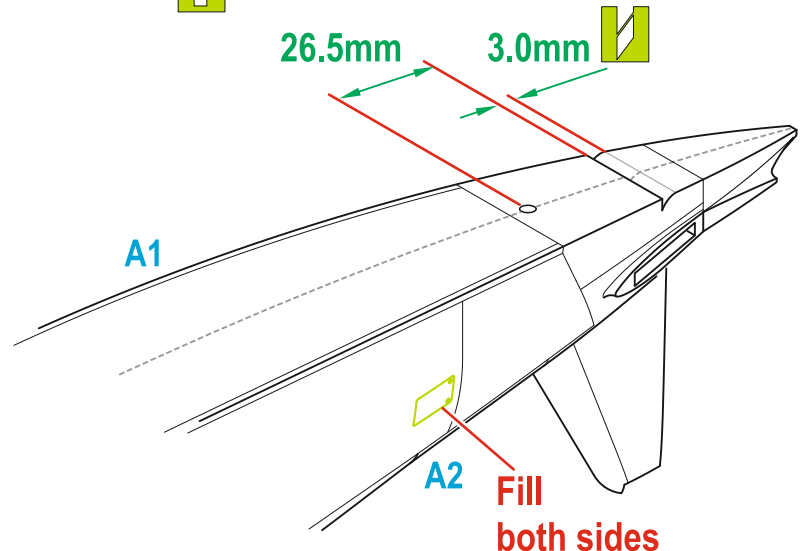

7

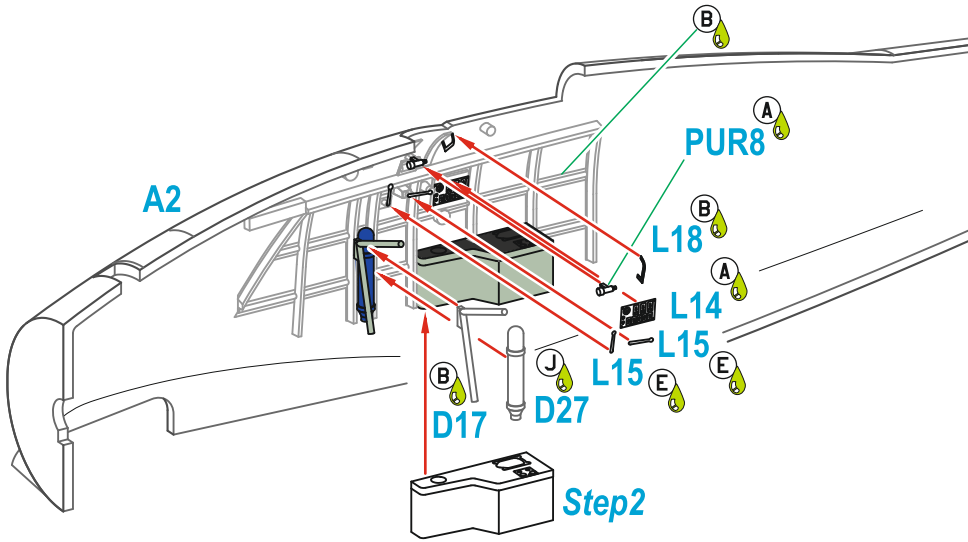
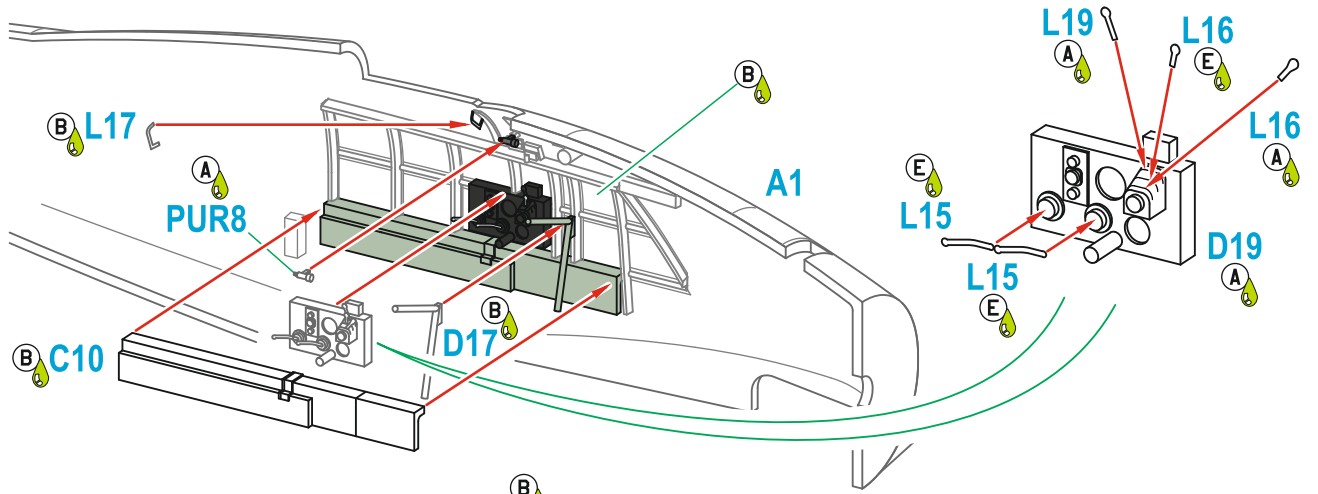

9 **Scheme A only**
?

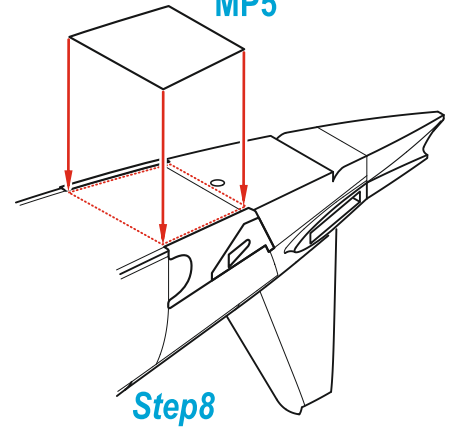

8

Scheme A only
?

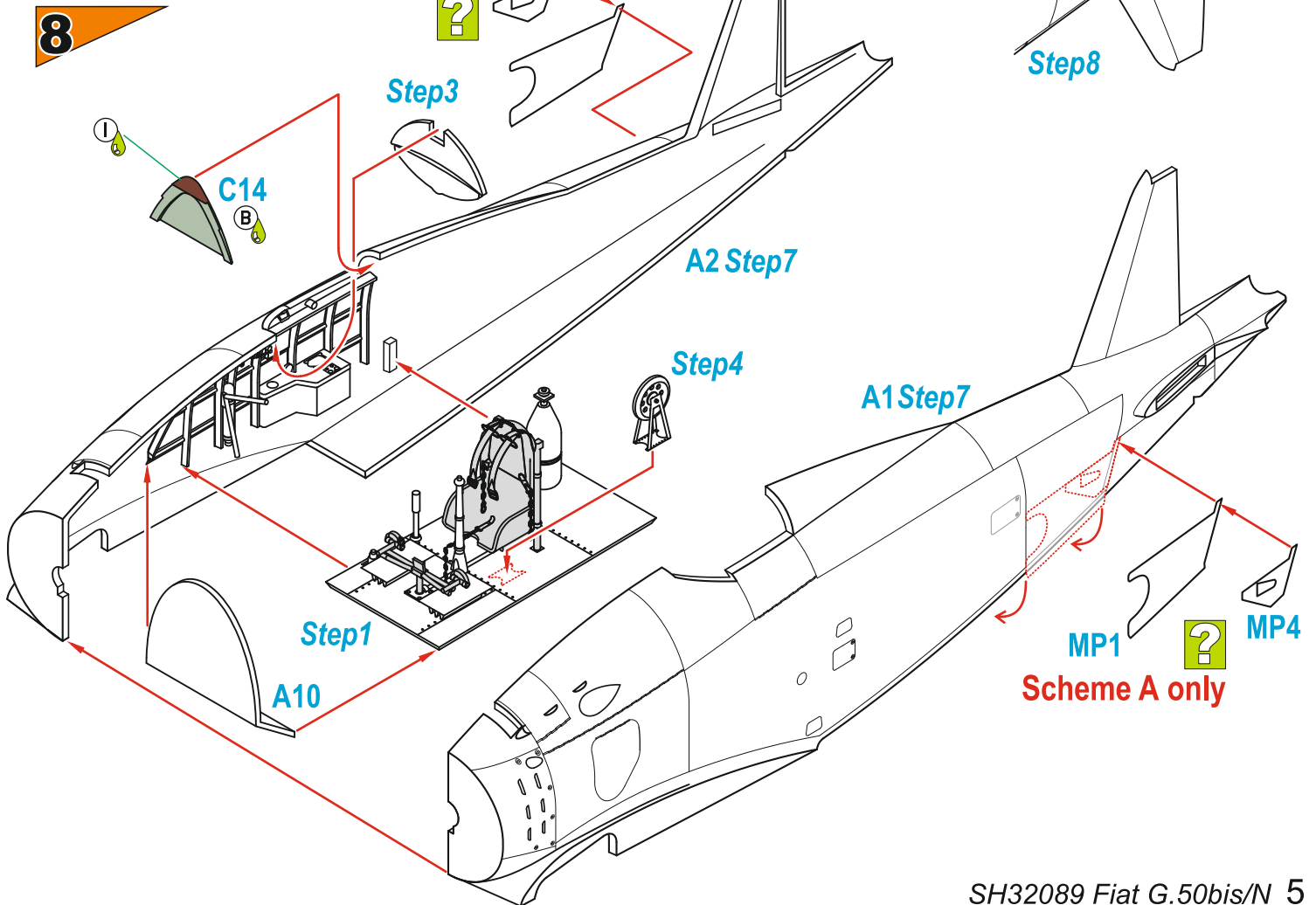
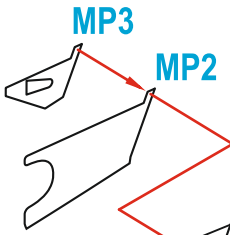

10

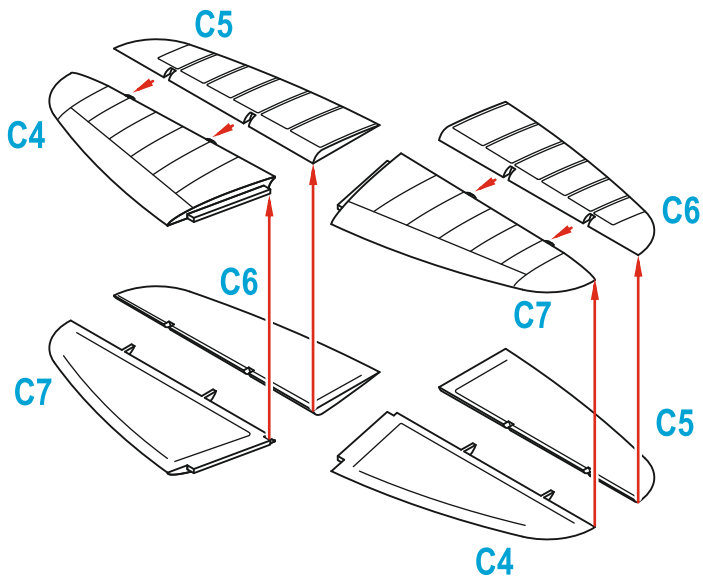

11

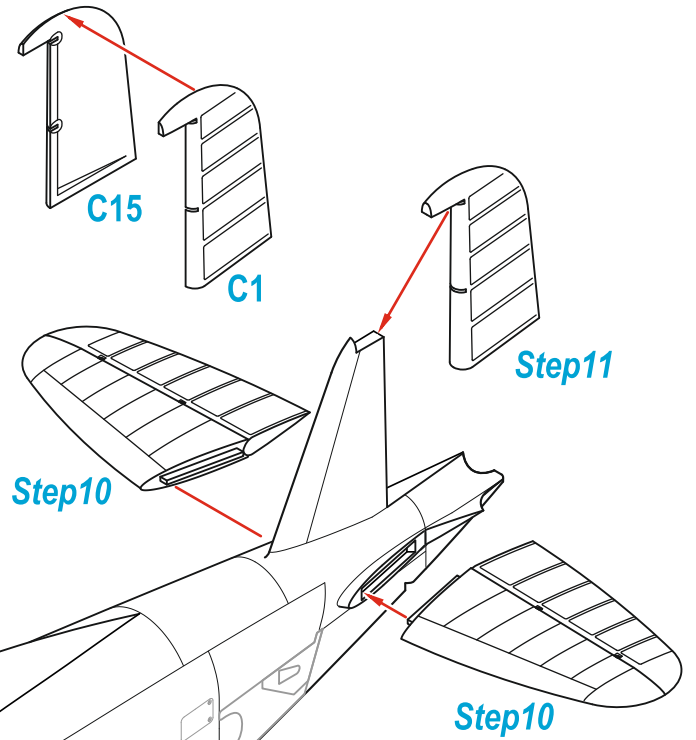

12

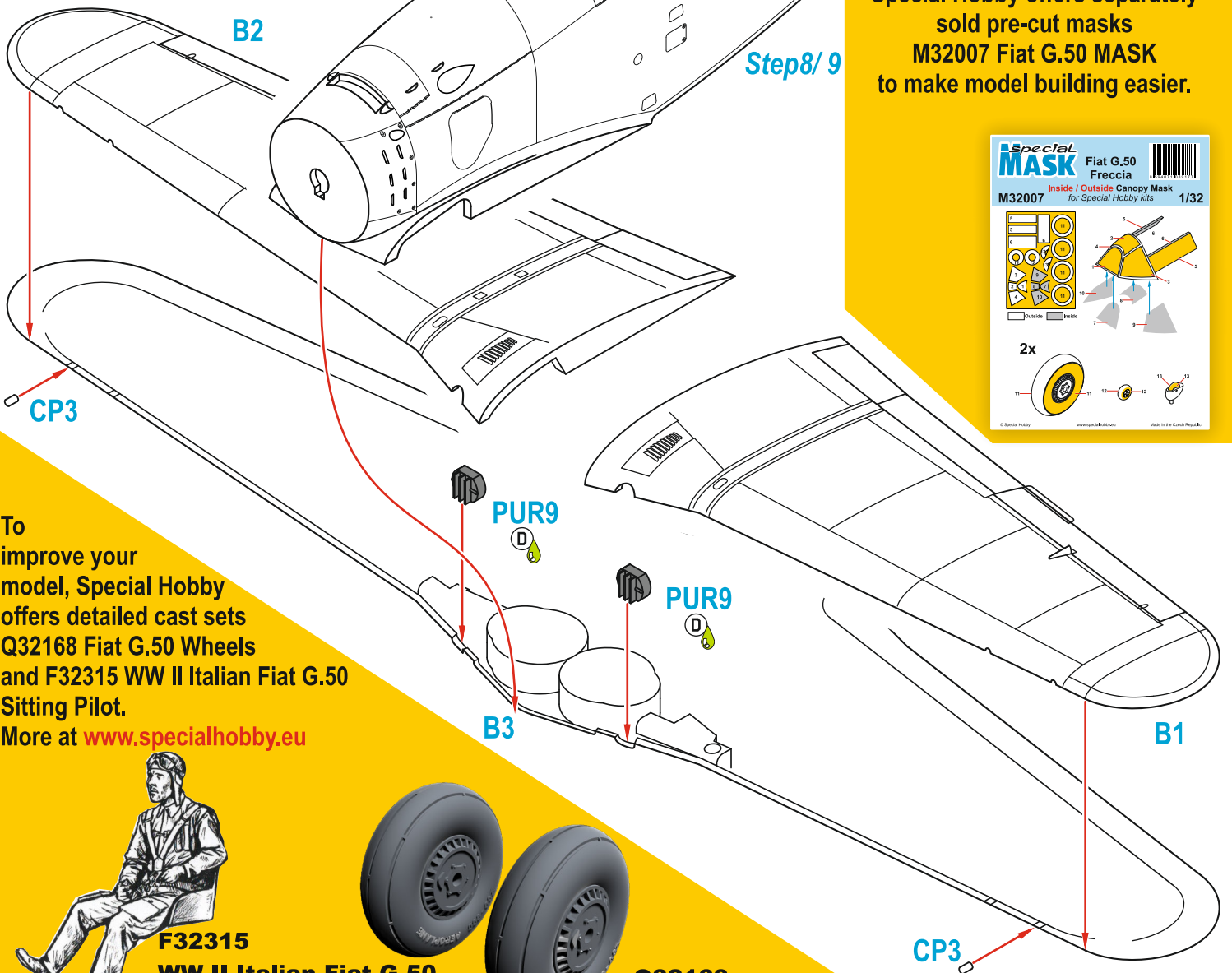

Special Hobby offers separately sold pre-cut masks M32007 Fiat G.50 MASK to make model building easier.

To improve your model, Special Hobby offers detailed cast sets Q32168 Fiat G.50 Wheels and F32315 WW II Italian Fiat G.50 Sitting Pilot. More at www.specialhobby.eu



F32315
WW II Italian Fiat G.50
Sitting Pilot



Q32168
Fiat G.50 Wheels

SH32089 Fiat G.50bis/N 6

13

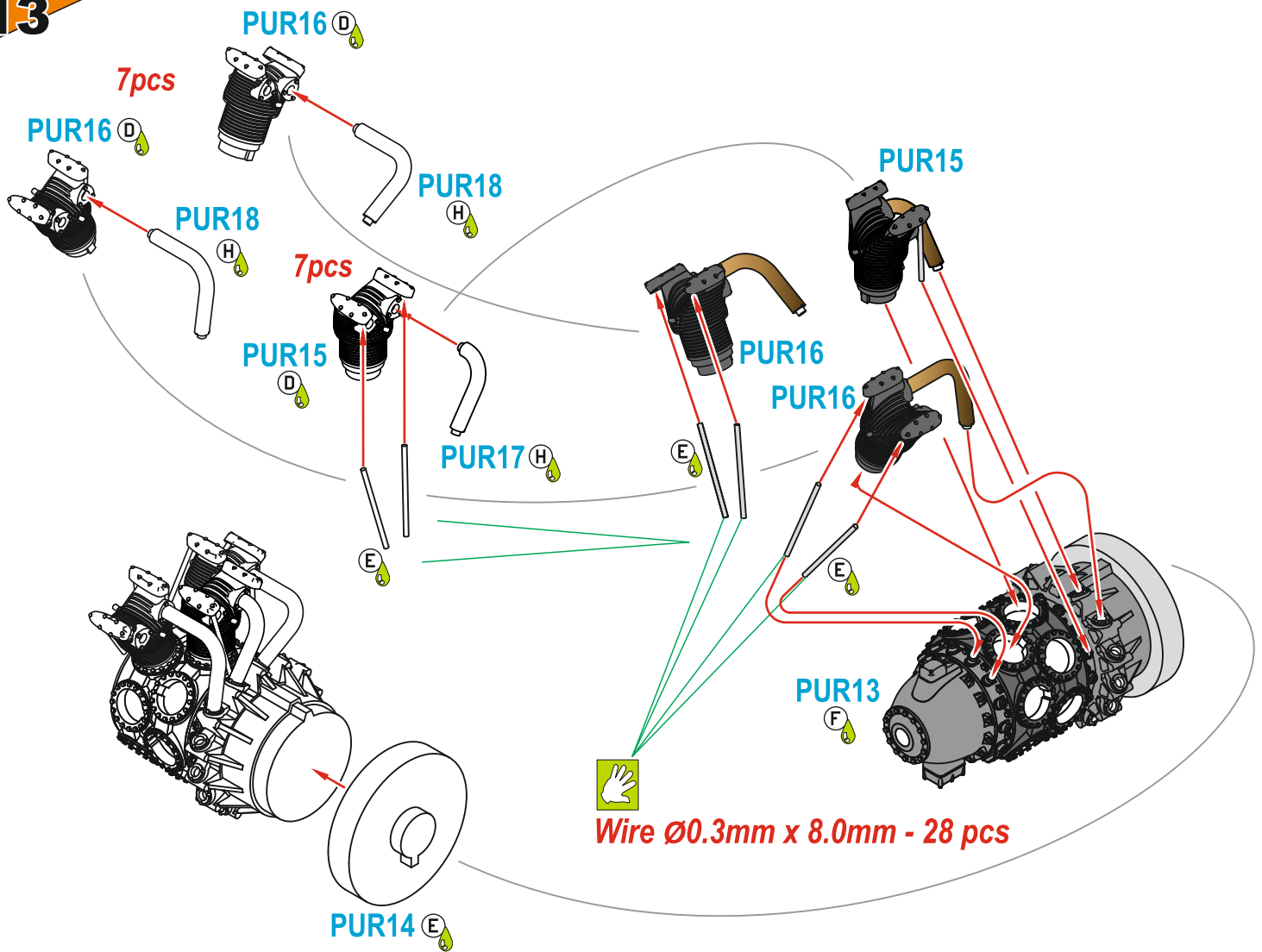

14

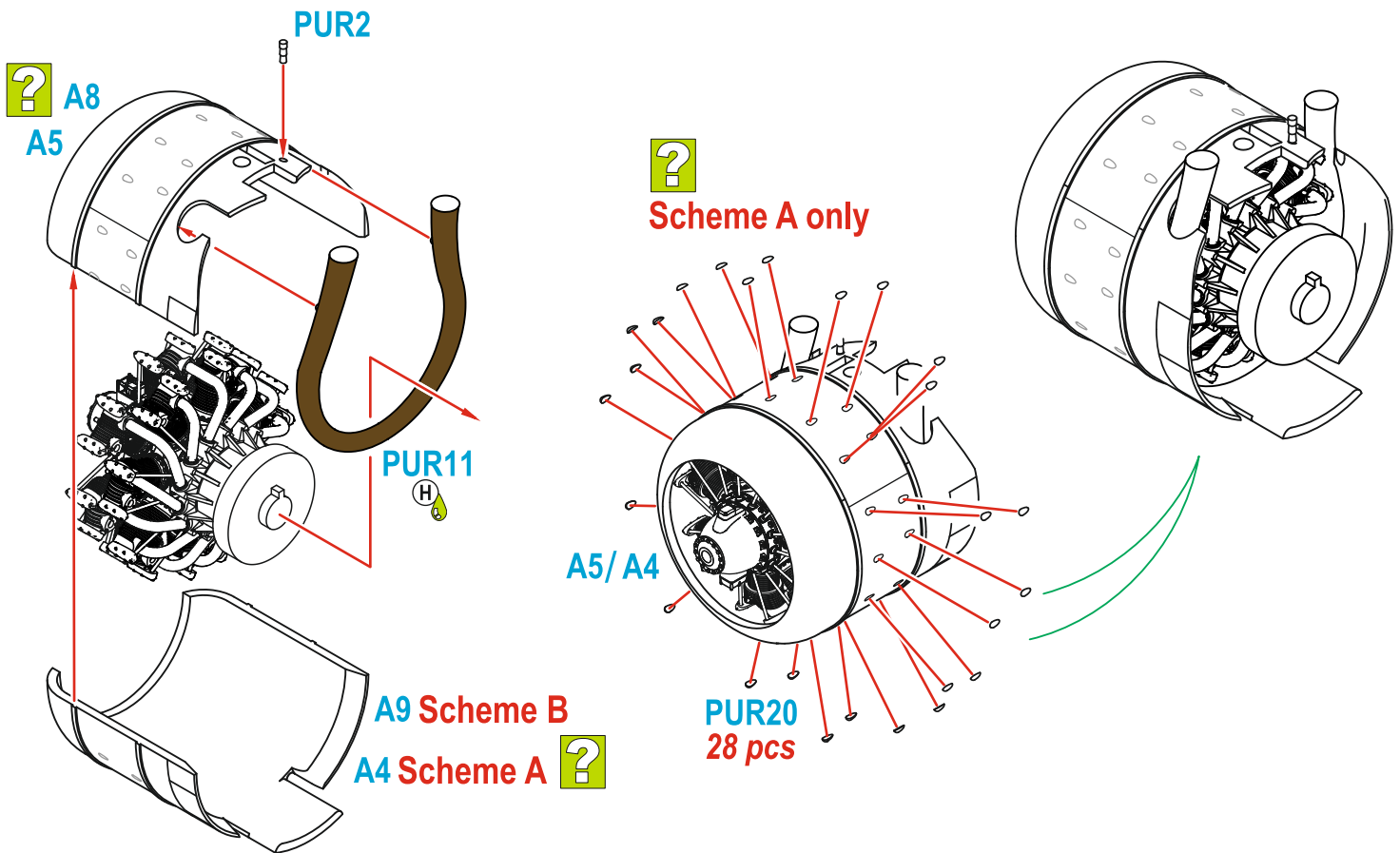

15 2x

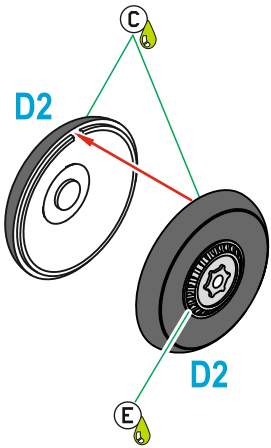

16

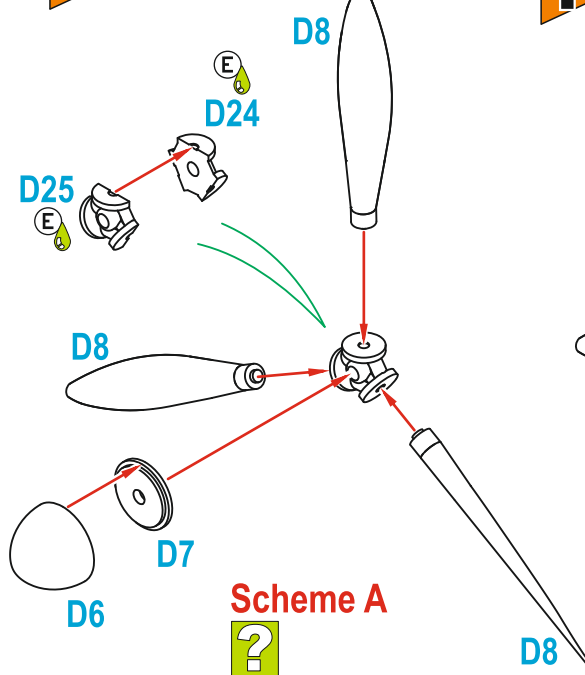

17

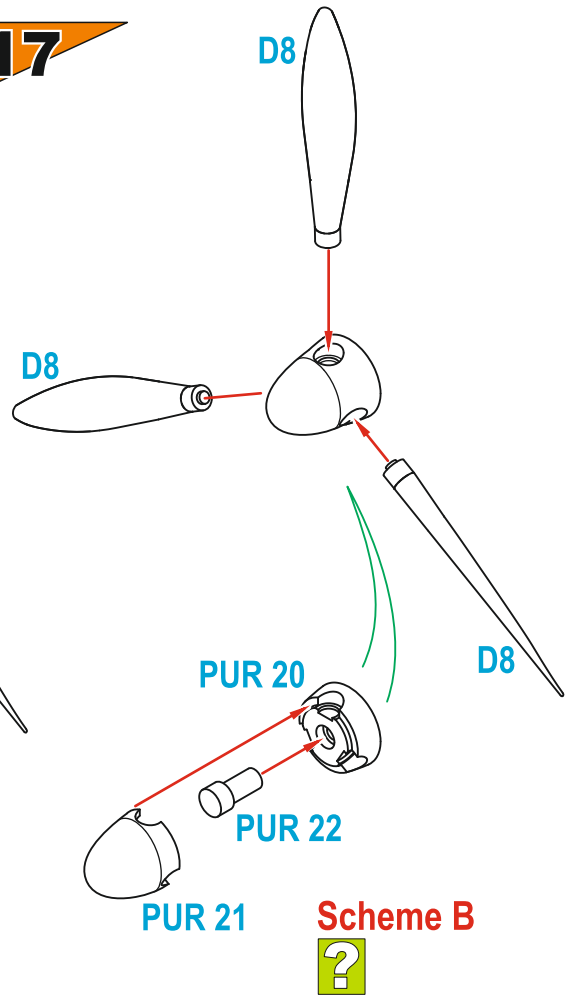

18

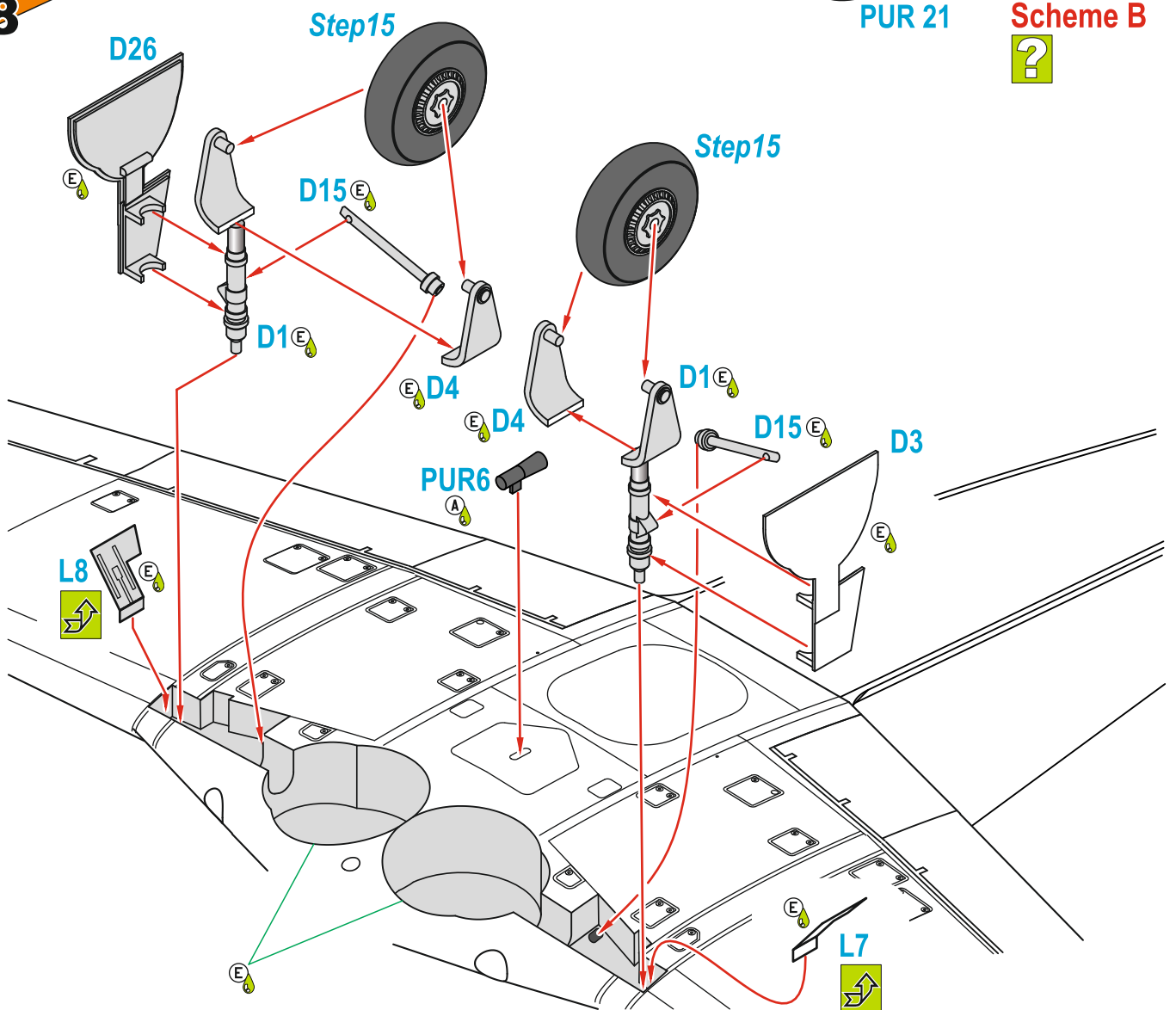

19

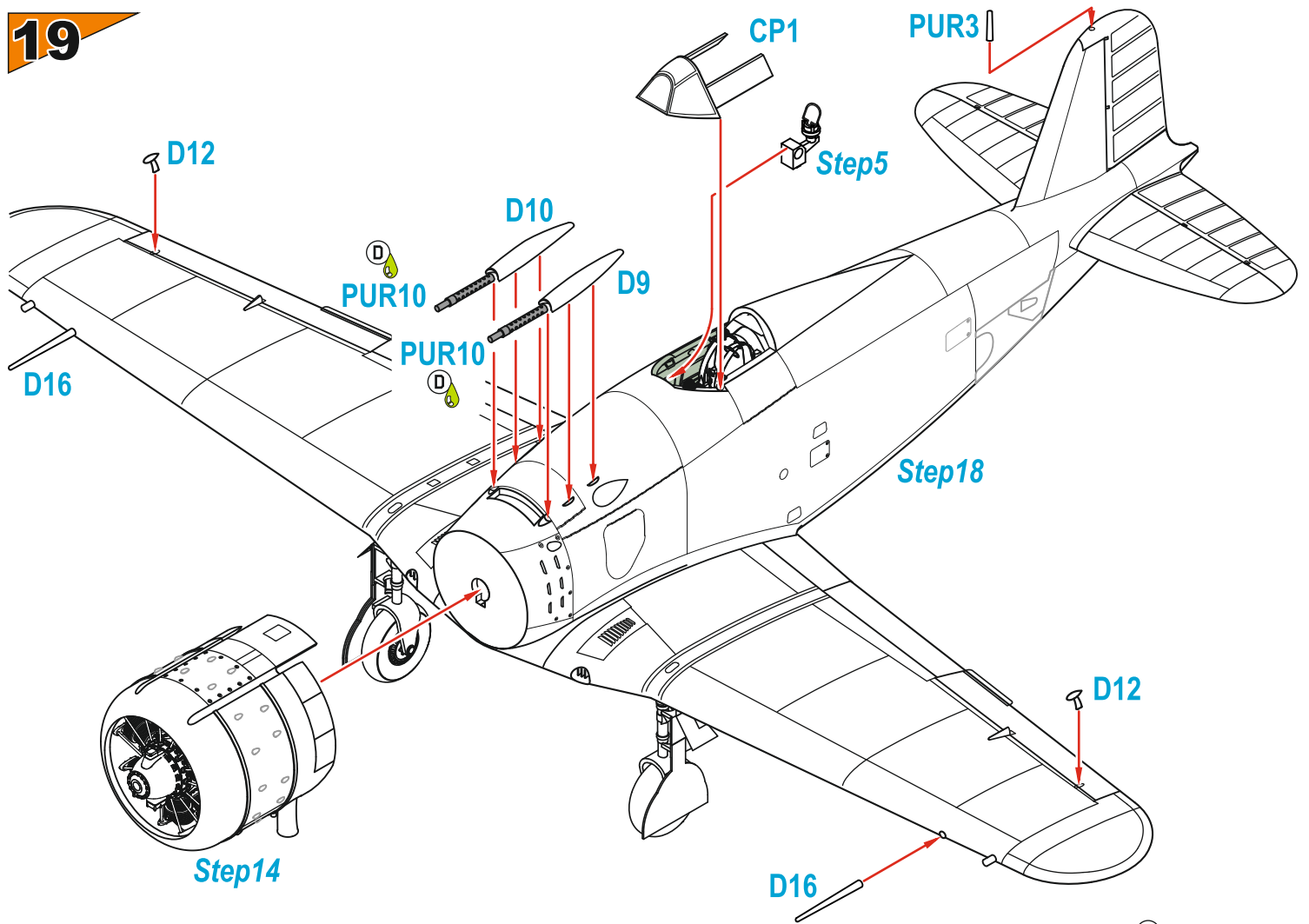

20

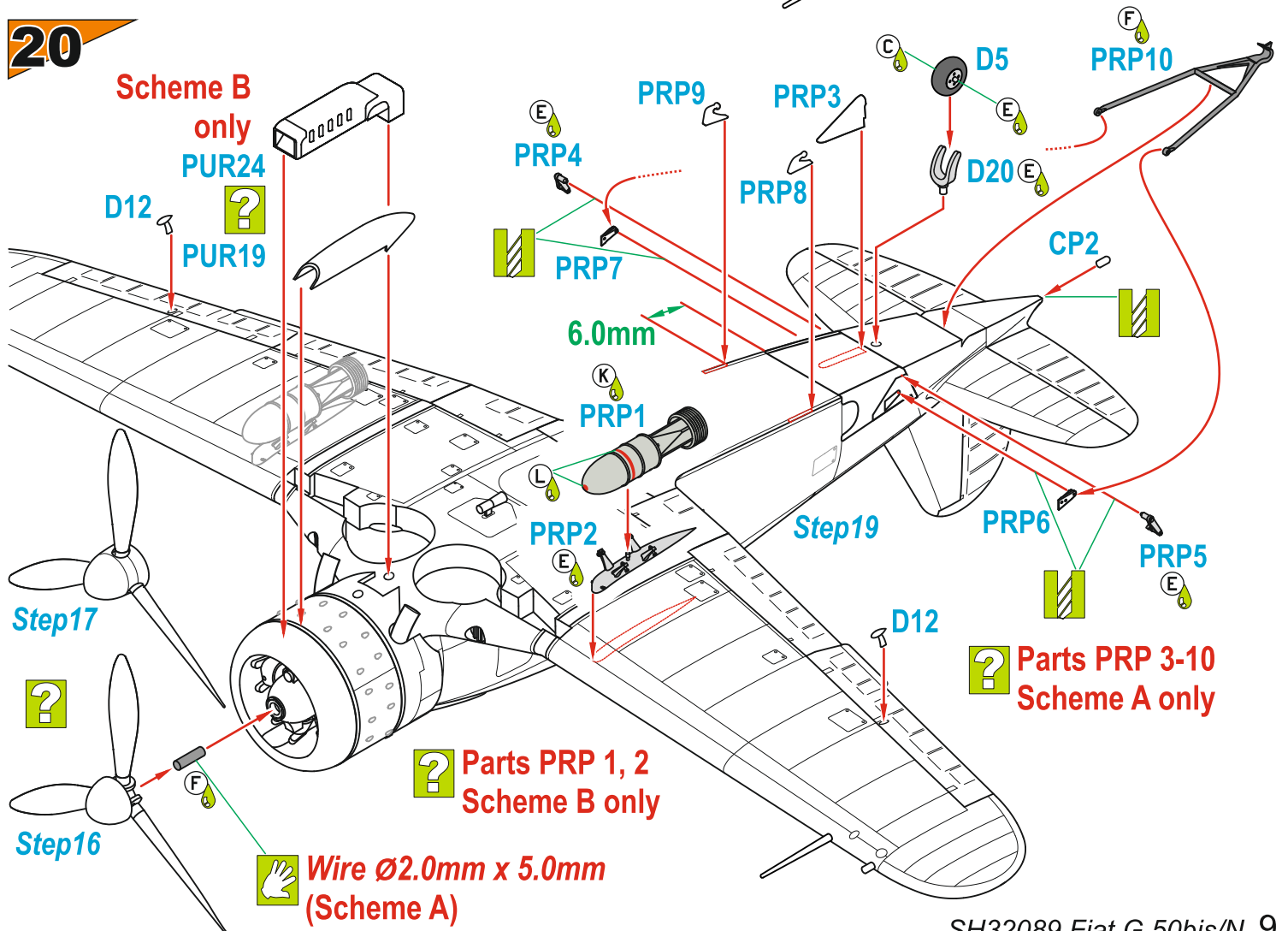

Fiat G.50bis/N, MM.5988, prototyp navalizované stíhací verze, státní letecké dílny Stabilimento Costruzioni Aeronautiche, základna Guidonia, 1942.

Fiat G.50bis/N, MM.5988, navalised fighter version prototype, Stabilimento Costruzioni Aeronautiche state aircraft workshop, Guidonia base, 1942.

Scheme A

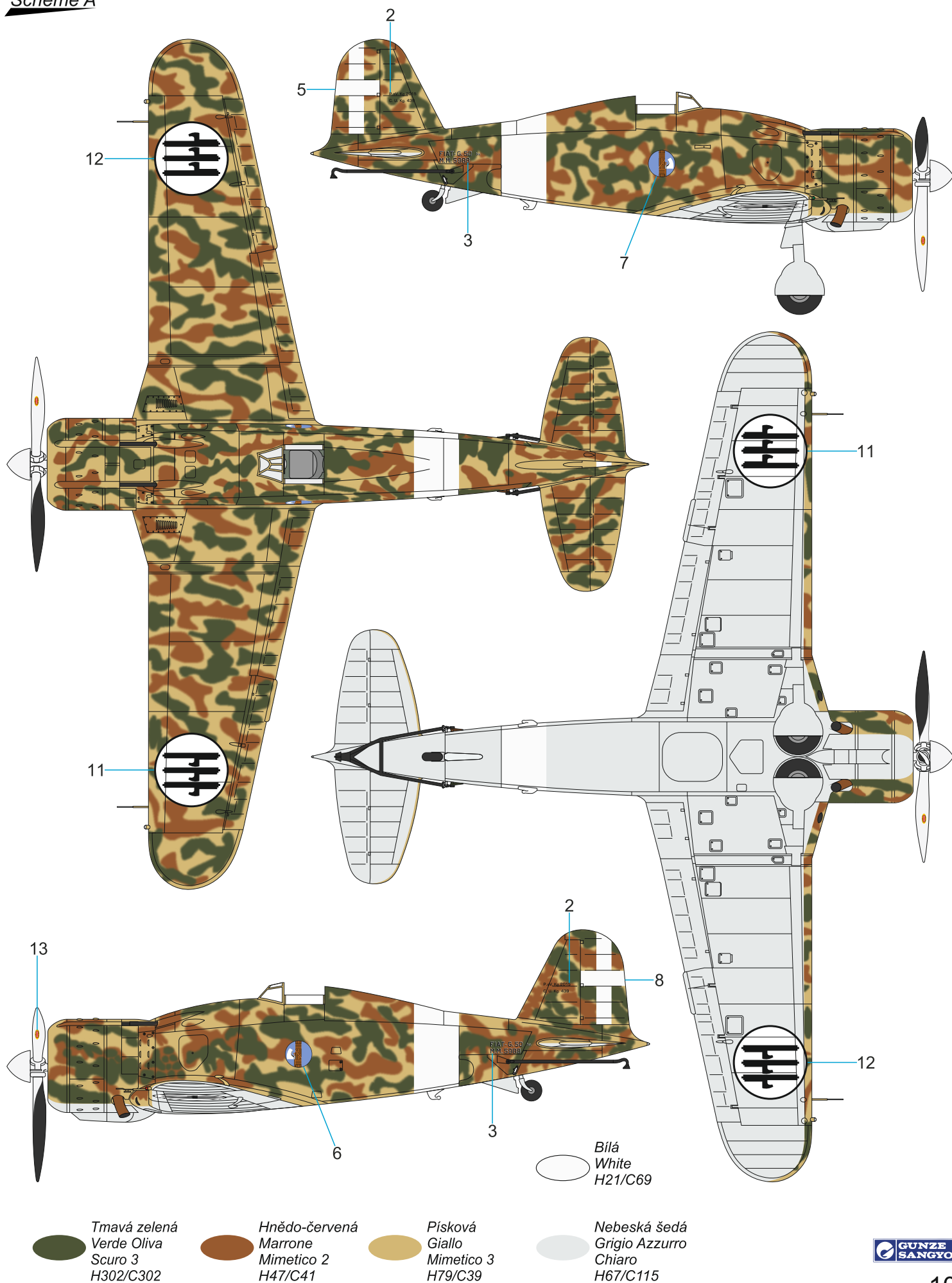

Tmavá zelená
Verde Oliva
Scuro 3
H302/C302

Hnědo-červená
Marrone
Mimetico 2
H47/C41

Písková
Giallo
Mimetico 3
H79/C39

Nebeská šedá
Grigio Azzurro
Chiaro
H67/C115



Fiat G.50bis, 165-12, 165a Squadriglia, 12° Gruppo Autonomo d' Assalto, základna Castelbenito, Tripolis, Italská Libye, Afrika, červenec 1942. Letoun byl pro operace v Africe vybaven pouštním filtrem a vzhledem k útočnému poslání jednotky také podkřídelními závěsníky bomb.

Fiat G.50bis, 165-12, 165a Squadriglia, 12° Gruppo Autonomo d' Assalto, Castelbenito base, Tripoli, Italian Libya, Africa, July 1942. For operations in Africa, the machine was fitted with a sand filter and it also had underwing bomb racks as the unit was primarily tasked with ground attack missions.

Scheme B

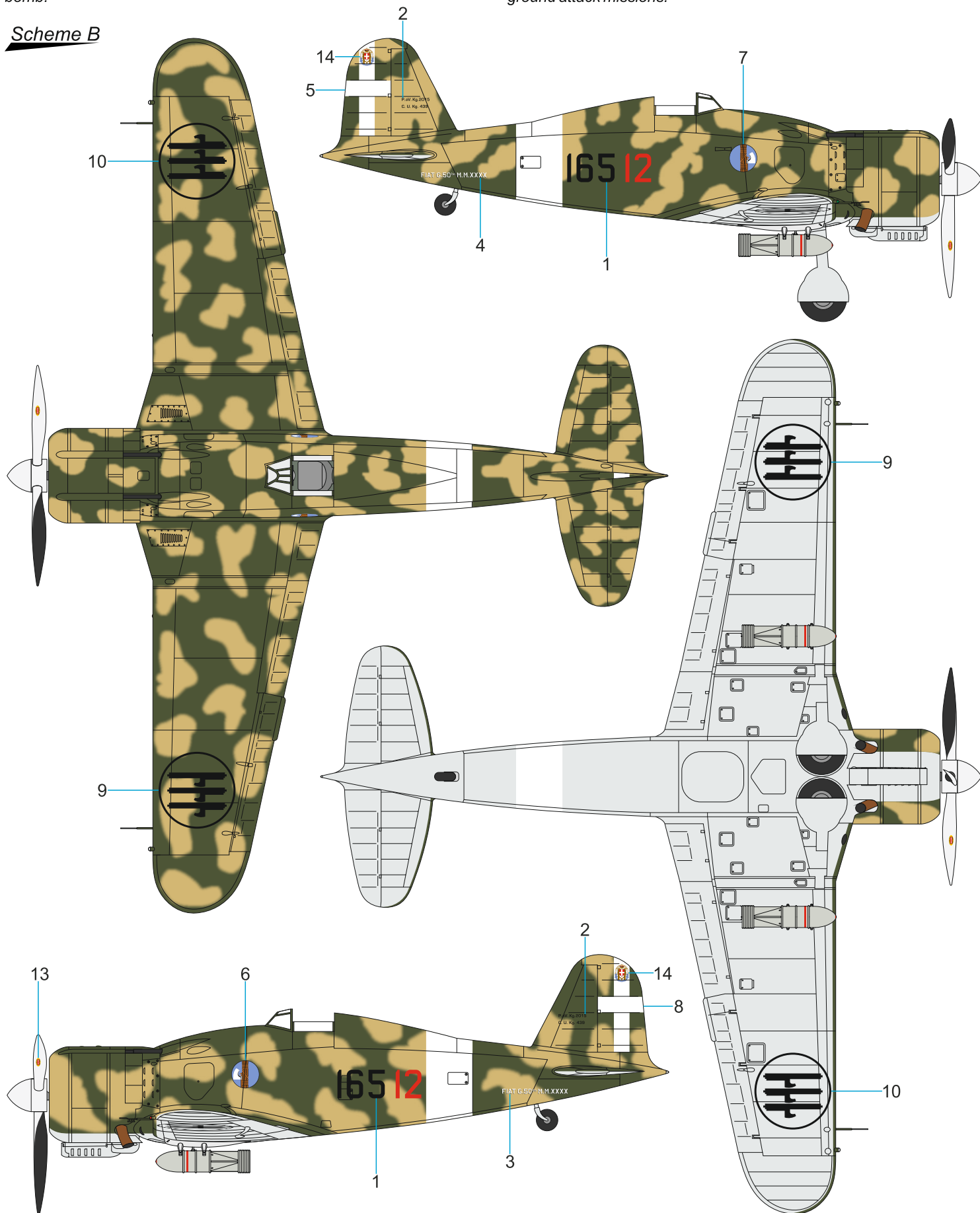

Tmavá zelená
Verde Oliva
Scuro 3
H302/C302

Písková
Giallo
Mimetico 3
H79/C39

Nebeská šedá
Grigio Azzurro
Chiaro
H67/C115

Bílá
White
H21/C69



1/32
SH32082



PUR parts

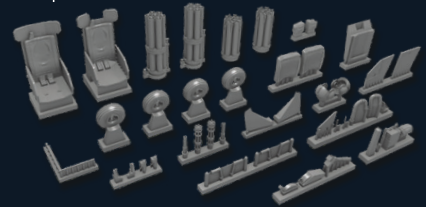

3D-printed parts



Masks

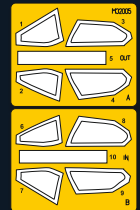
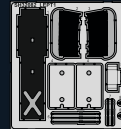

Photo-etched parts



AH-1G COBRA 'Early Tails over Nam' Hi-Tech Kit

1/32
SH32086



AH-1G Cobra 'Marines/US Navy' Hi-Tech Kit

ATTRACTIVE 1/32 SCALE SET FOR COBRA!

5144 M35 ARMAMENT SUBSYSTEM Upgrade Set for AH-1G Cobra

CMK sets for ICM and Revell kits

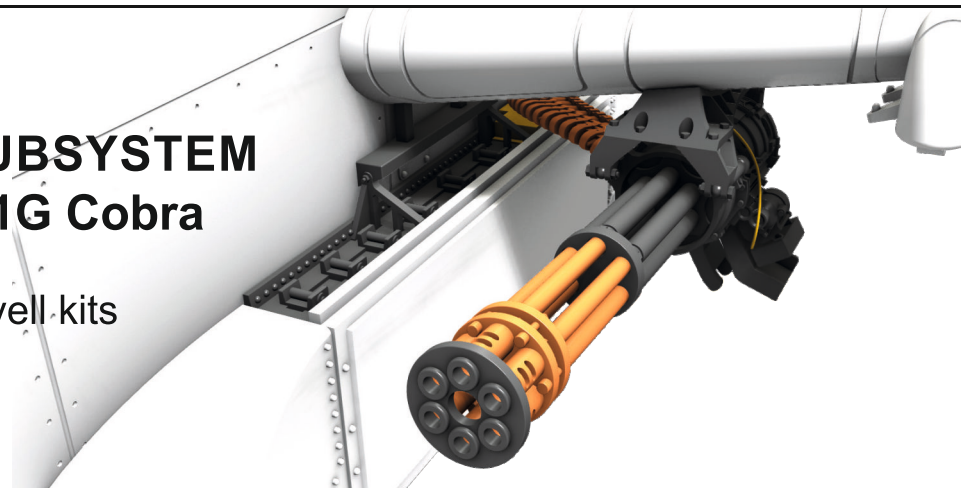

special
HOBBY

 facebook.com/specialhobby
WWW.SPECIALHOBBY.EU | WWW.CMKKITS.COM

CZECH
MASTER'S KITS