

4407 DH.82 Tiger Moth Cockpit Correction Set
for Airfix kit

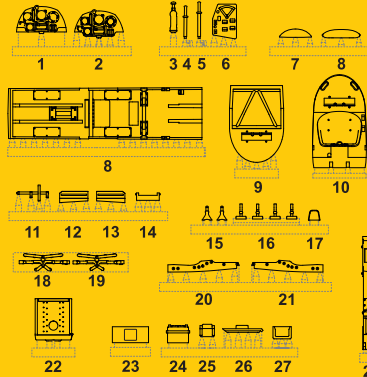

PUR - Polyurethane parts



D - Decals



PE - Photo-etched parts



Díly ohnuté popř. pokroucené vlivem teplotních změn a stárnutí materiálu, mohou být narovnány do požadovaného tvaru pomocí proudu teplé vody nebo vzduchu (fén na vlasy).

Parts slightly distorted and bent owing to temperature changes or due to material ageing can be straightened to requested shape by hot water or hot air jet. (hair dryer)

This process can be repeated till result is entirely satisfactory.

K lepení použít kvanoakrylátové lepidlo!

For best result gluing use cyanoacrylate glue!

Kontaktní plochy doporučujeme před lepením odmastit

Contact areas ungrease is recommended before gluing.

Visit our official website and e-shop at www.cmkkits.com

www.specialhobby.eu

www.facebook.com/specialhobby/



for 1/48 Tiger Moth we also offer:

129-4410
DH.82
Tiger Moth
Exterior Set

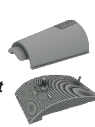

129-4409
DH.82 Tiger Moth
Luggage Box



129-4411
DH.82 Tiger Moth
Mainwheels
and Tailskid



129-4412
DH.82 Tiger Moth
Cockpit Entry
Hatches (4pcs, open)



and other sets ...

Special Hobby, Mezilesí 718, Praha 9, 193 00, Czech Republic
e-mail: office@specialhobby.eu

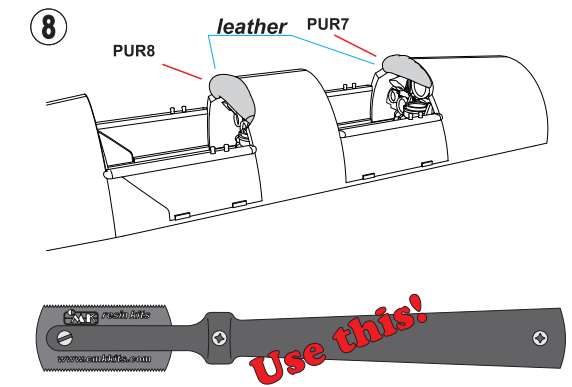
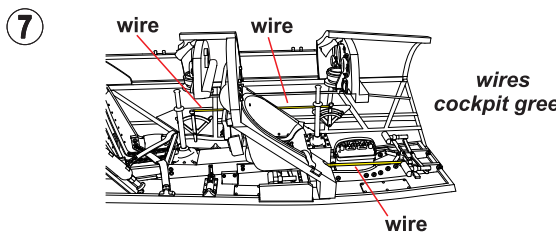
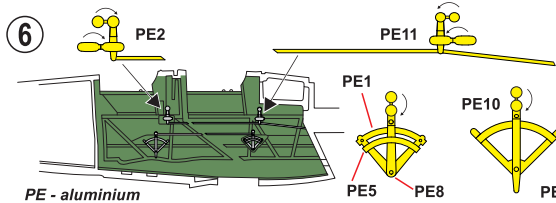
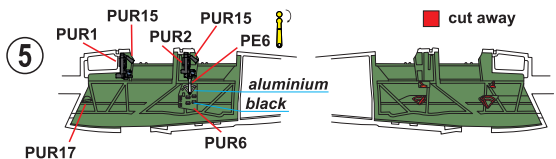
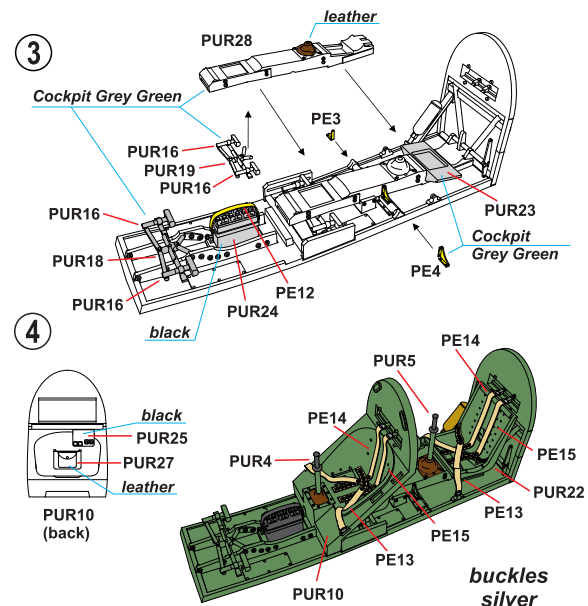
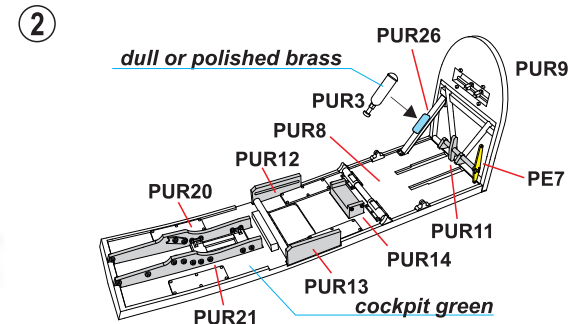
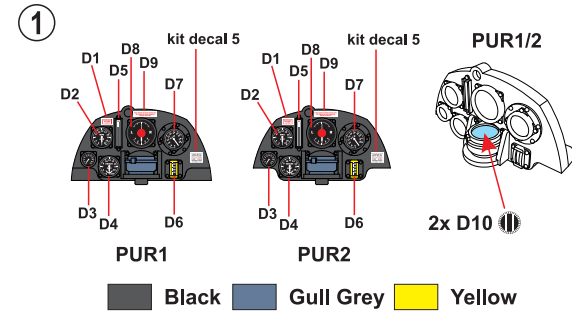

CMK H1010

The Razor Saw with Handle (cat. n. H1010) is a great tool for cutting both plastic and resin. CMK also offers a wide variety of coarse / medium / fine saws.