



Odlévaný model / All resin kit

5129 1/32

WWII Bristol Centaurus Engine for Tempest Mk.II

Visit our official website and e-shop at specialhobby.eu or cmkkits.com

Polyurethane parts PUR

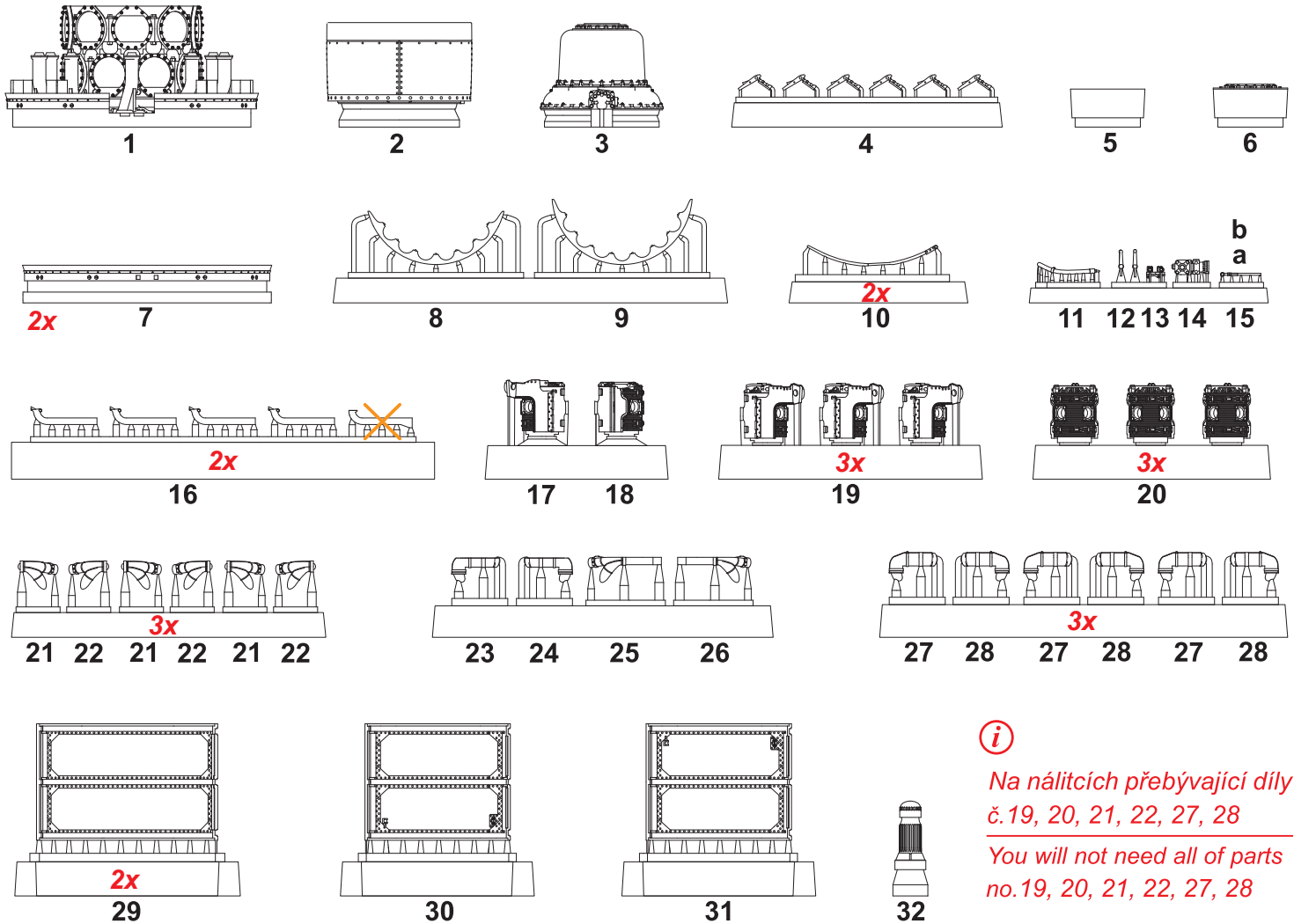

Na náلتicích přebývající díly č. 19, 20, 21, 22, 27, 28

You will not need all of parts no. 19, 20, 21, 22, 27, 28

Díly ohnuté popřípadě pokroucené vlivem teplotních změn a stárnutí materiálu, mohou být narovnané do požadovaného tvaru pomocí proudu teplé vody nebo vzduchu (fén na vlasy). Různé drátky a tyčky nejsou přiloženy. Kontaktní plochy doporučujeme před lepením odmastit

Parts slightly distorted and bent owing to temperature changes or due to material ageing can be straightened to requested shape by hot water or hot air jet (hair dryer). This process can be repeated till result is entirely satisfactory. Wires and rods not included. It is recommended to remove grease from contact areas.

K lepení použít kyanoakrylátové lepidlo! / For best gluing results use cyanoacrylate glue!

SYMBOLS



MOŽNOST VOLBY
OPTIONAL
NACH BELIEBEN
OPTION



POUŽÍT KYANOAKRYLÁTOVÉ LEPIDLO
INSTANT CYANOACRYLATE GLUE
ZYANOAKRYLÁTKLEBER
ADHÉSIF CYANOACRYLAT



OHNOUT
BEND
BIEGEN
COURBER



ZHOTOVIT NOVÉ
SCRATCH BUILD
FERTIGSTELLEN
ACHEVER



ŘEZAT/VRTAT
CUT OFF/DRILL
ENTFERNEN
DETACHER



NATRÍT
COLOUR
FARBEN
PEINDRE

KROK STEP 1

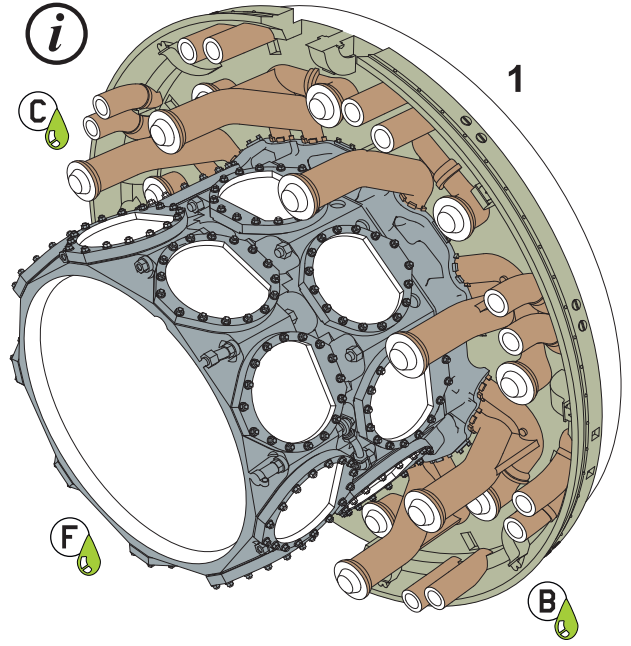
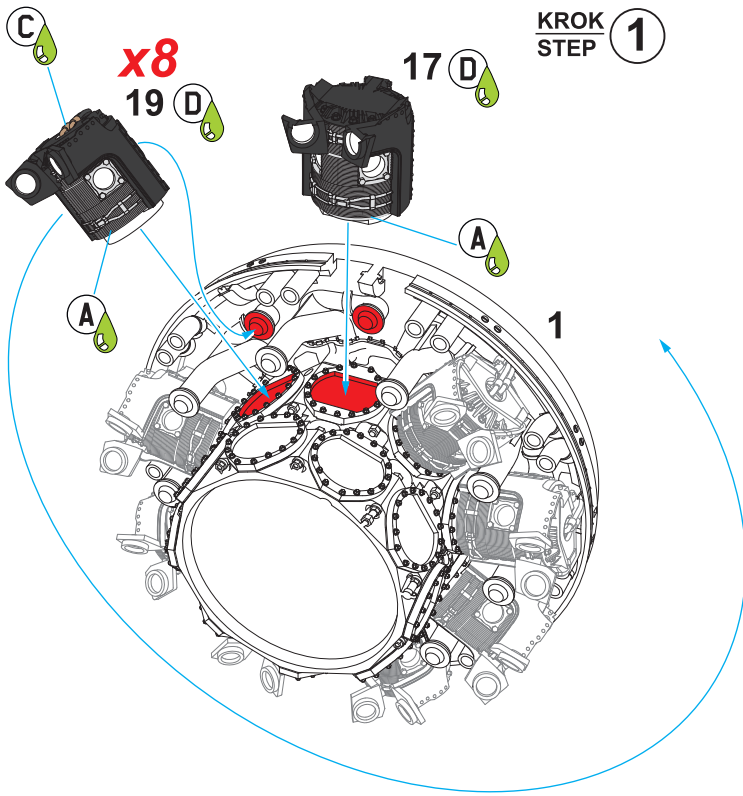

KROK STEP 2 x8

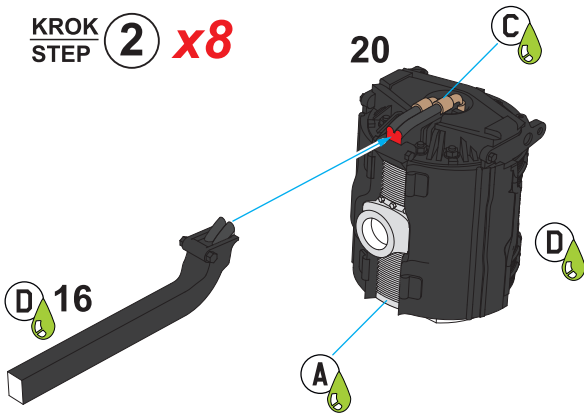

KROK STEP 3

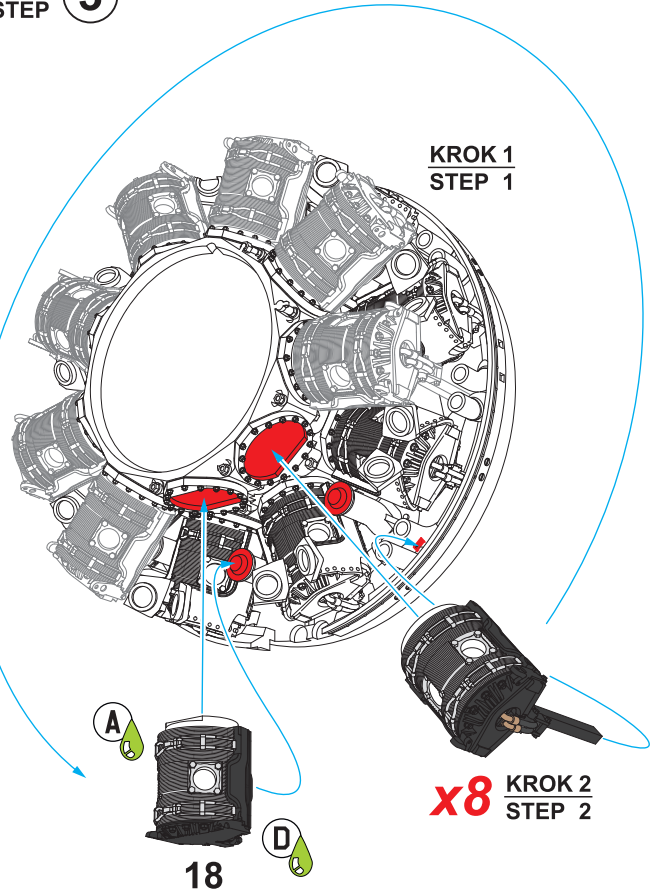

KROK STEP 4

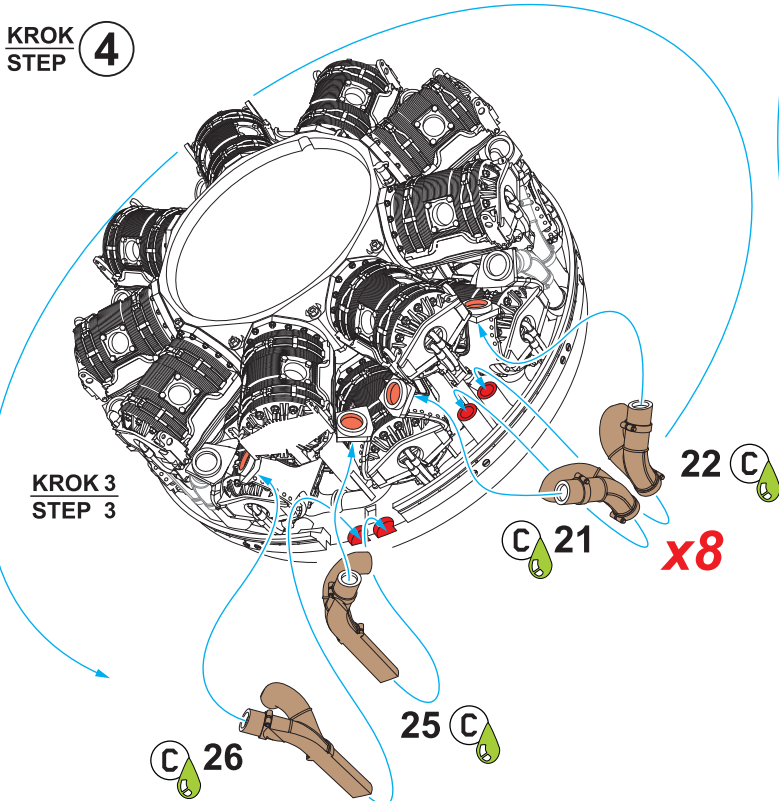

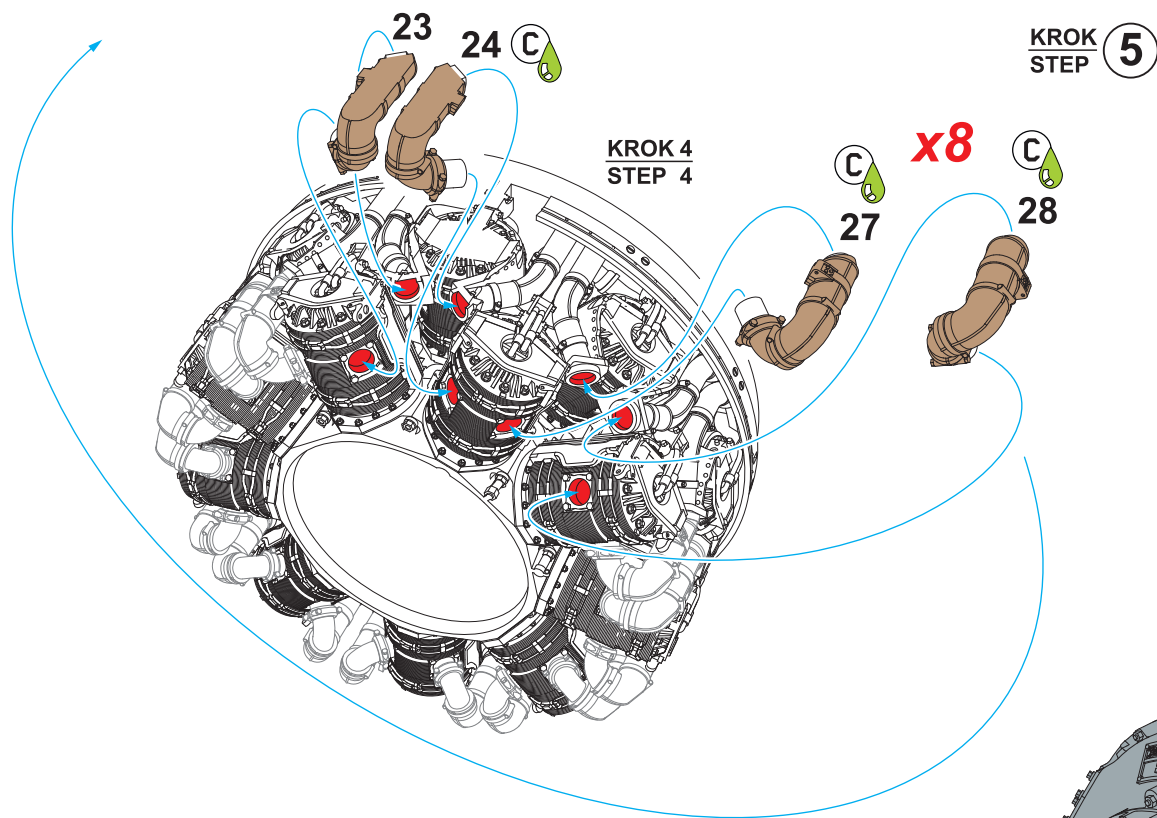

Rozhodněte se, zda chcete stavět motor se sejmutým krytem reduktoru (kroky 6, 7, 8) a nebo s reduktorem v krytu (kroky 7 a 8, krok 6 vynechte).

KROK STEP 6 ?

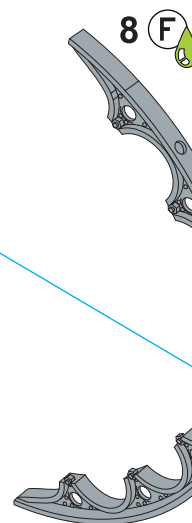
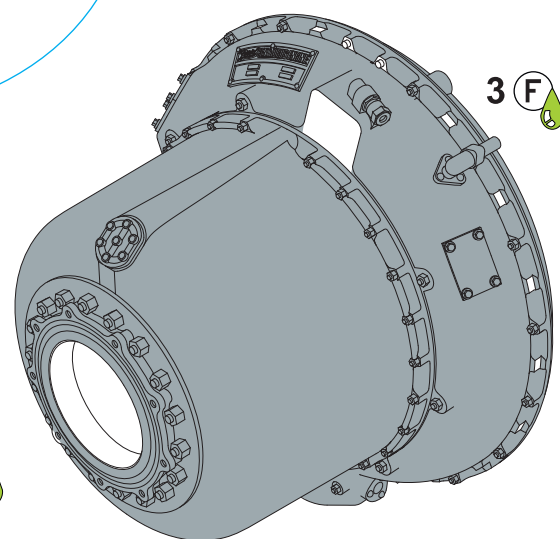
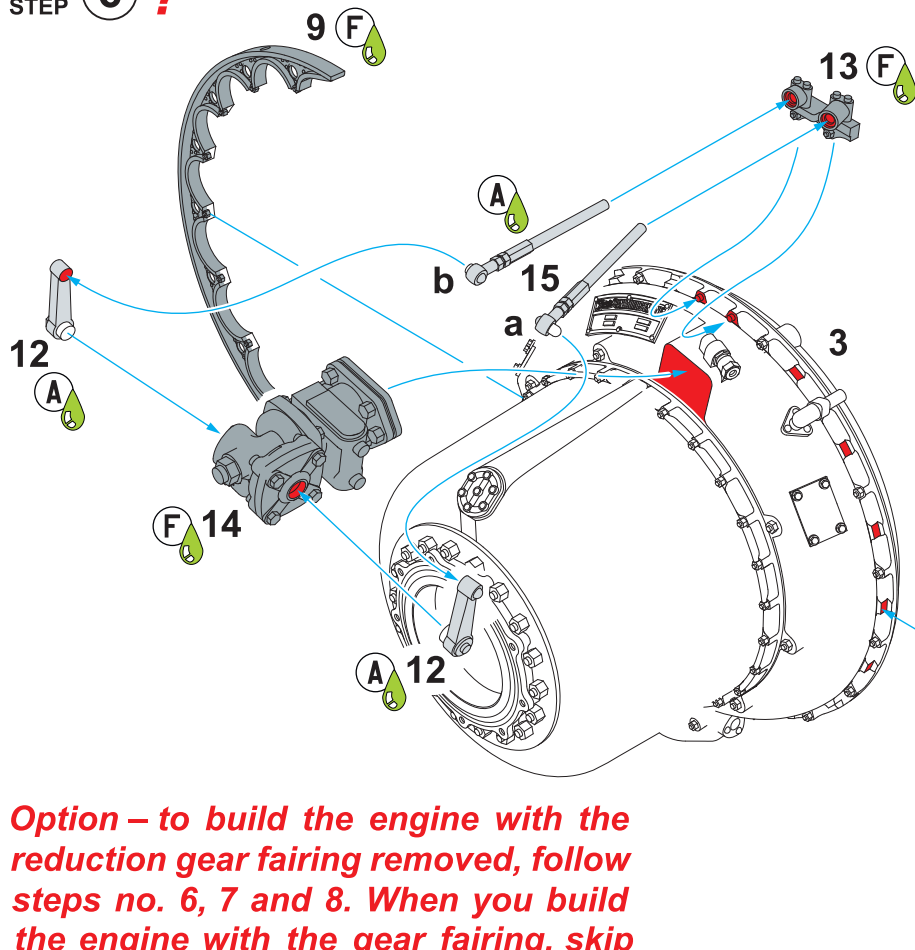

Option – to build the engine with the reduction gear fairing removed, follow steps no. 6, 7 and 8. When you build the engine with the gear fairing, skip step no. 6 and follow steps no. 7 and 8.

KROK
STEP 7

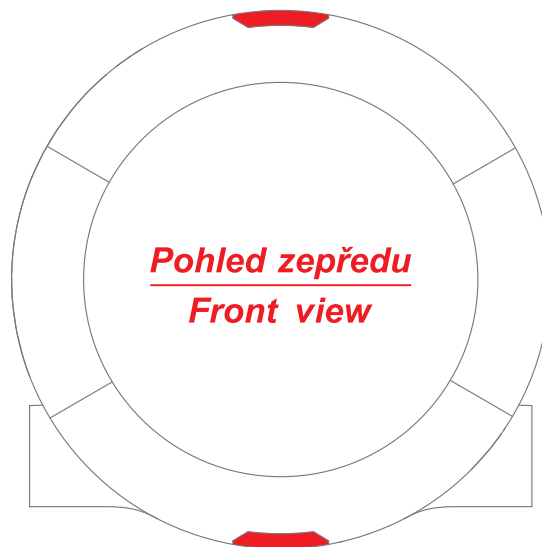
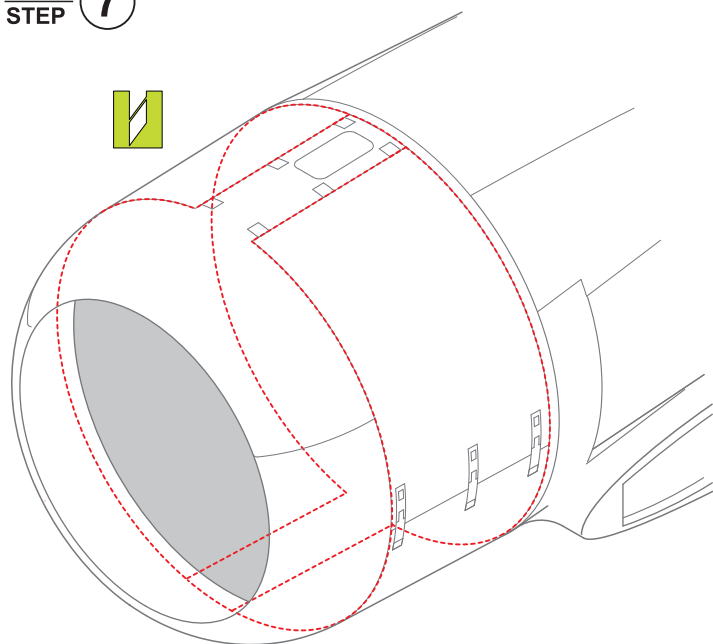

Díly modelu Tempest Mk.II
Tempest Mk.II kit parts

KROK
STEP 8

Barva podle kuželu vrtule
Paint to match the spinner colour

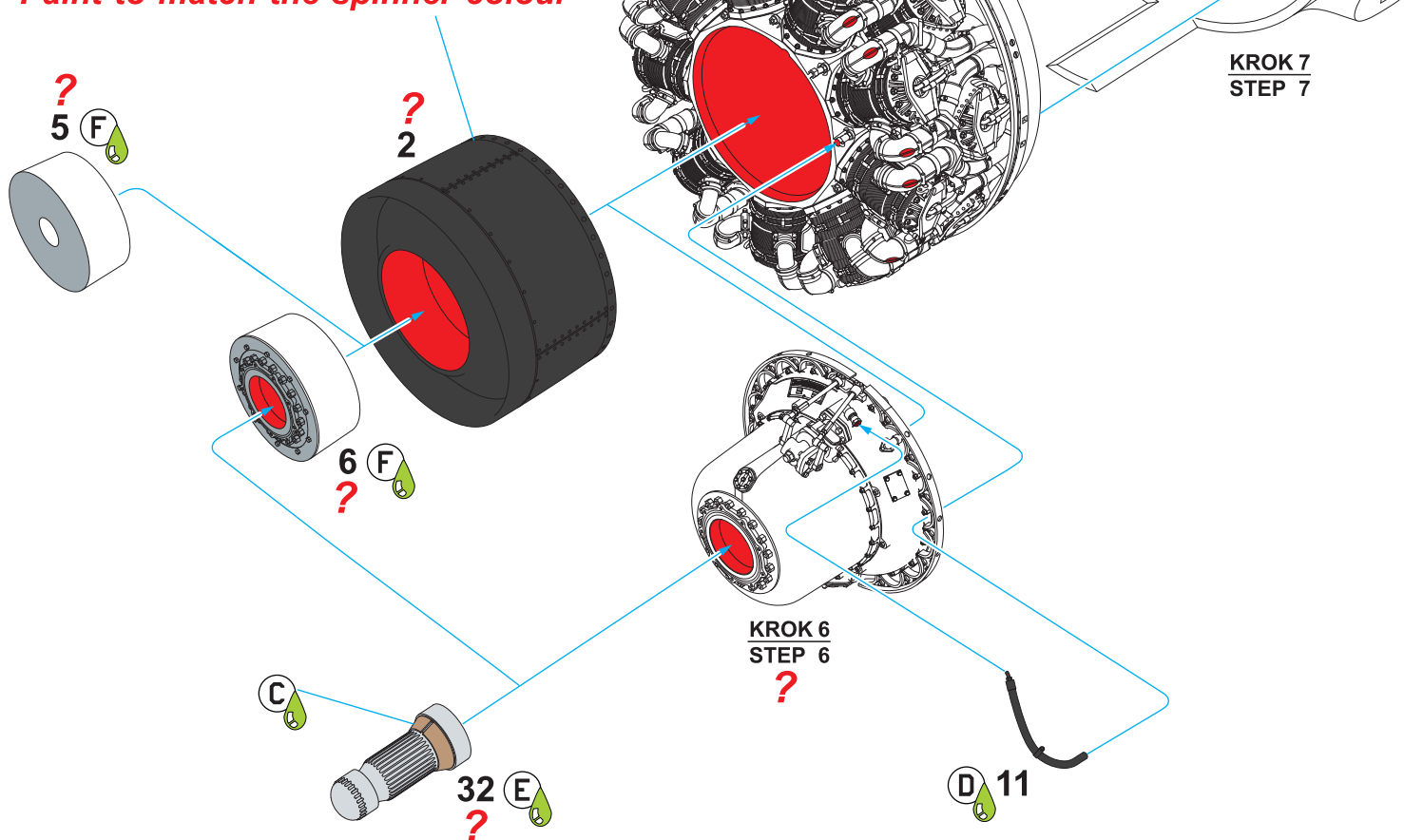

**Pro pozdější nalepení vrtule použijte
díl č. 5, pro model se sejmudou vrtulí
díl č. 32**

**To fit the prop at the later stage, use
part no. 5. If you intend to build your
model sans the prop, use part no. 32**

KROK
STEP **9**

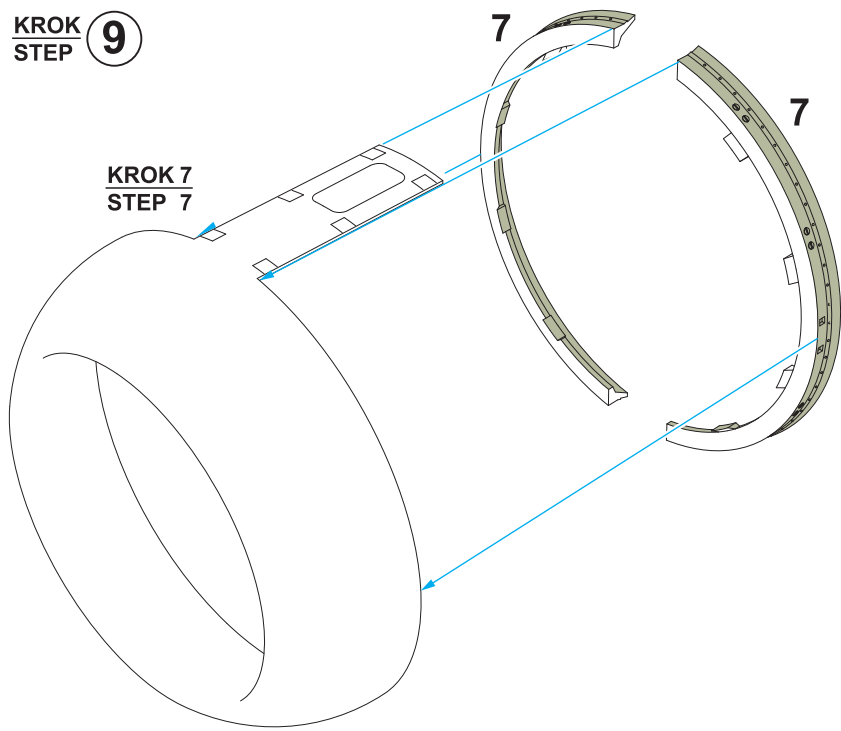

KROK
STEP **10**

KROK 8
STEP 8

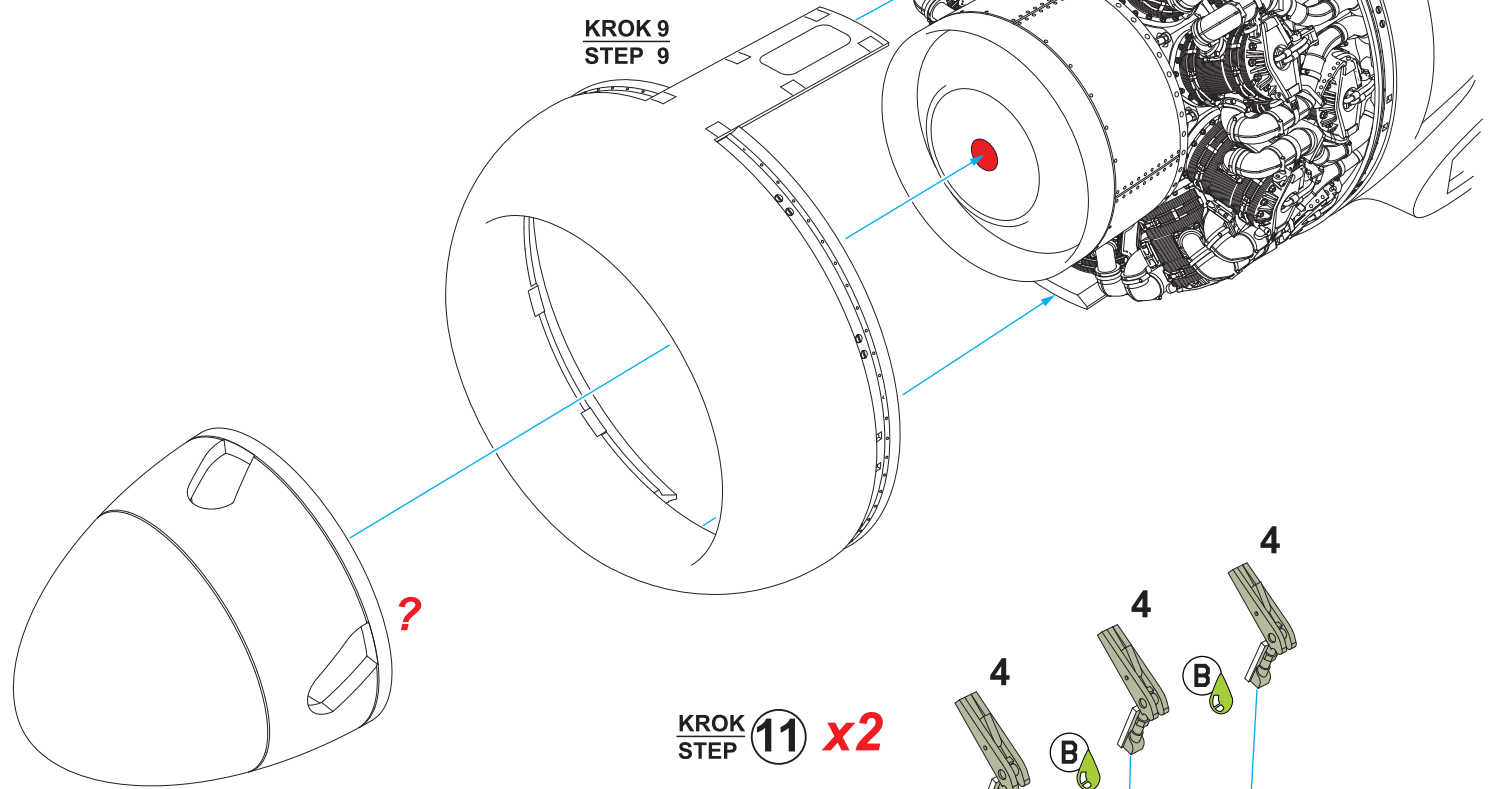

Díly modelu Tempest Mk.II
Tempest Mk.II kit parts

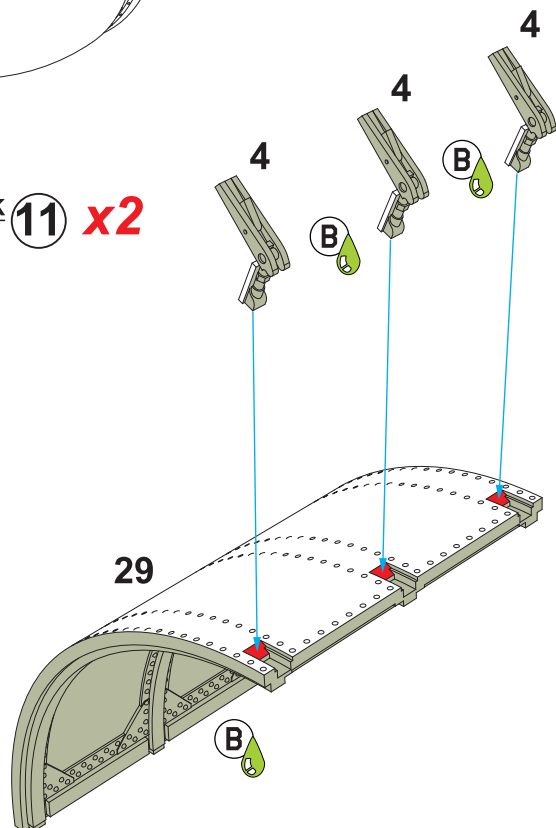

KROK
STEP **12**

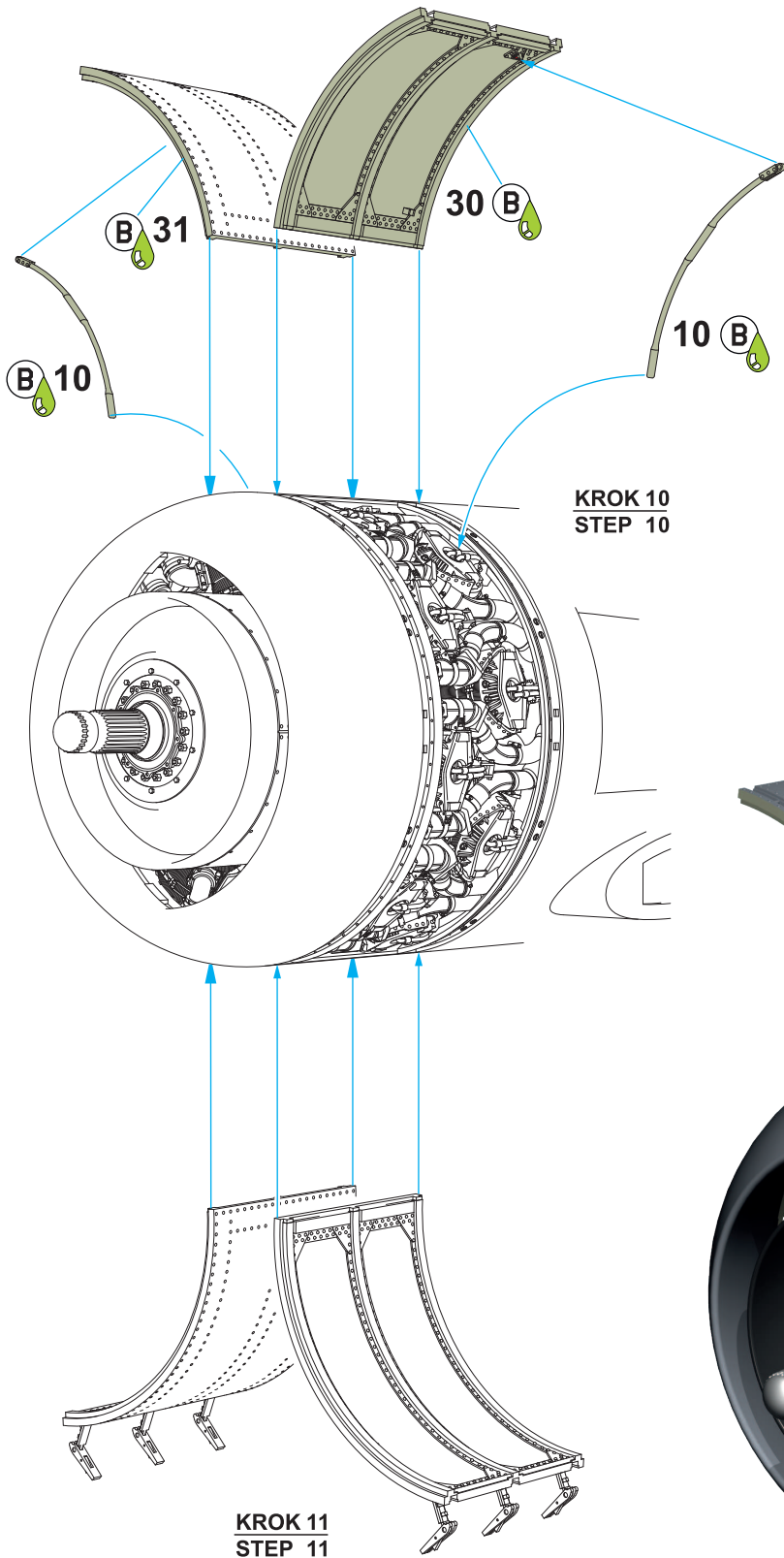

	A		B
Hliník Aluminium		Šedozelená interiérová Interior Grey Green	
	C		D
Opálený kov Burnt Iron		Černá Black	
	E		F
Ocel Steel		Motorová šedá Engine Grey	

