

- 
Dark Green
 Gunze C361
 MrPaint MRP-110
- 
Earth Brown
 Gunze C369
 MrPaint MRP-108
- 
Ocean Grey
 Gunze C362
 MrPaint MRP-115
- 
Sky type 9
 Gunze C368
 MrPaint MRP-118
- 
Medium Sea Grey
 Gunze C363
 MrPaint MRP-112
- 
Sky Blue
 Gunze C117
 MrPaint MRP-066
- 
Yellow
 Gunze C329
 MrPaint MRP-122



HAWKER HURRICANE MK.IIa 1/32 MN-HOBBY 32MNOO I



Přestože v období Bitvy o Británii byl Hawker Hurricane Mk. I nejrozšířenější britskou stíhačkou, již v průběhu bitvy se začalo ukazovat, že za stroji protivníka začíná výkonově zaostávat, což se projevilo zejména poté, co Němci nasadili Bf-109F. Konflikt rovněž prokázal, že výzbroj v podobě kulometů puškové ráže přestává stačit. V případě zvýšení výkonu pomohlo řešení v podobě zástavby motoru Merlin XX s dvoustupňovým kompresorem, který oproti Merlinům II a III s výkonem 767 kW zabudovaným v Hurricanech Mk.I, přinesl nárůst výkonu na 989 kW. Zástavbou motoru Merlin XX došlo k prodloužení přední motorové části a stroje o 0,18 metru a stroje s tímto motorem dostaly označení Hawker Hurricane Mk.IIa. První stroje, označené jako Series I se od Hurricaneů Mk.I pozdní produkce lišily pouze motorovou zástavbou. Další úpravou bylo zesílení konstrukce trupu a instalace závěsných bodů na křídle umožňujících nesení přídavných nádrží o objemu 205, nebo 409 litrů, nebo dvou pum o váze 227 kg, popřípadě instalaci pouzder s kanóny. Tyto úpravy si také vyžádaly změnu konstrukce ostruhového kola a takto upravené stroje byly označovány jako Mk.IIa Series II. Nedostatečná výzbroj se posléze řešila nejprve zástavbou dvojice dalších kulometů Browning ráže 0.303 do vnější části každého křídla, čímž počet kulometů vzrostl na 12. Stroje s touto výzbrojí dostaly označení Mk.IIb a začaly opouštět tovární linku v Langley koncem roku 1940. Ani toto řešení nebylo dostatečné, hlavně díky malé účinnosti střeliva puškové ráže v cíli a tak došlo k zástavbě dvojice kanonů Hispano ráže 20 mm do každé poloviny křídla. Stroje s touto výzbrojí dostaly označení Mk.IIc a jejich produkce začala počátkem února 1941.



Although the Hawker Hurricane Mk. I was the most widespread British fighter during the Battle of Britain, it became apparent during the battle that it was beginning to lag behind enemy aircraft in terms of performance, which became particularly evident after the Germans deployed the Bf-109F. The conflict also demonstrated that rifle-caliber machine guns were no longer sufficient armament. In terms of increasing performance, the solution was to install a Merlin XX engine with a two-stage supercharger, which, compared to the Merlin II and III engines with 767 kW installed in the Hurricane Mk.I, brought an increase in power to 989 kW. The installation of the Merlin XX engine lengthened the front engine section and the aircraft by 0.18 meters, and aircraft with this engine were designated Hawker Hurricane Mk. IIa. The first aircraft, designated Series I, differed from the late production Hurricanes Mk. I only in the engine installation. Another modification was the reinforcement of the fuselage structure and the installation of suspension points on the wing to carry additional fuel tanks with a capacity of 205 or 409 liters, or two bombs weighing 227 kg, or the installation of gun pods. These modifications also required a change in the tailwheel design, and the modified aircraft were designated Mk. IIa Series II. The insufficient armament was initially addressed by installing two additional 0.303 caliber Browning machine guns on the outer part of each wing, bringing the total number of machine guns to 12. Aircraft with this armament were designated Mk. I Ib and began rolling off the production line in Langley at the end of 1940. Even this solution was not sufficient, mainly due to the low effectiveness of rifle-caliber ammunition on targets, so a pair of 20 mm Hispano cannons were installed in each half of the wing. Aircraft with this armament were designated Mk. I Ic, and their production began in early February 1941.



Schéma rozmístění popisek



Detailní informace o působení československých letců na britské stíhačce Hawker Hurricane najdete v knihách Zdeňka Hurta a Jiřího Šebka

HAWKER HURRICANE A ČECHOSLOVÁCI.

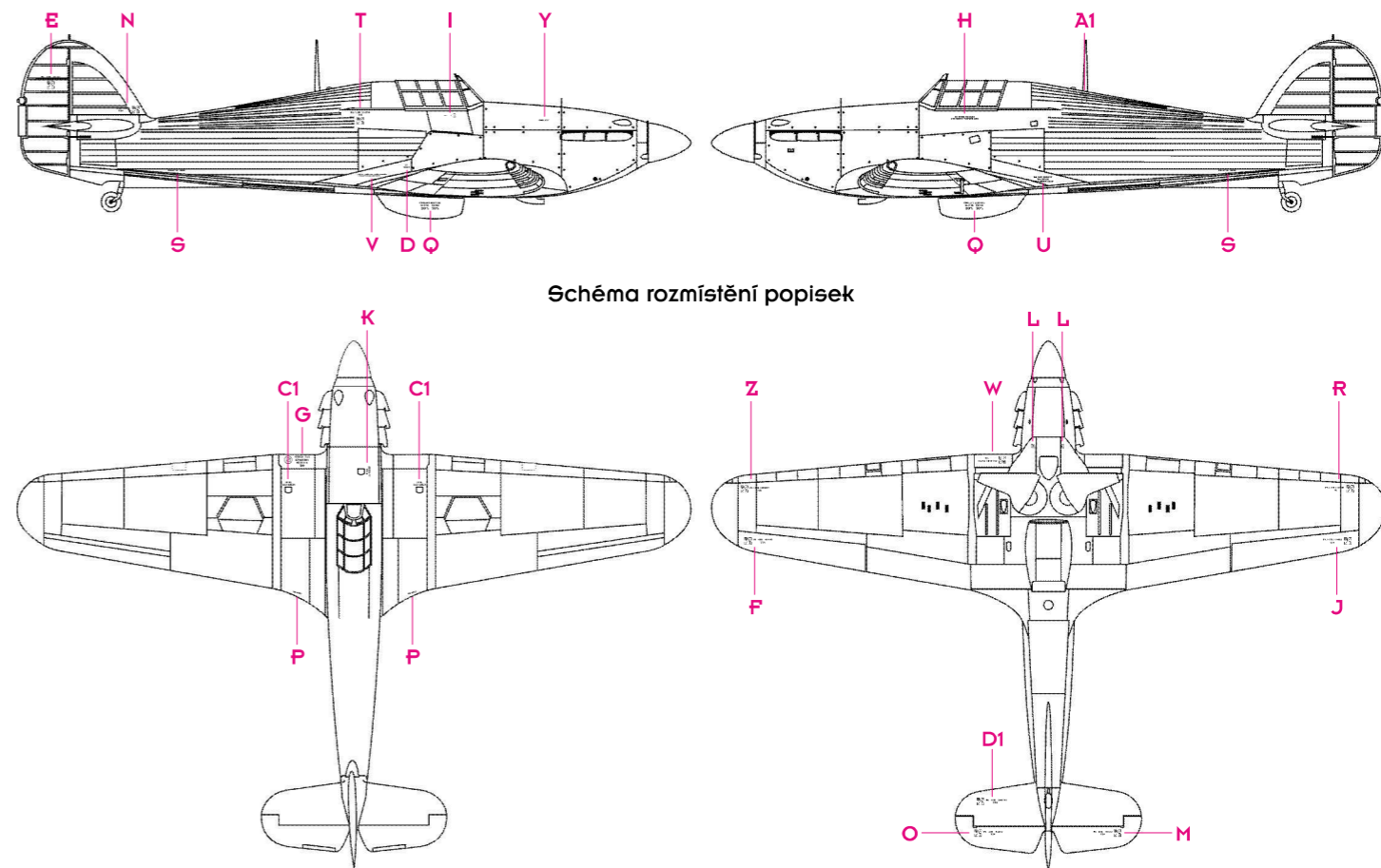
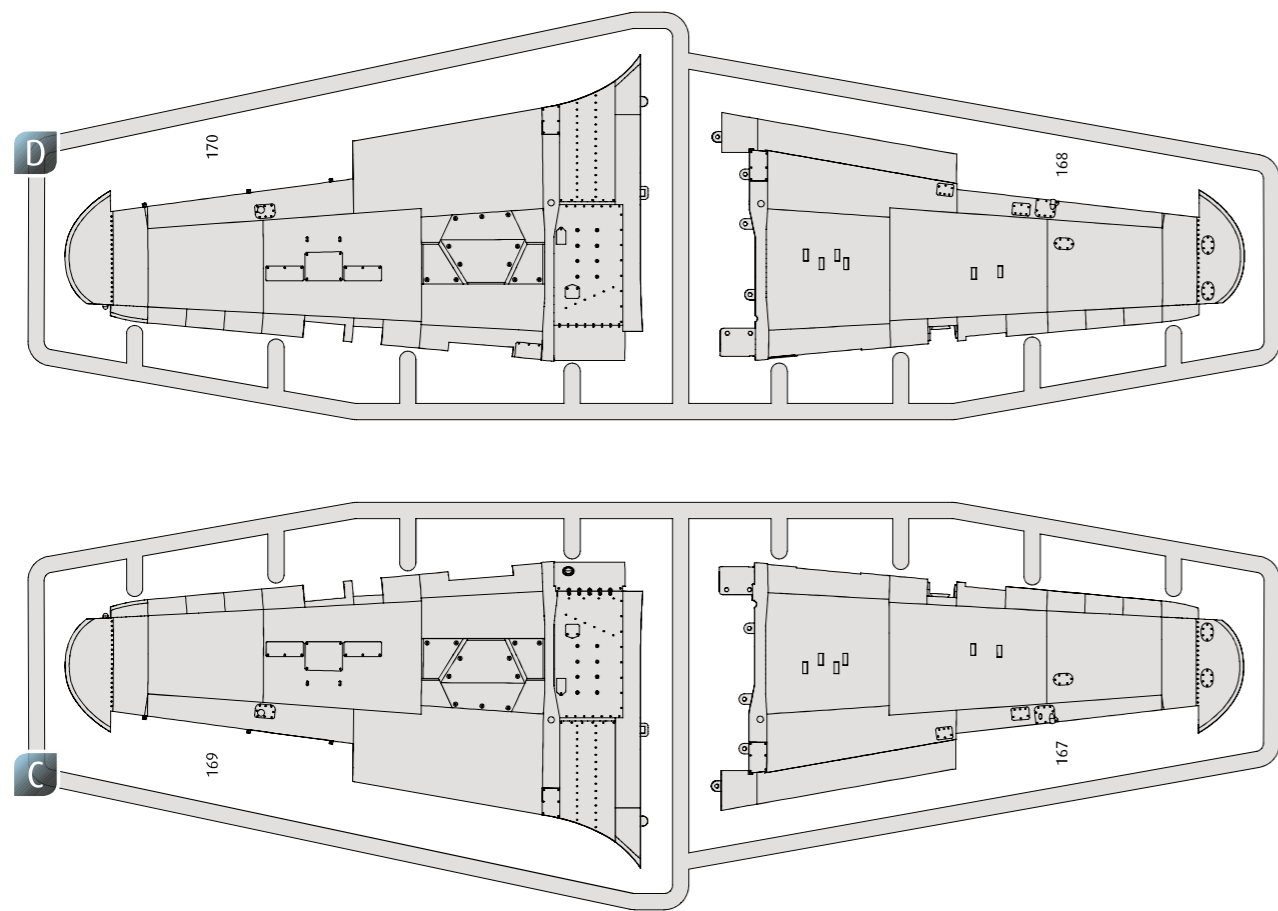
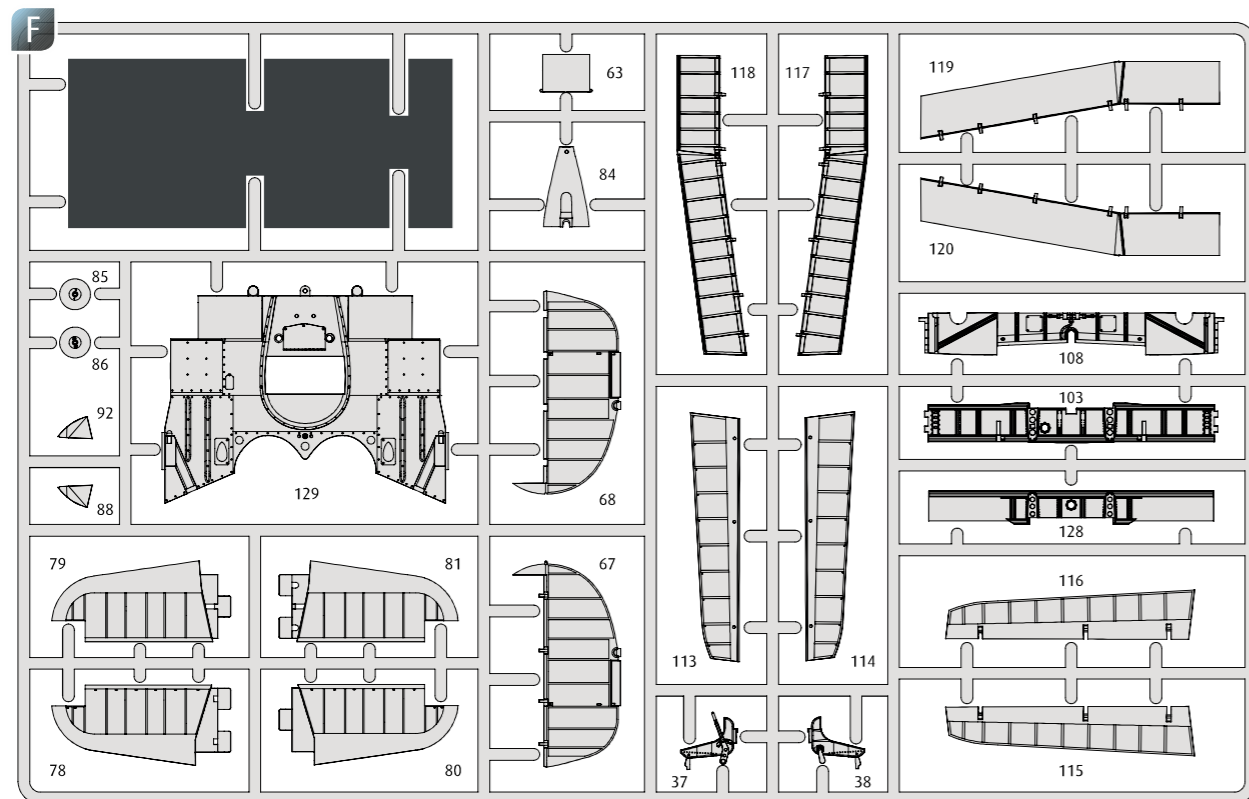
První díl se zaměřuje na používání těchto letounů našimi piloty u 310., 312. 1., 17. a 32. perutě RAF. Druhý díl mapuje službu čs. pilotů u dalších britských perutí.

Obě knihy je možné objednat v e-shopu nakladatelství Svět křidel.
www.svetkridel.cz



VYTVÓŘTE S NÁMI
**DOKONALÉ
MODELY!**

ZBRANĚ
NÁBOJOVÉ PÁSY
Z PRUŽNÉHO RESINU

www.3dfprint.eu

SEDAČKY VČETNĚ
UPÍNACÍCH PÁSŮ
A MNOHO DALŠÍHO

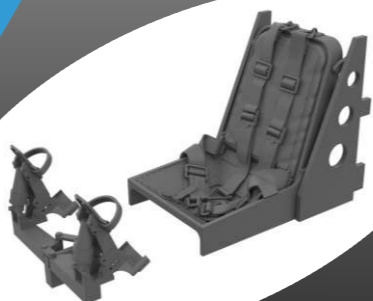

DOPLŇKY PRO

Hurricane Mk.II

1/32 Revell

3D TIŠTĚNÉ DOPLŇKY:

- 632190 Hurricane Mk.II kola
- 632209 Hurricane Mk.II dvířka kokpitu
- 634033 Hurricane Mk.IIb Lök

FOTOLEPTANÉ SADY:

- 32481 Hurricane Mk.IIb vztlačové klapky
- 321006 Hurricane Mk.IIb (exteriér a interiér)
- 33343 Hurricane Mk.IIb (interiér)
- 33344 Hurricane Mk.IIb upínací pásy STEEL

MASKY:

- JX305 Hurricane Mk.IIb
- JX306 Hurricane Mk.IIb TFace

SPACE (3D tištěný obtisk):

- 3DL32012 Hurricane Mk.IIb

BIG ED (velká fotoleptaná sada):

- BIG33151 Hurricane Mk.IIb



www.eduard.cz

Vyzkoušejte novinku!

WHEELBAY PLUGS

Doplňěk, který
urychlí stavbu
vašeho modelu!



www.omask.cz

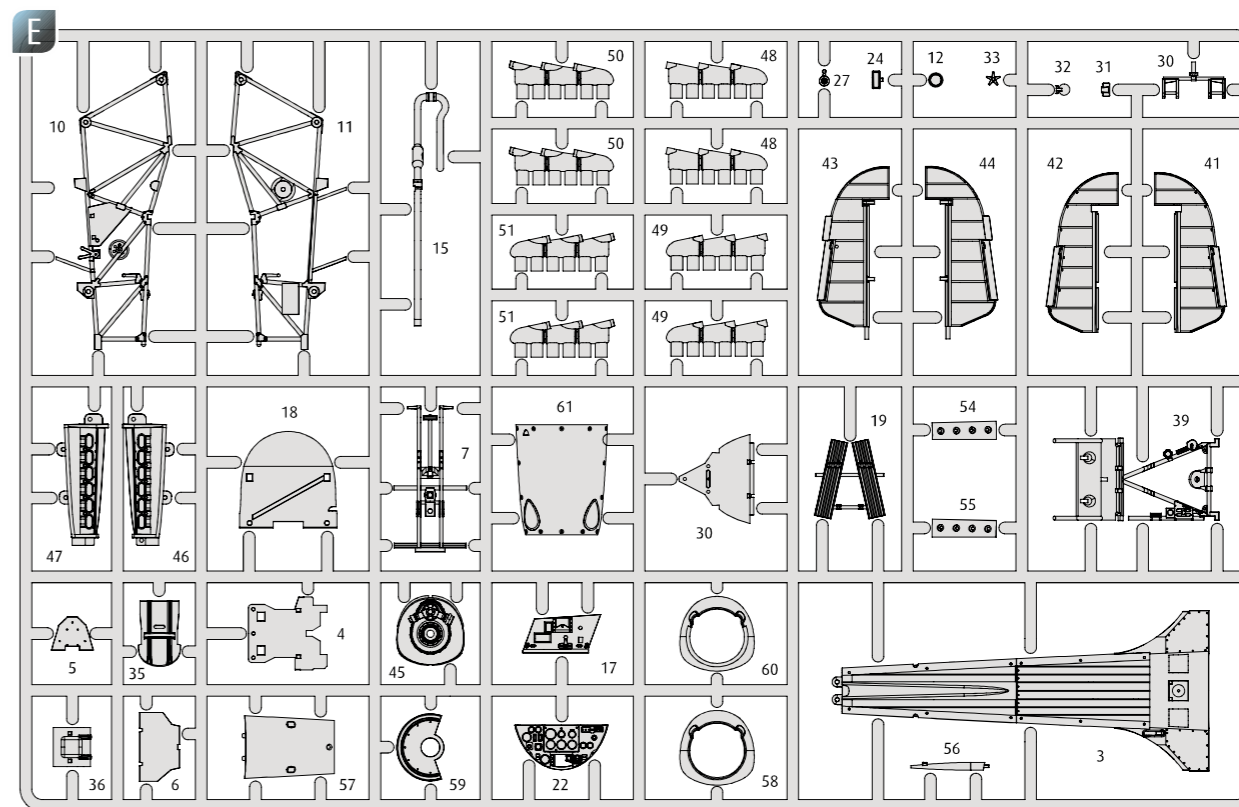
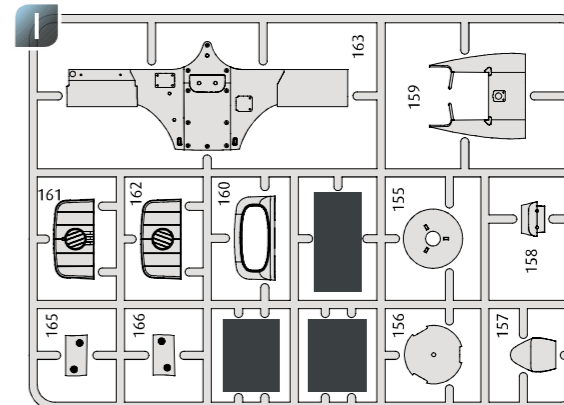
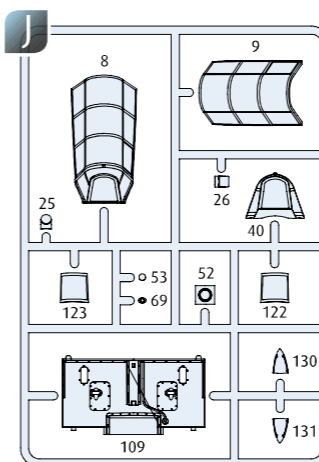
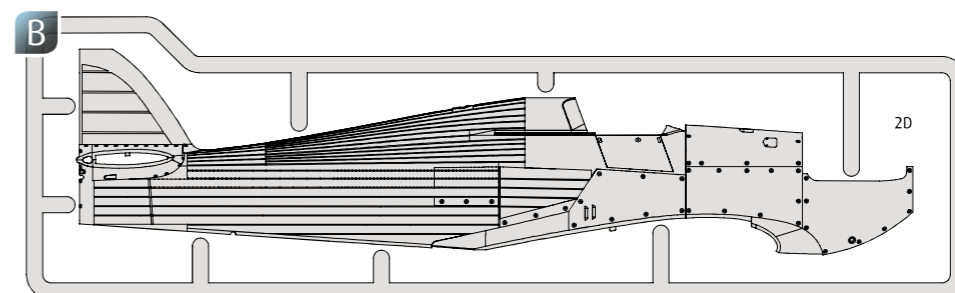
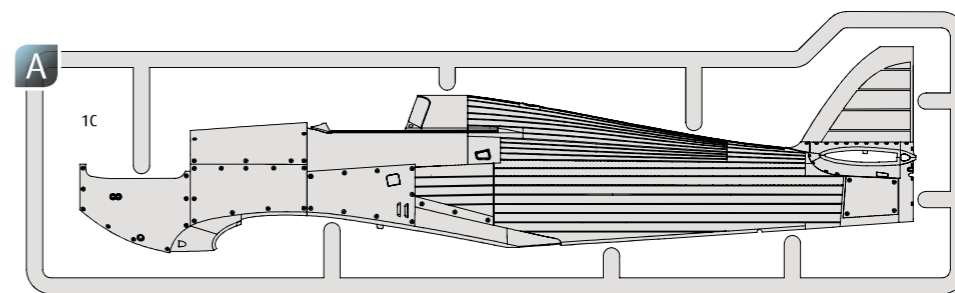

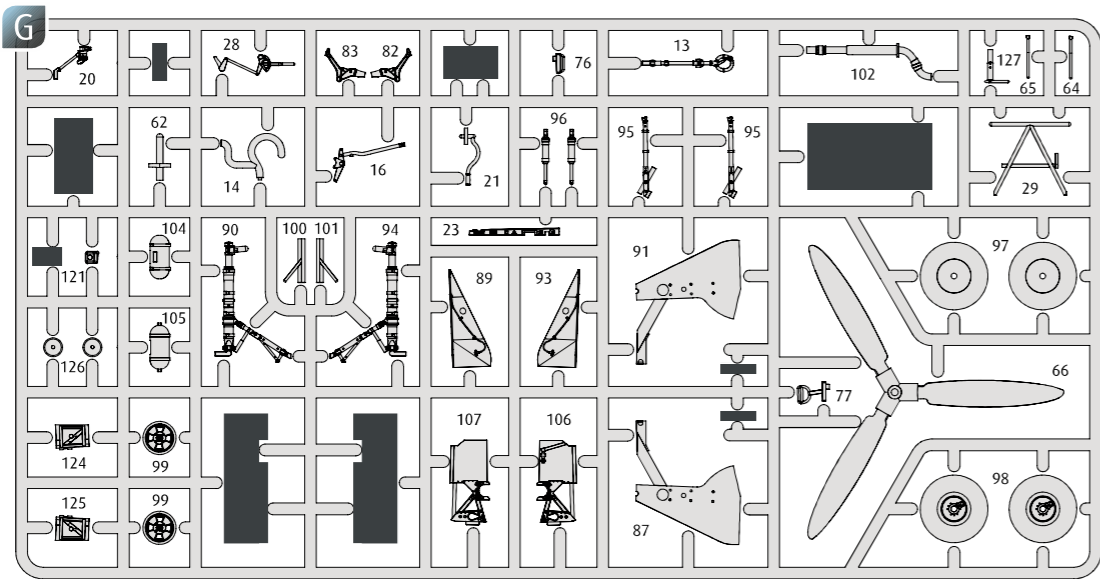

82

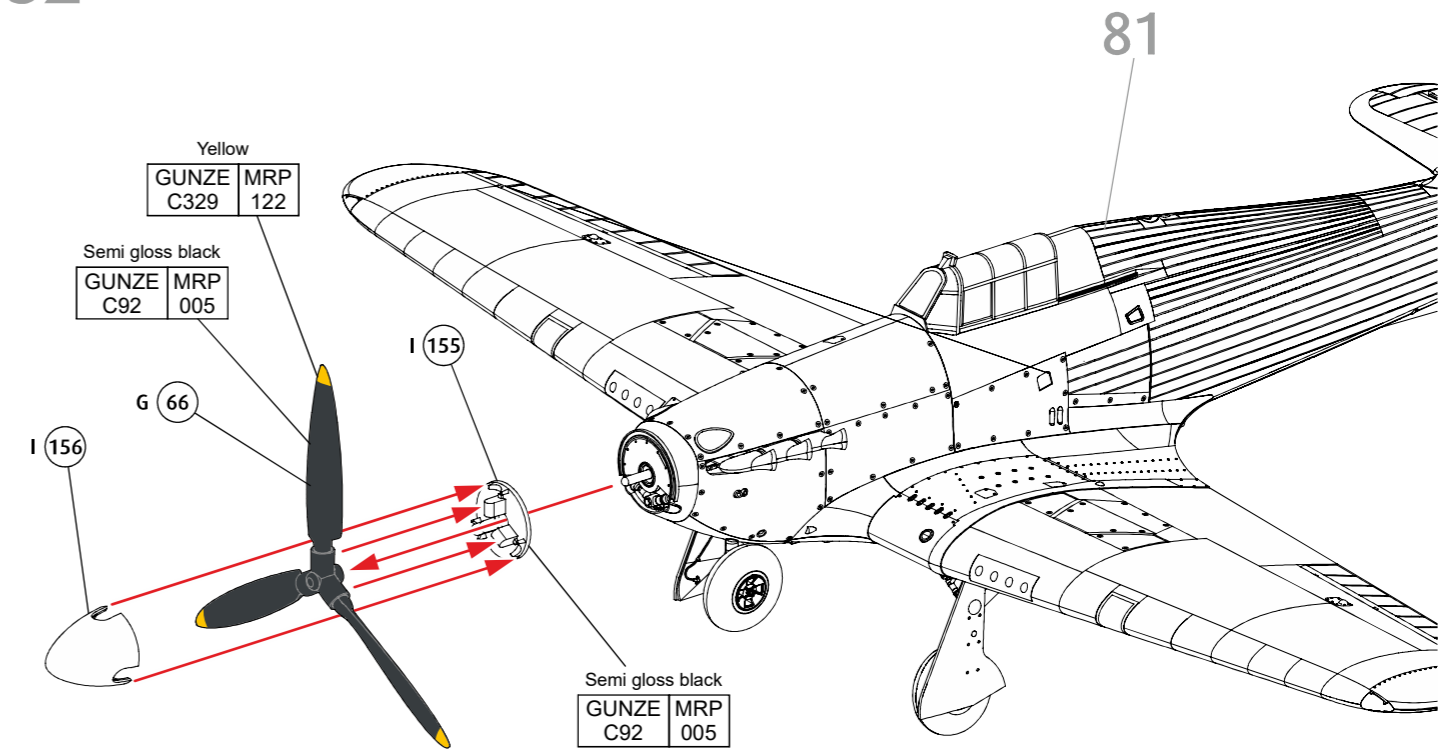

3D printed parts - 3DF
use cyanoacrylate glue

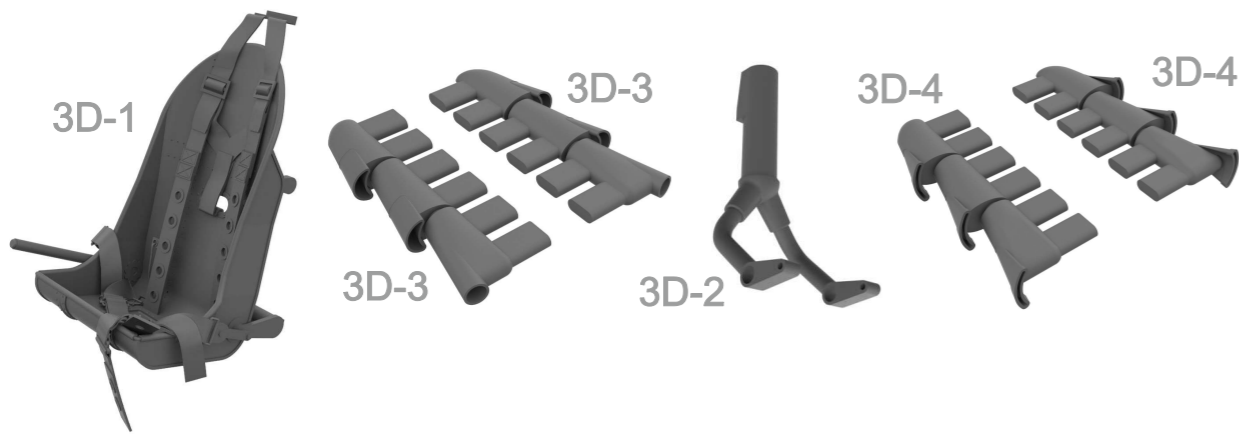

83

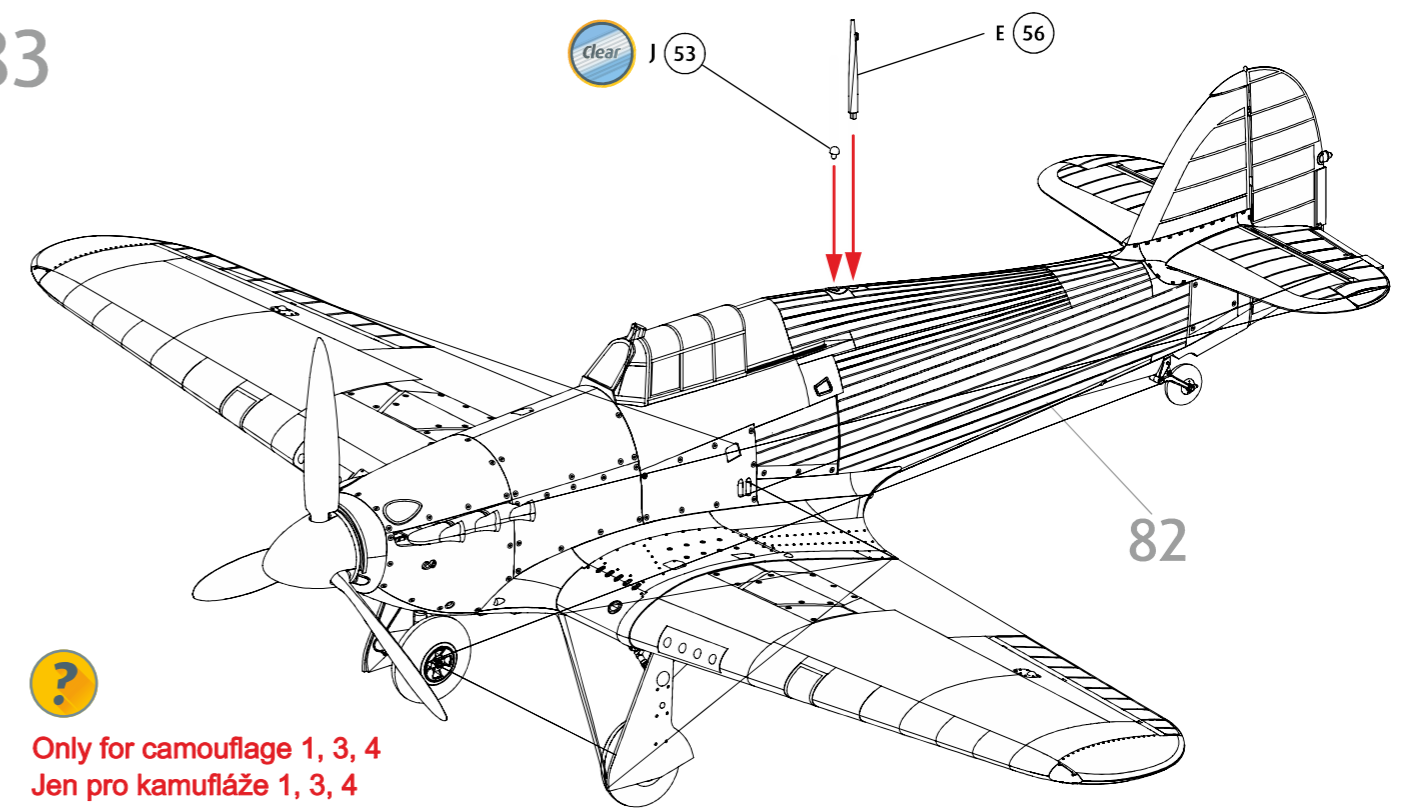

Masks for clear parts - Omask

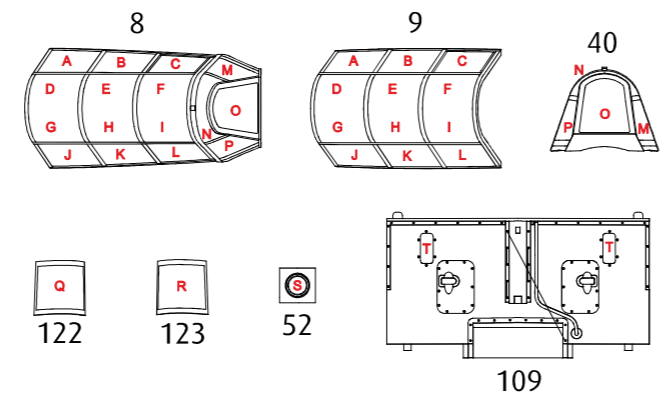
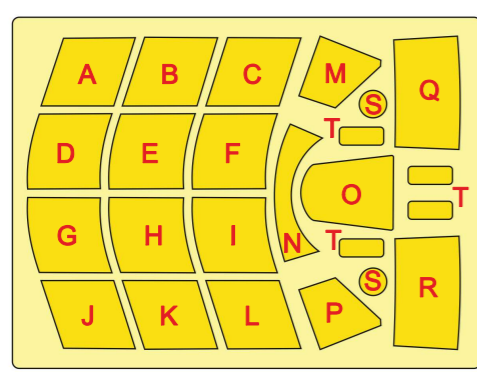

Only for camouflage 1, 3, 4
Jen pro kamufláže 1, 3, 4

Make exhaust flame screens - 2 pcs
4 x 11 mm, thin plastic plate 0,2 mm
Vyřežte z tenké plastové destičky tloušťky 0,2 mm dva kusy stínítek výfuků velikosti 4 x 11 mm

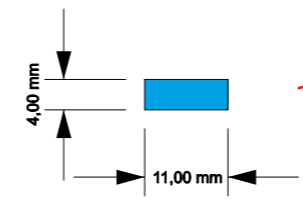

Glue symmetrically on both sides
Přilepte symetricky na obě strany

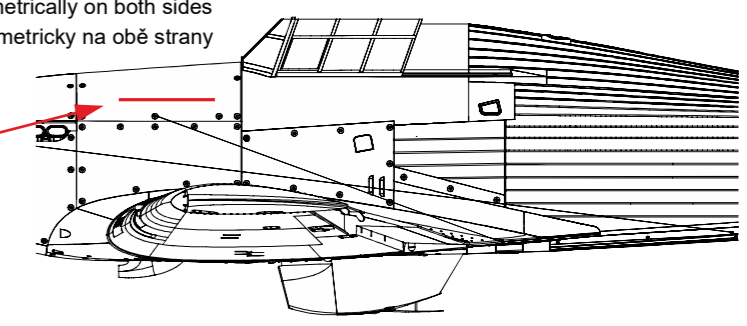

Foam wheelbay plugs - Omask

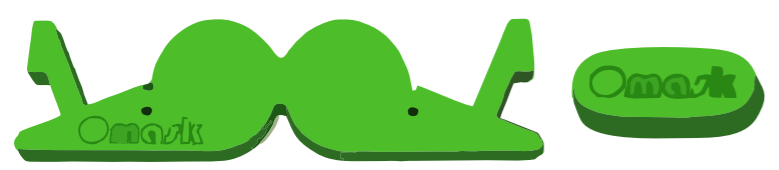

remove temporarily attached canopy

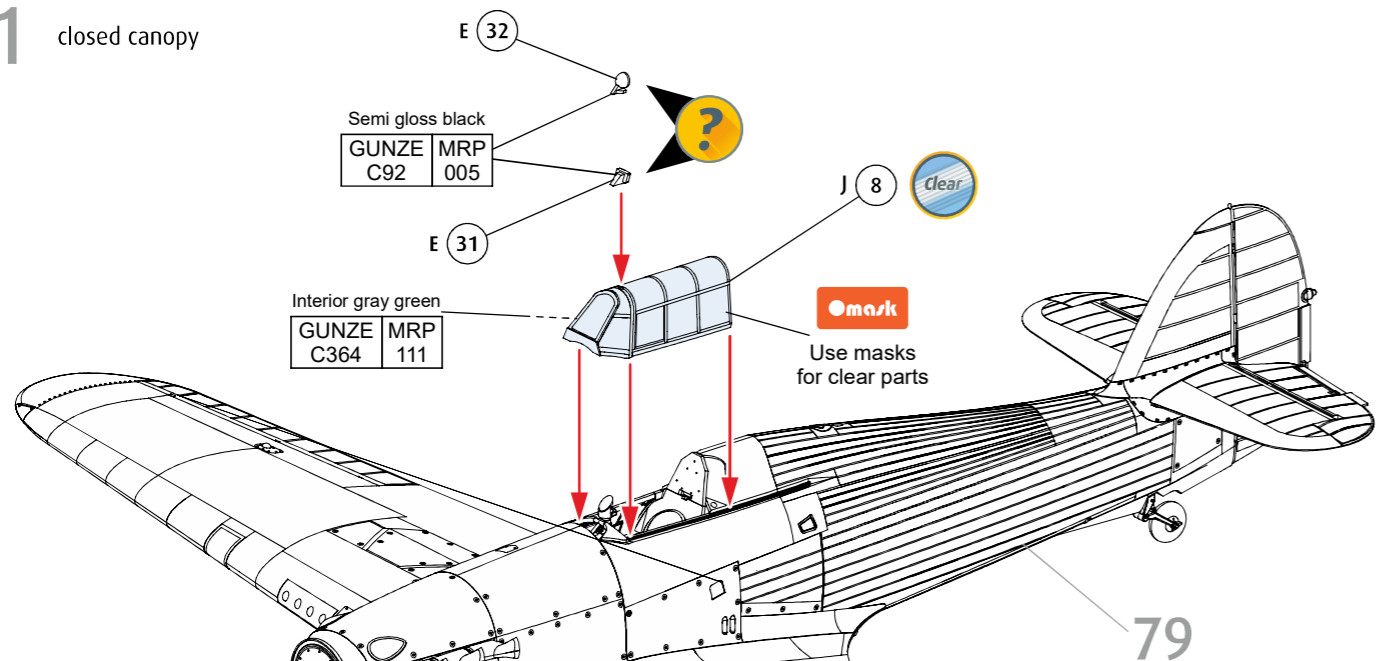
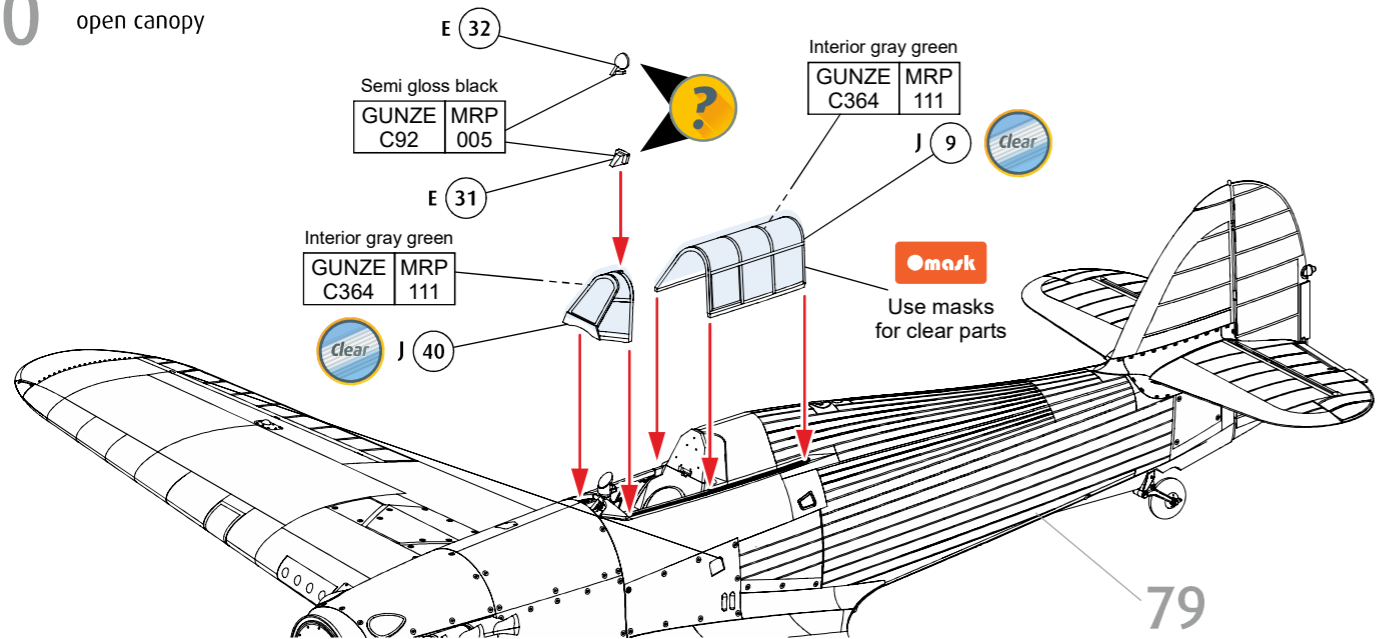
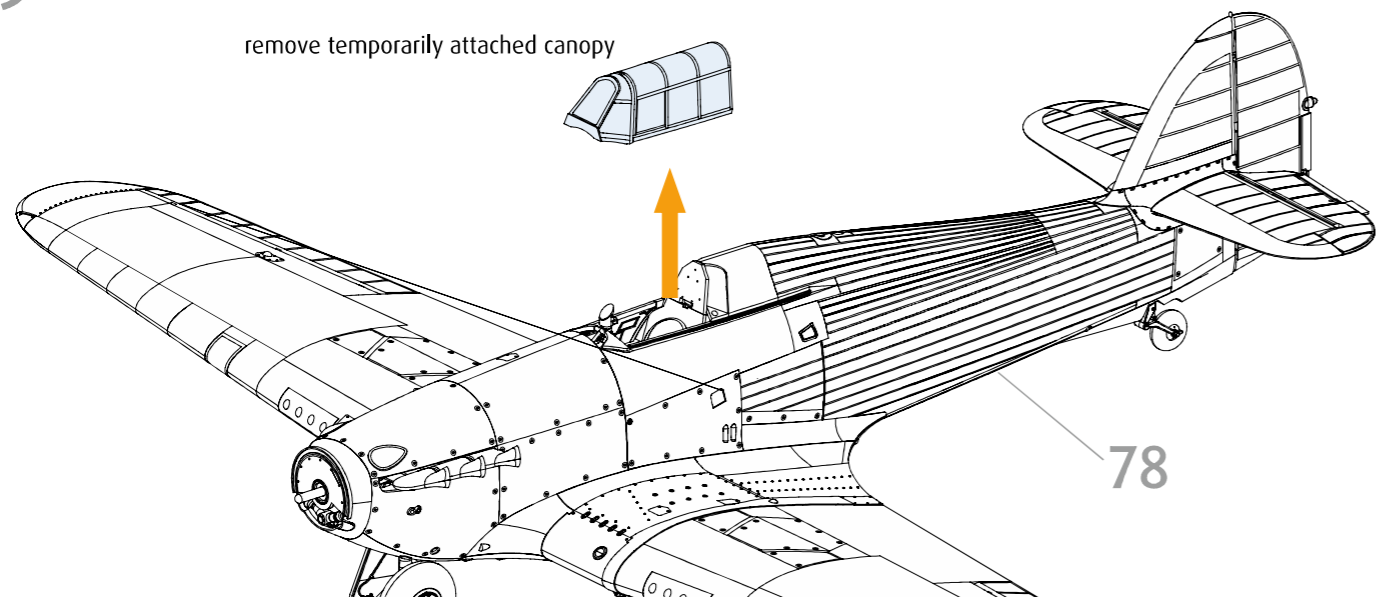

make plastic seat only if you do not use 3D print

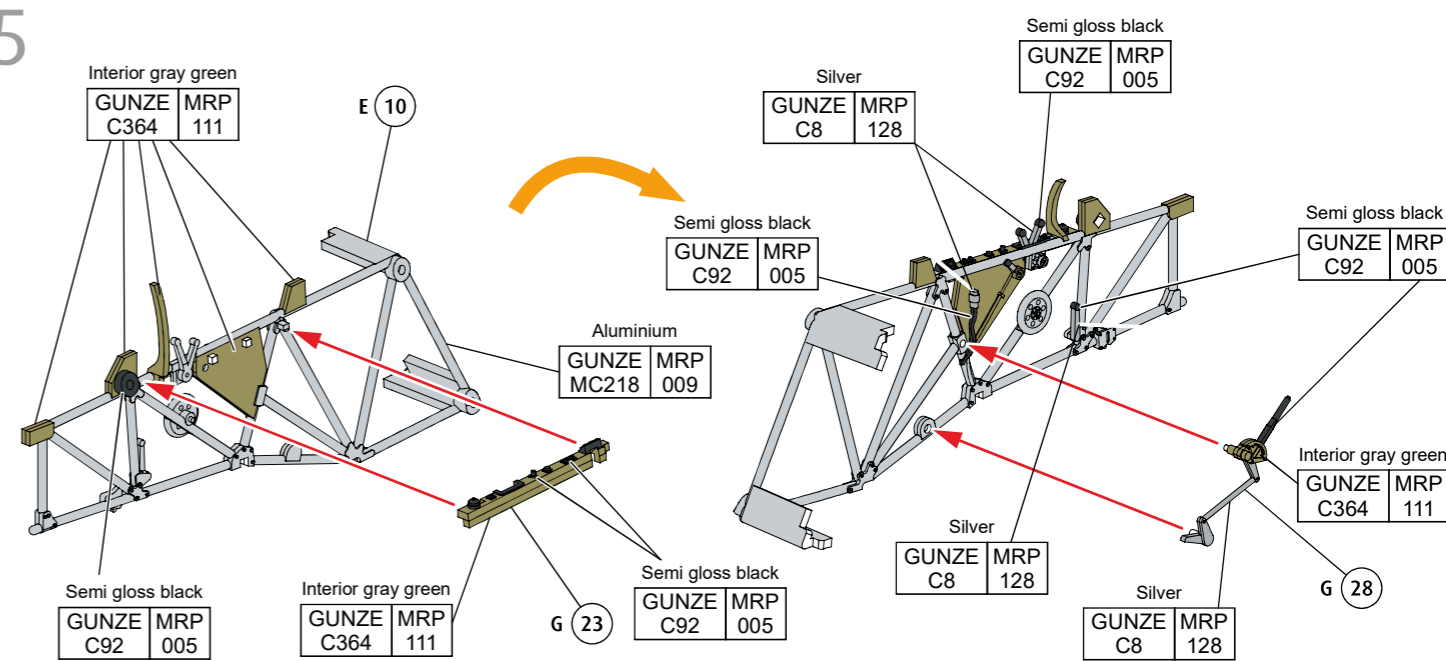
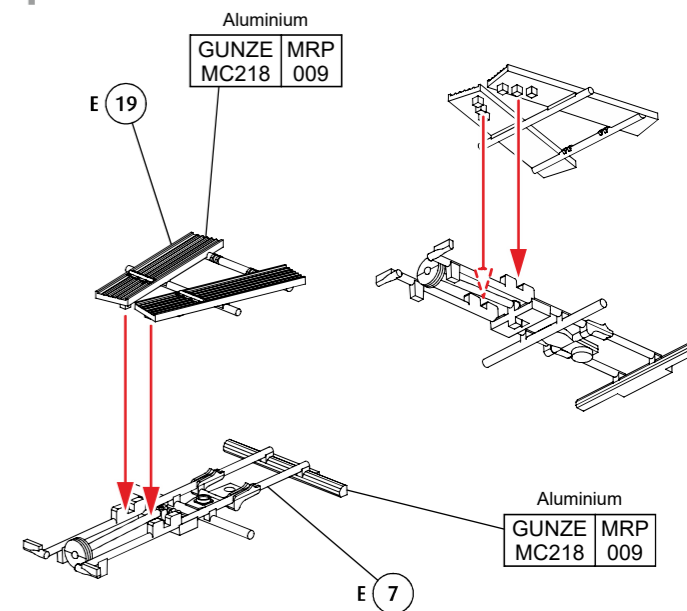
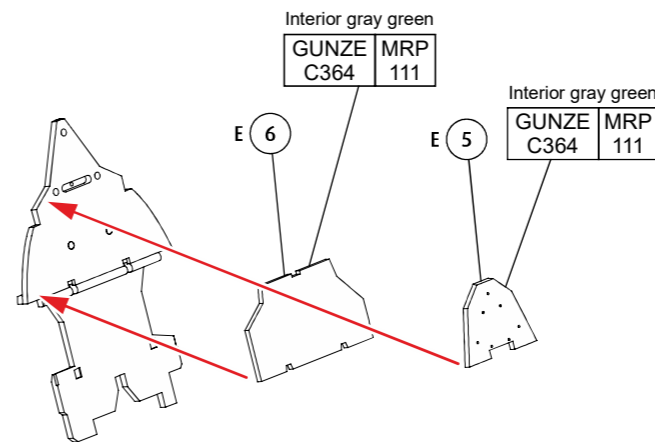
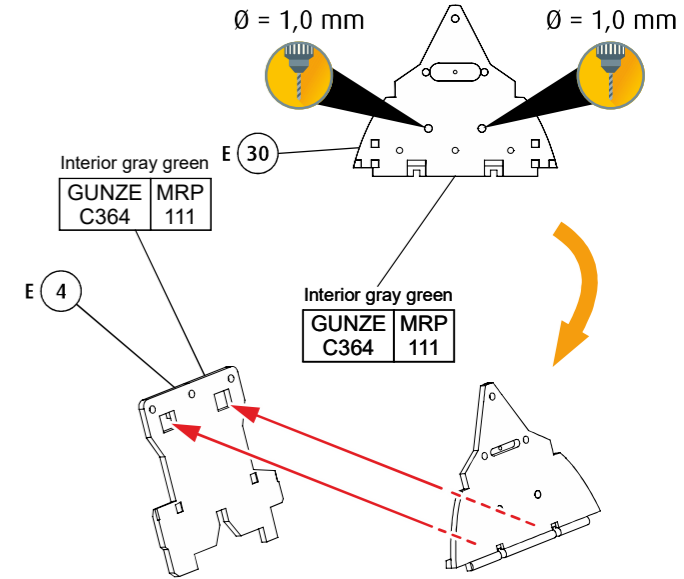
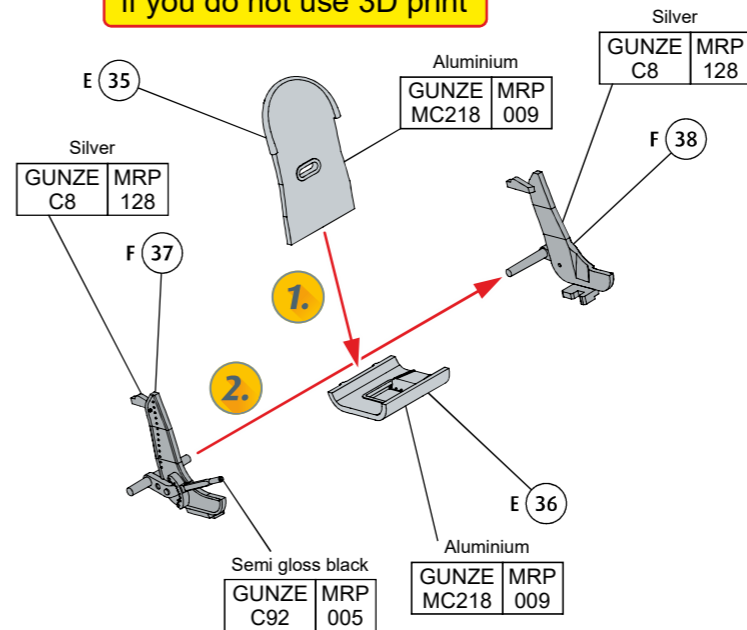

6

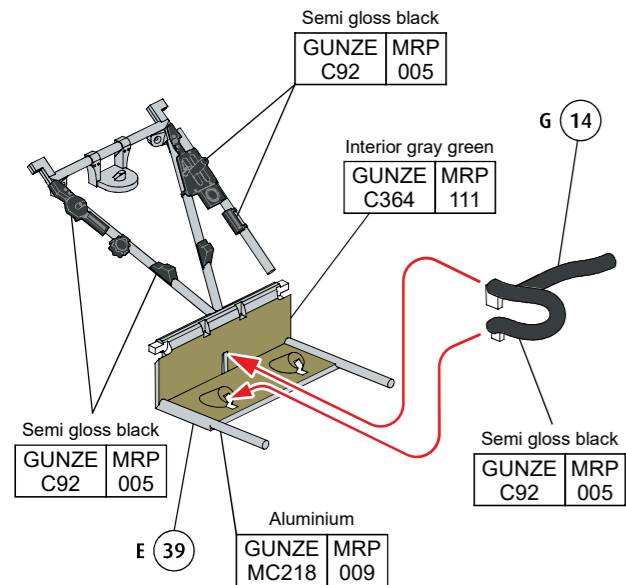

7

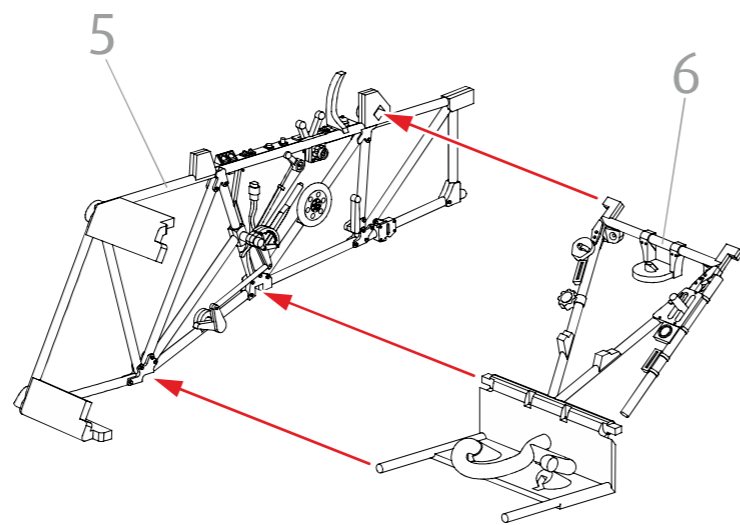

8

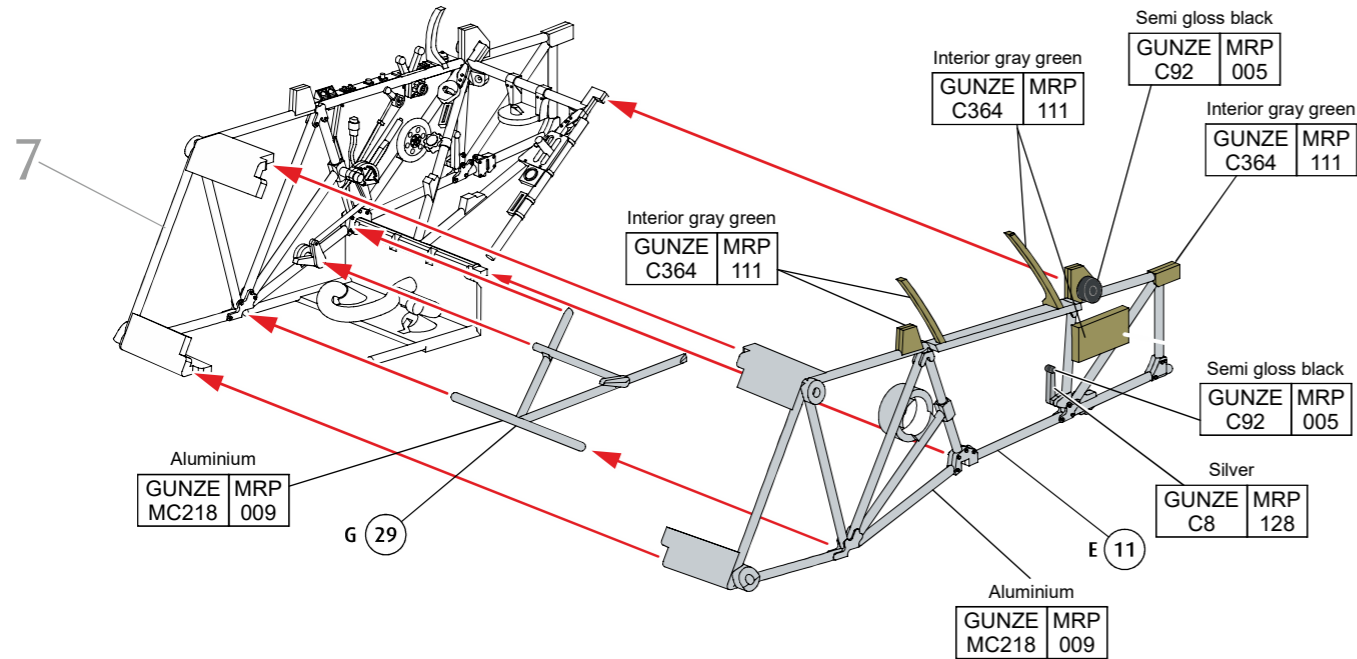

9

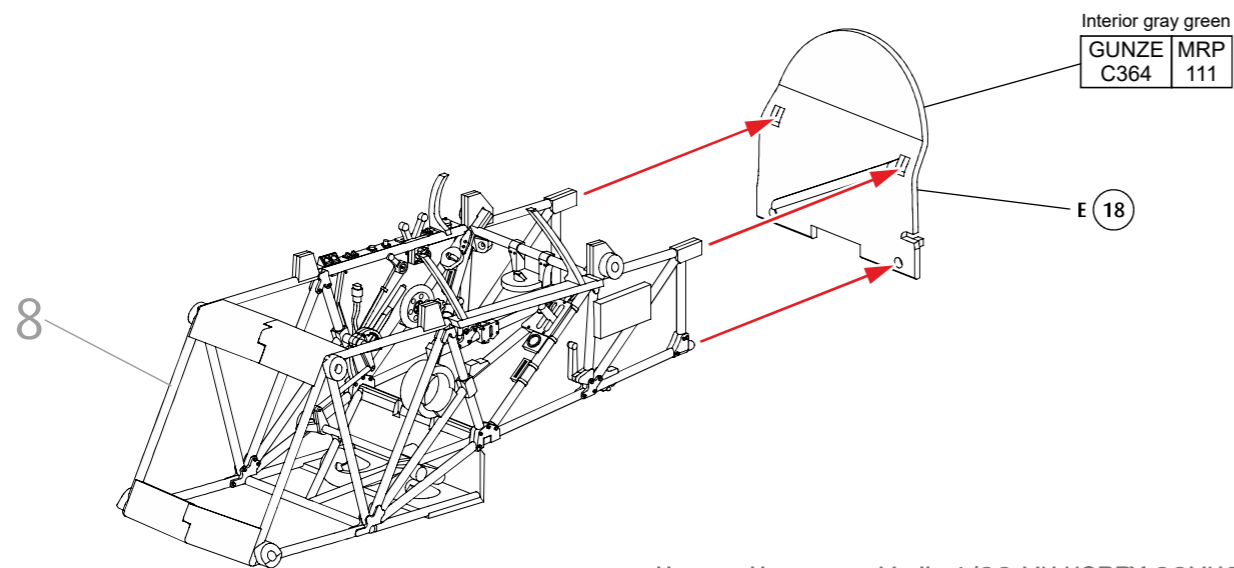

75

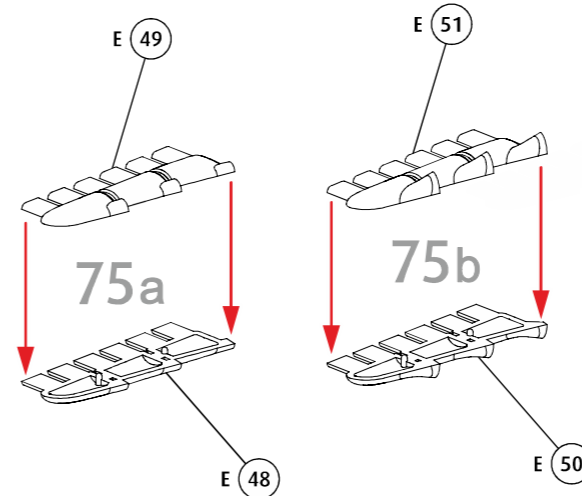

76

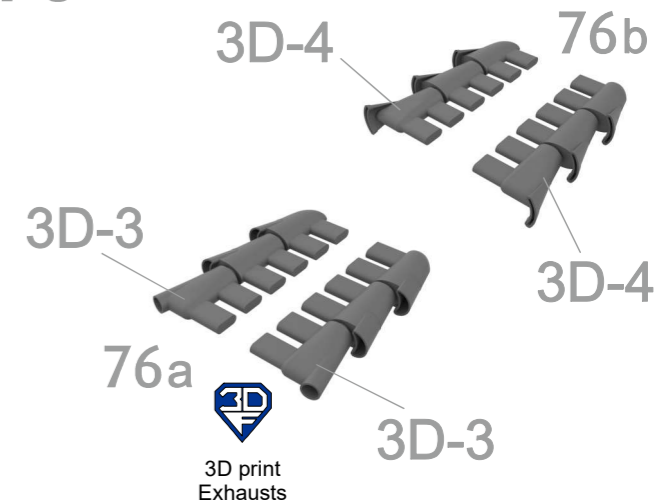

77

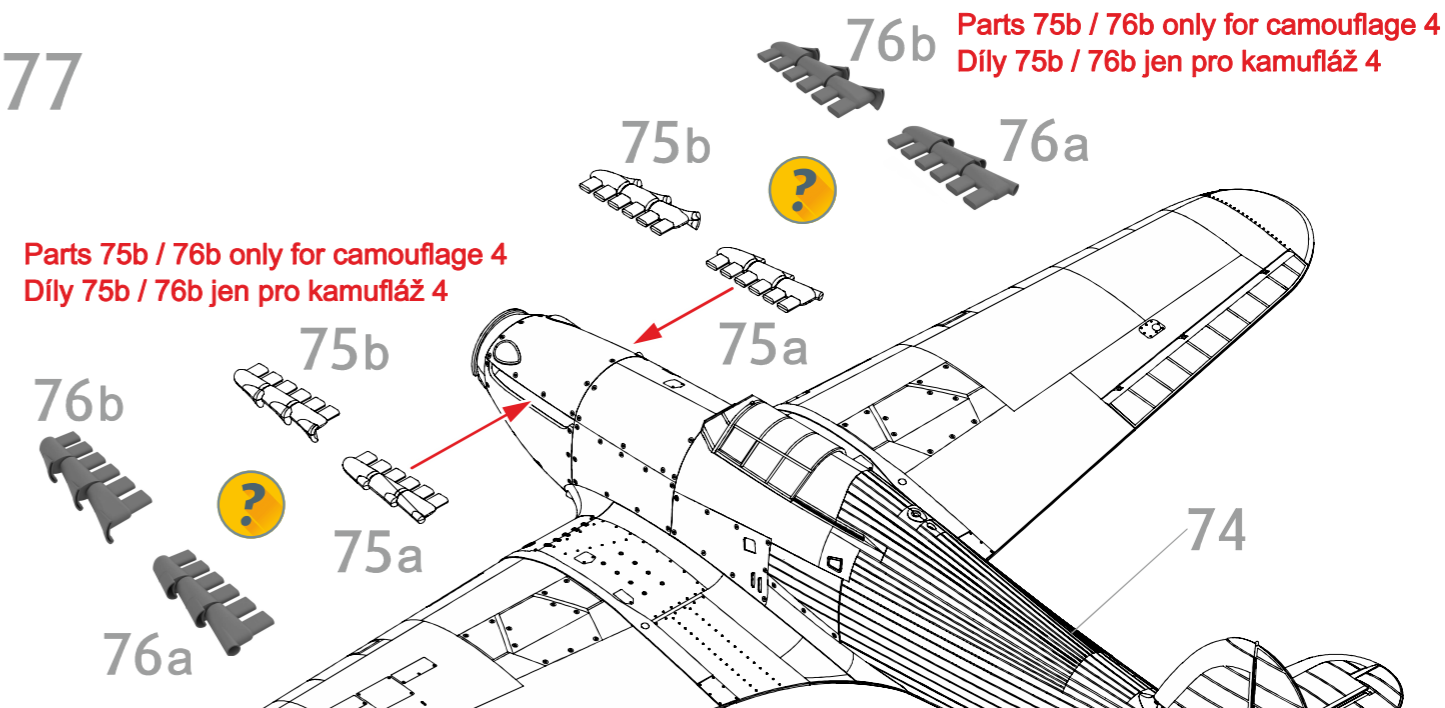

78

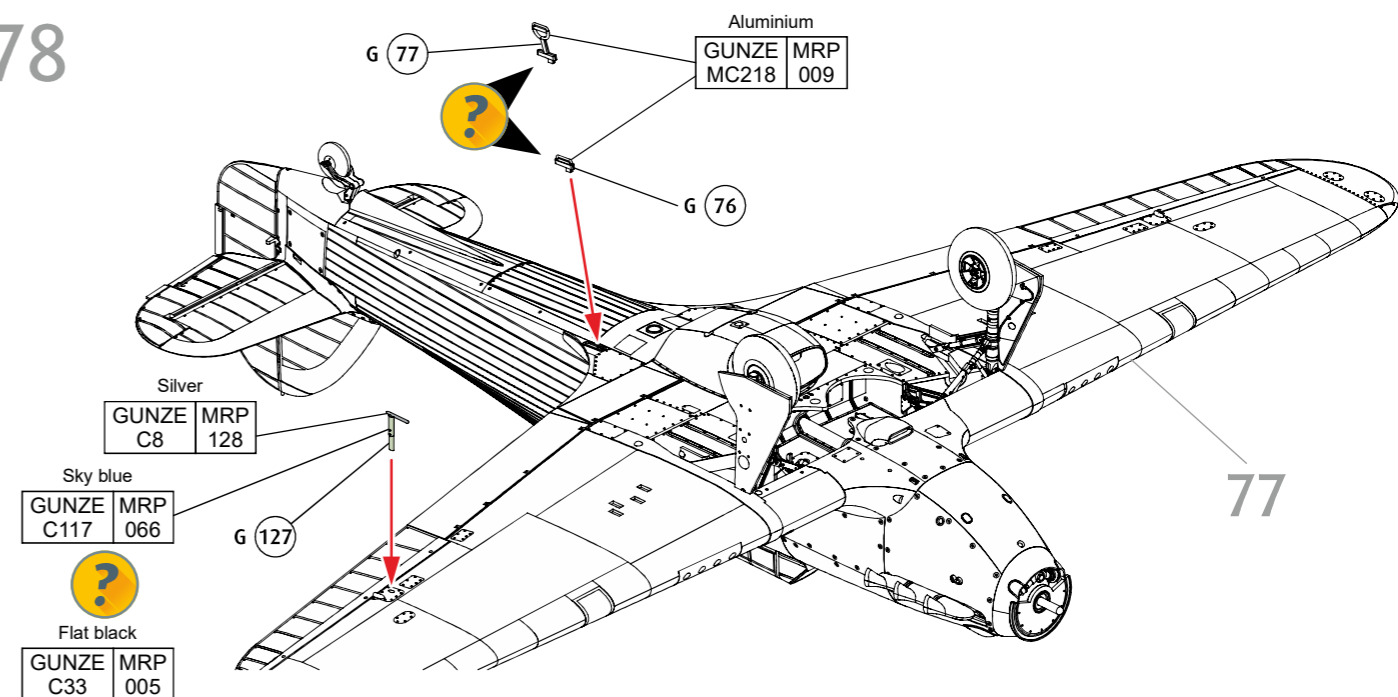

73

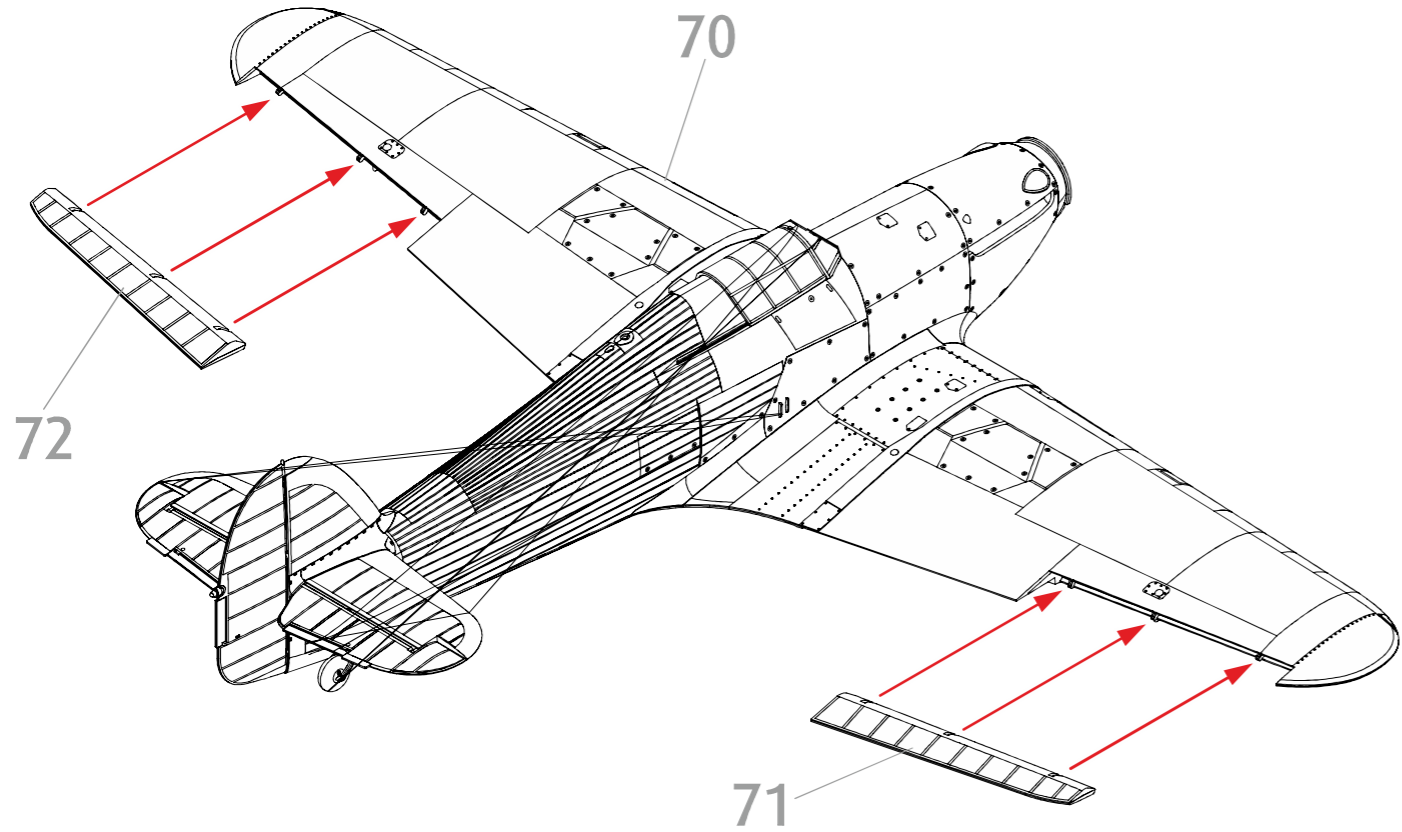

74

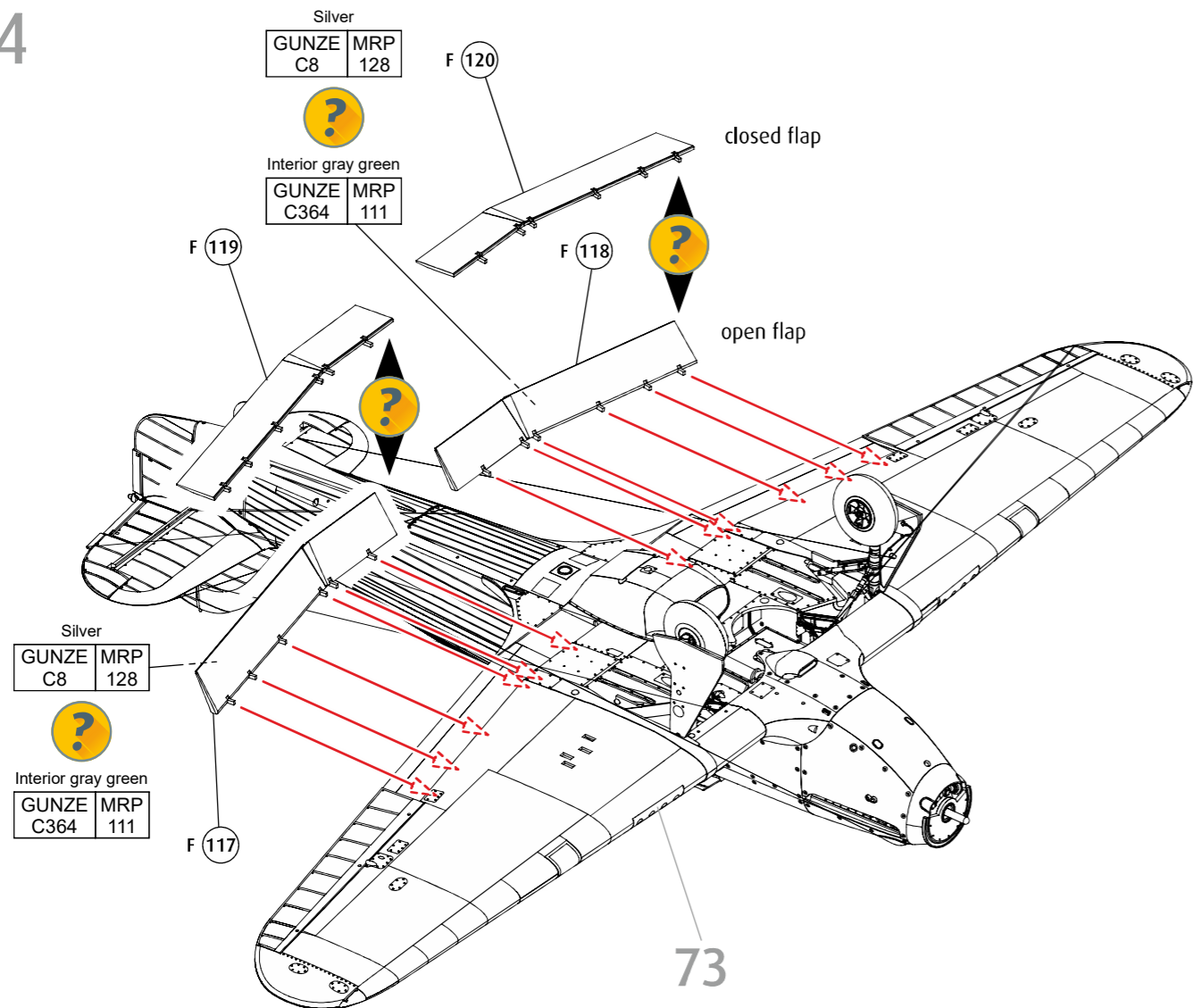

10

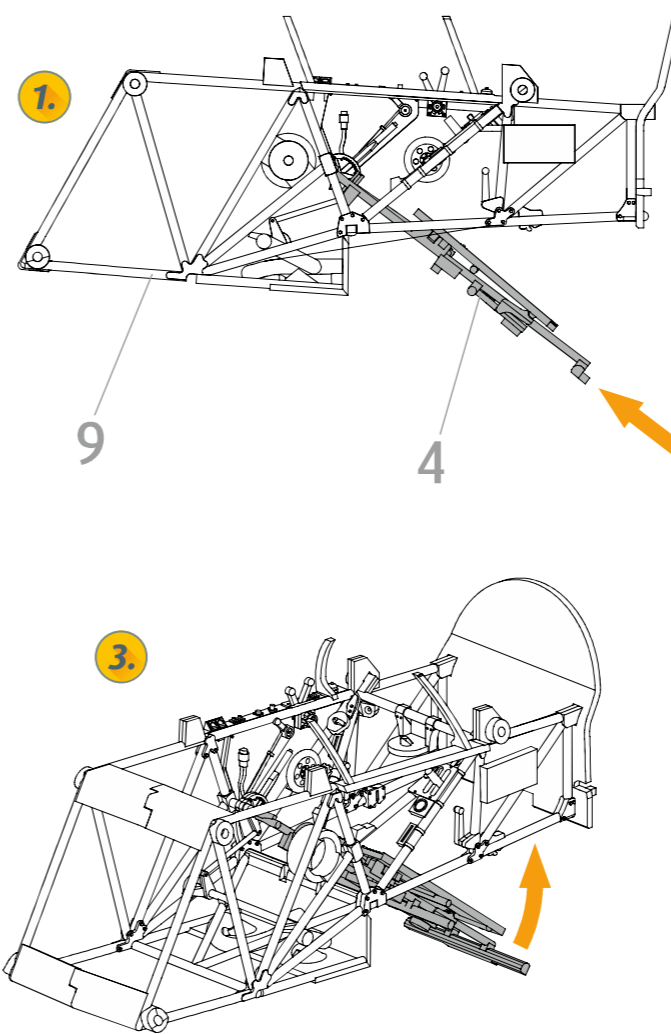

11

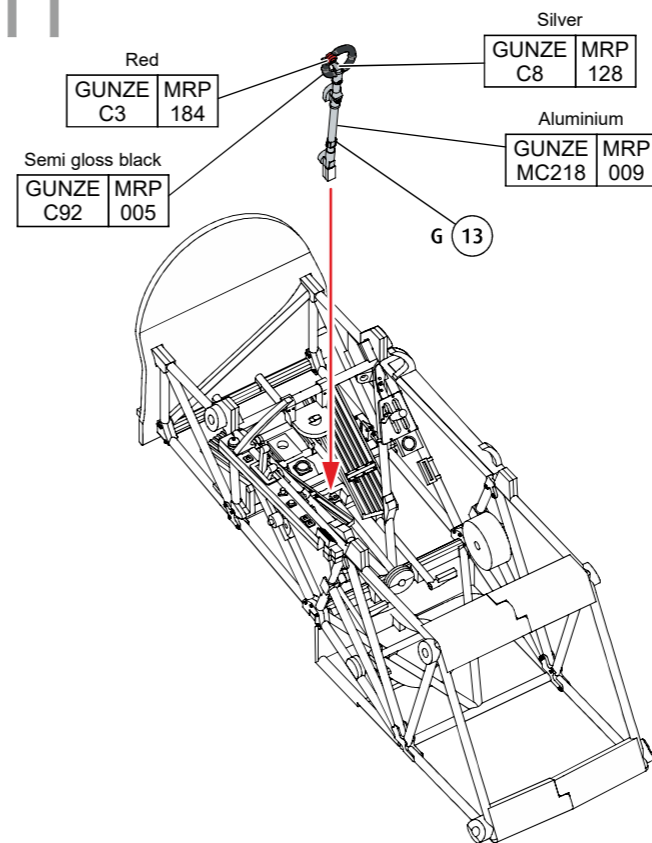

12

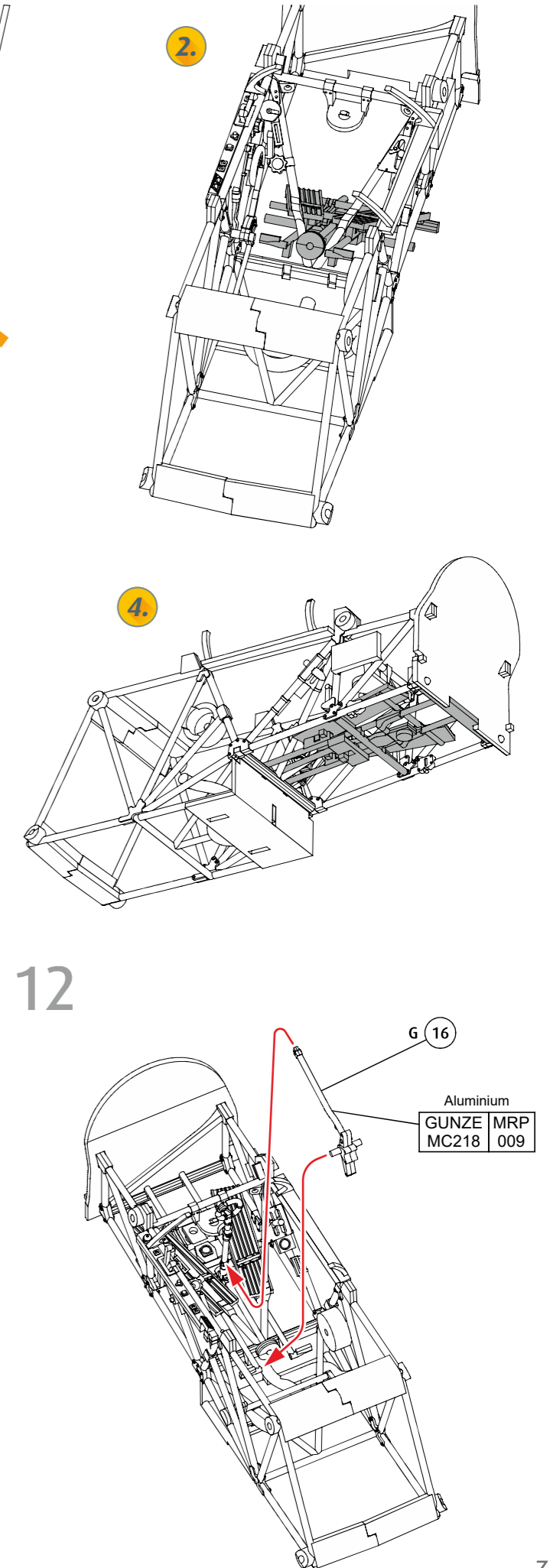

13

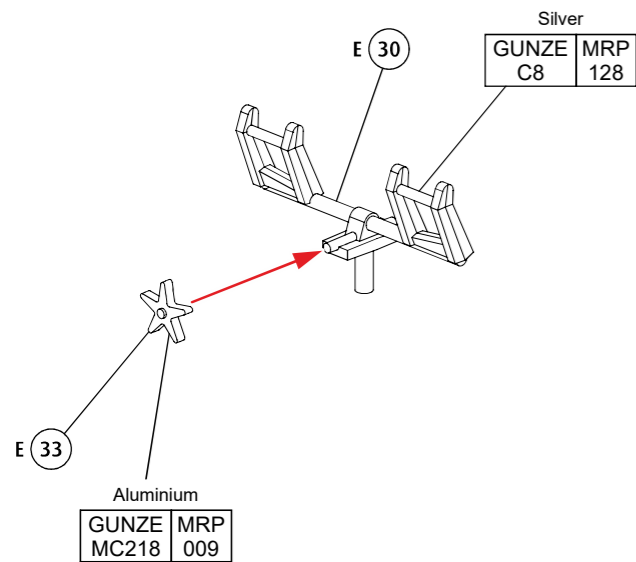

14

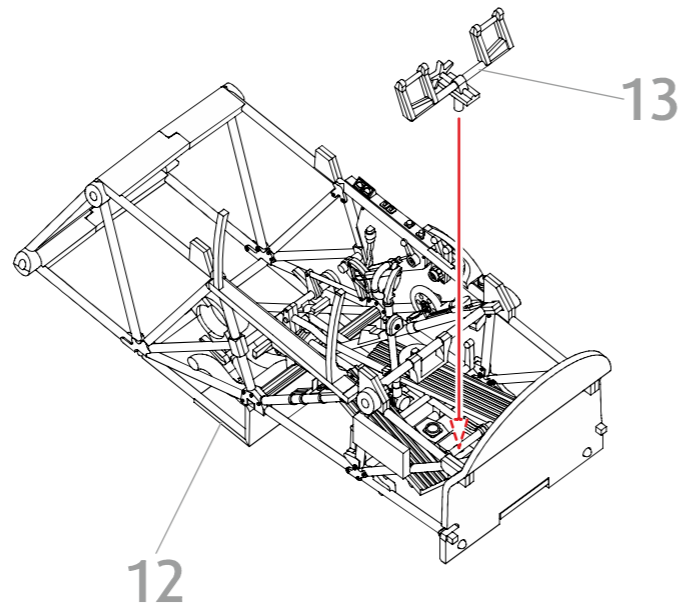

15

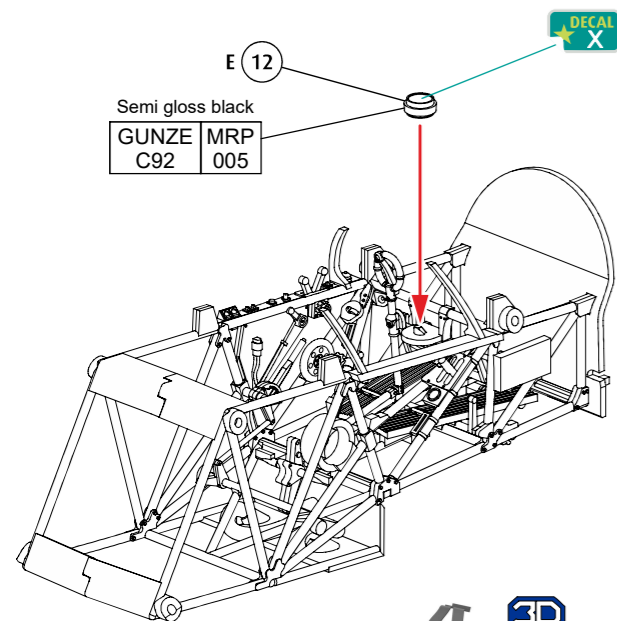

16

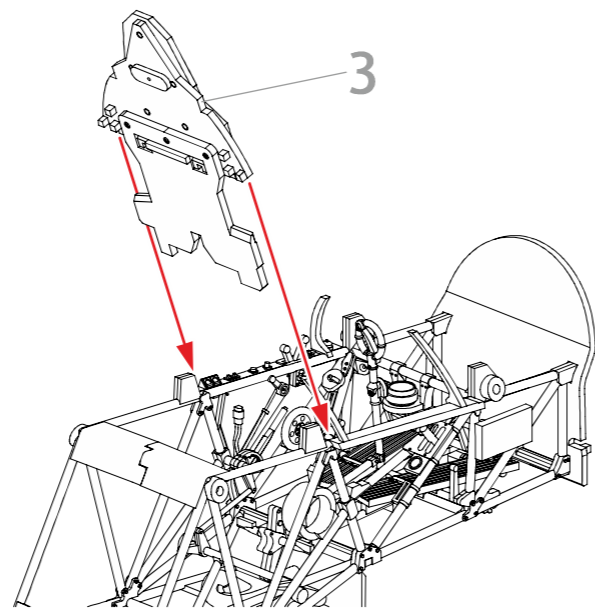

17

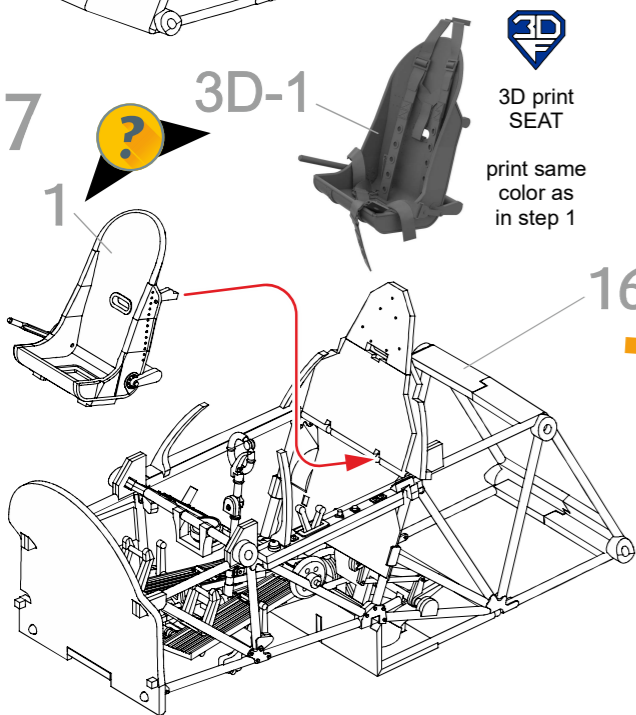

HAWKER HURRICANE Mk.IIA 1/32 MN-HOBBY 32MN001

69

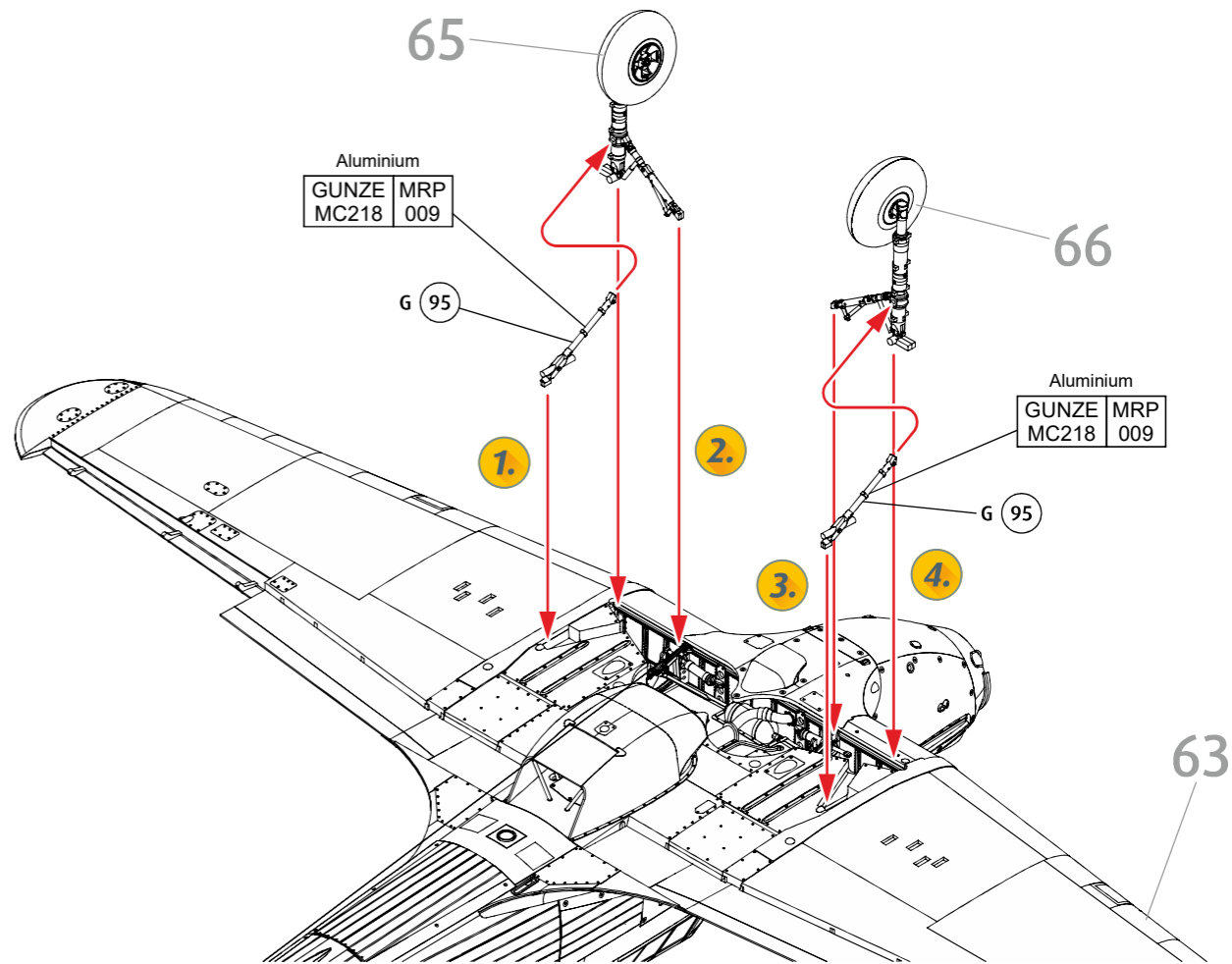

70

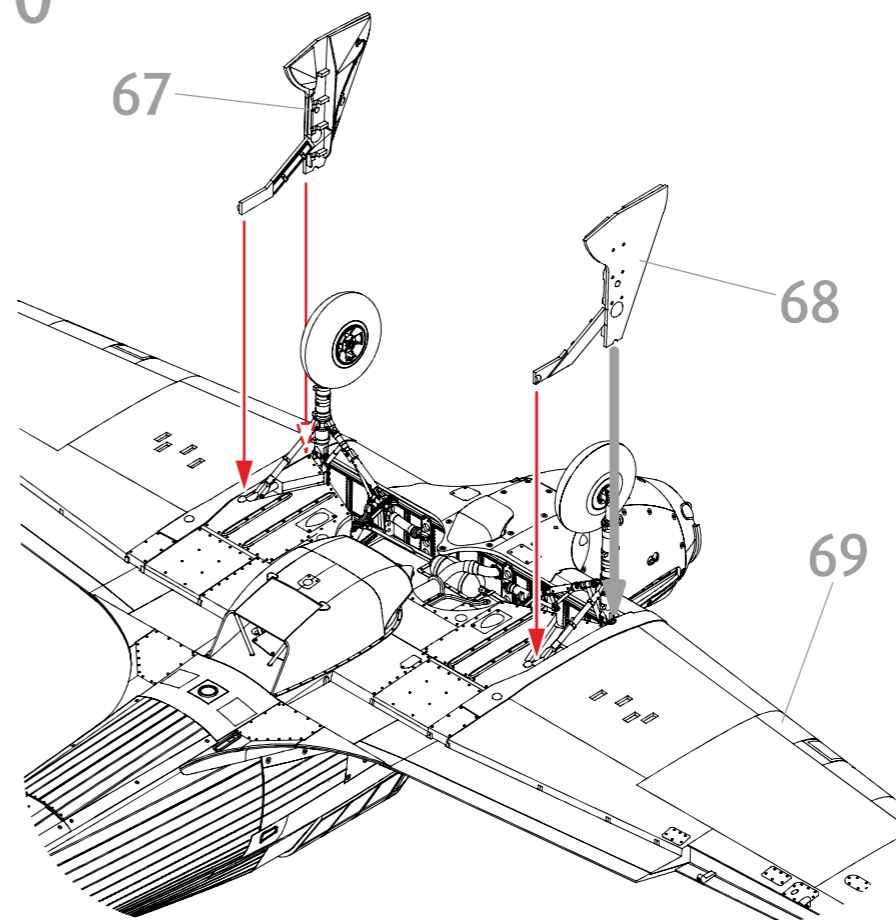

71

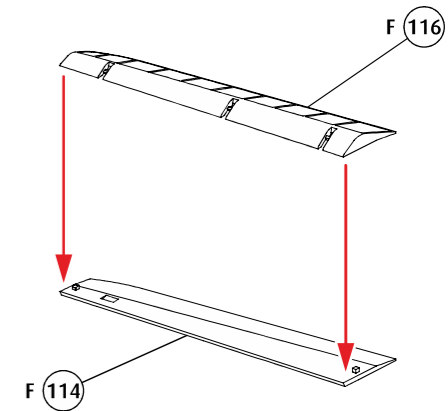

72

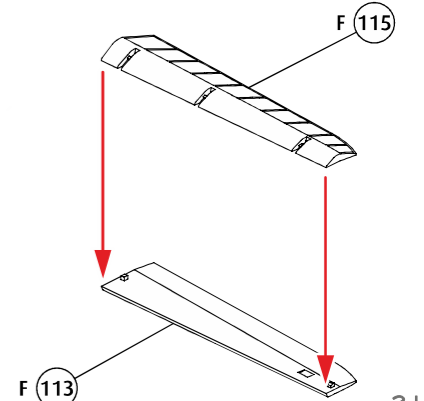

HAWKER HURRICANE Mk.IIA 1/32 MN-HOBBY 32MN001

60

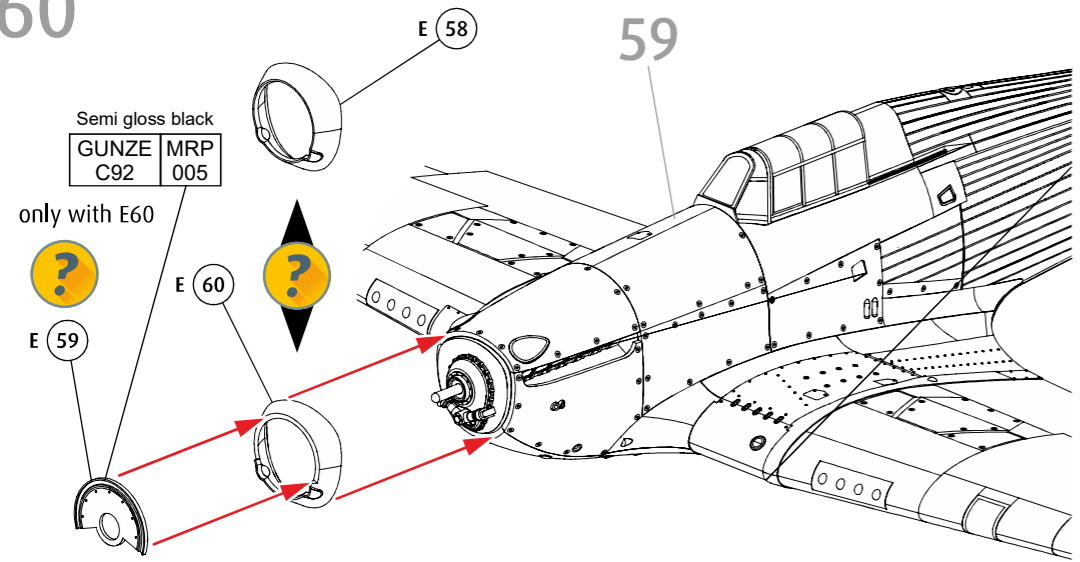

61

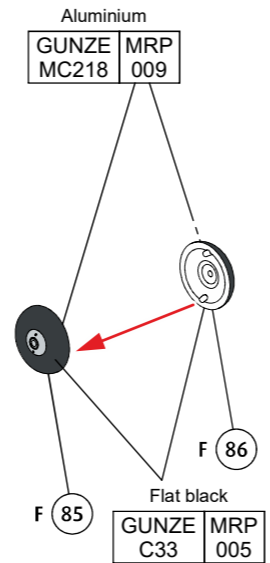

18

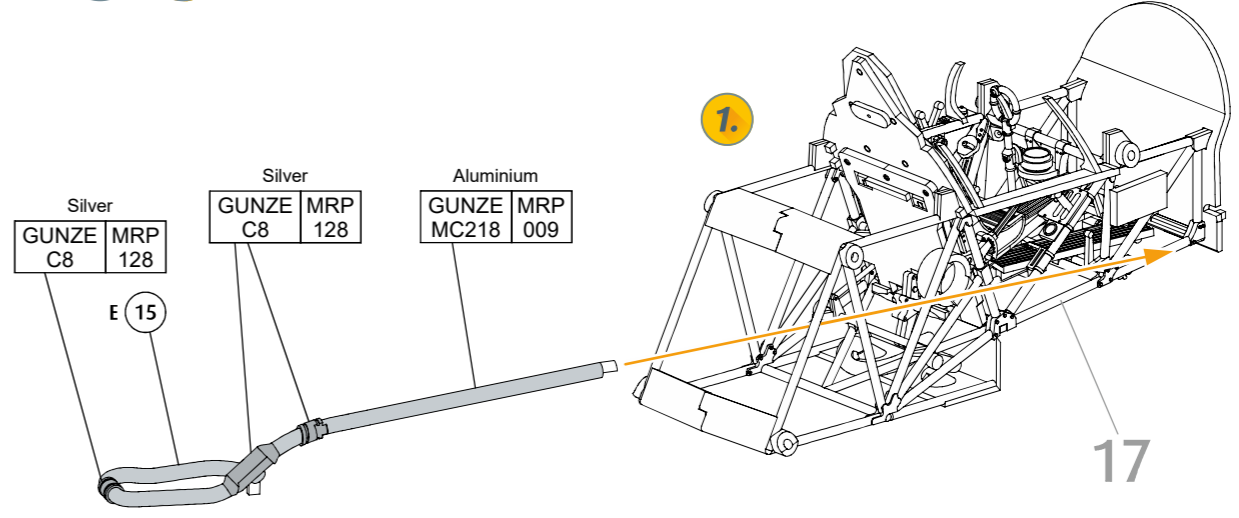

3D print 3D-2

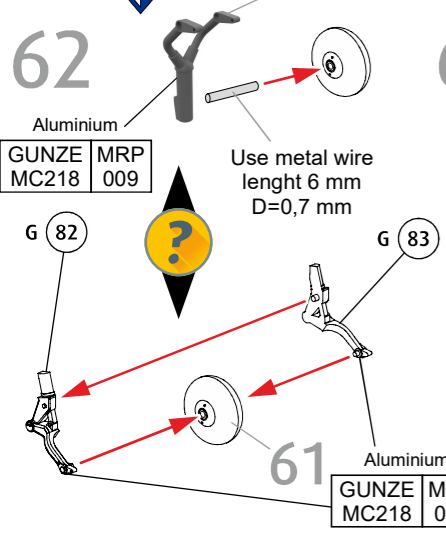

63

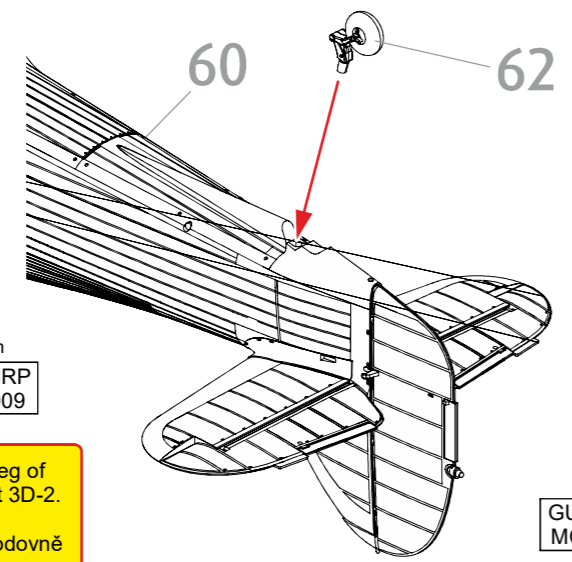

64

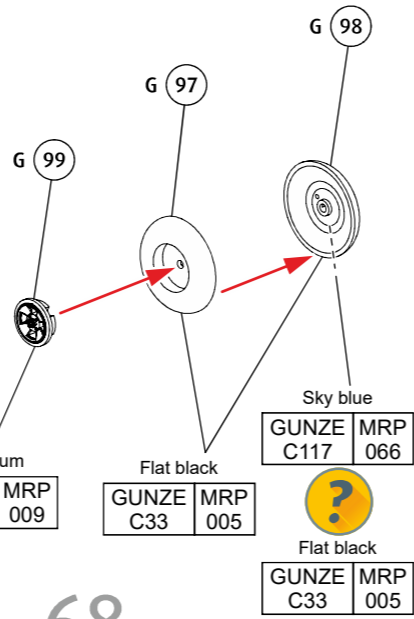

2.

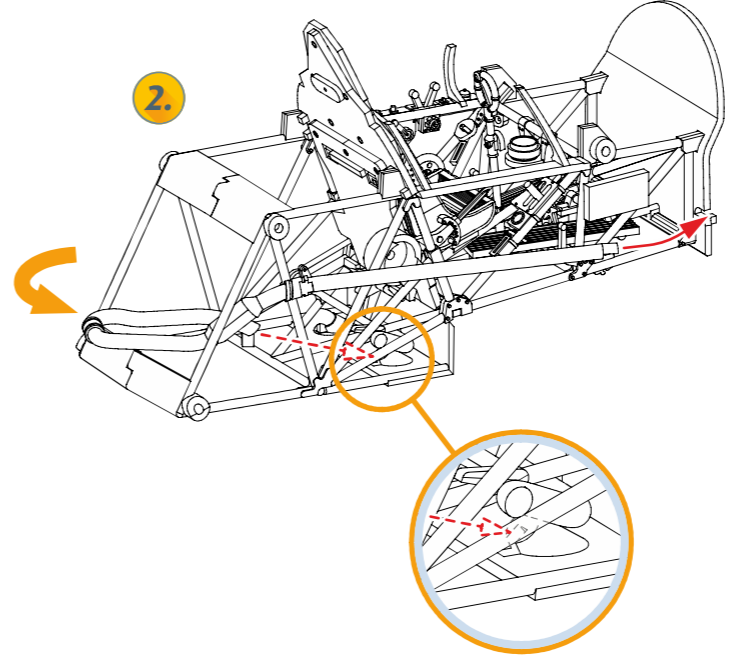

3.

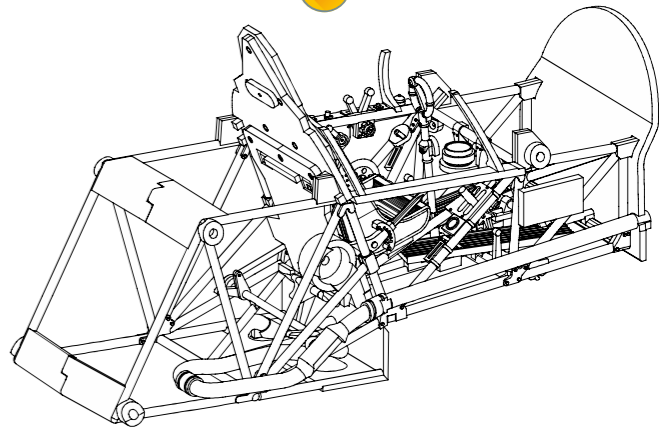

All aircraft in the kit probably had a tail leg of early design. We recommend using part 3D-2.

Všechny letouny ve stavebnici pravděpodobně měly ostruhovou nohu časně konstrukce. Doporučujeme použít díl 3D-2

19

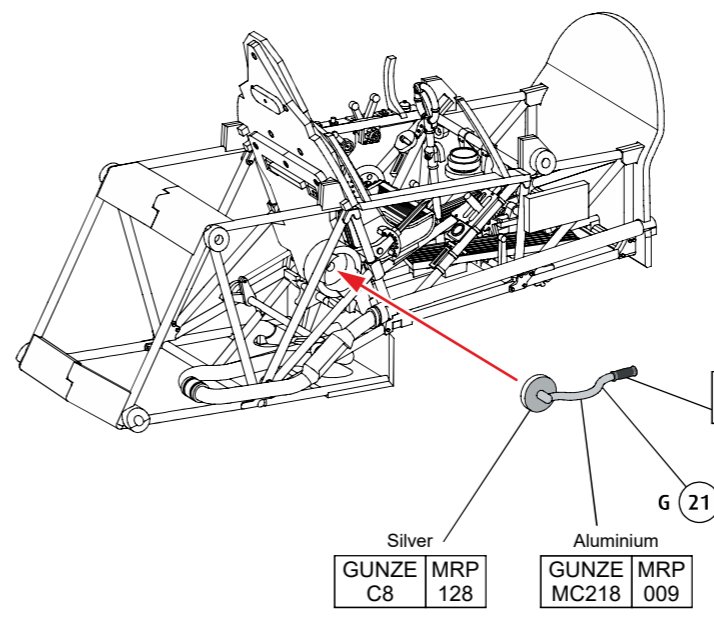

20

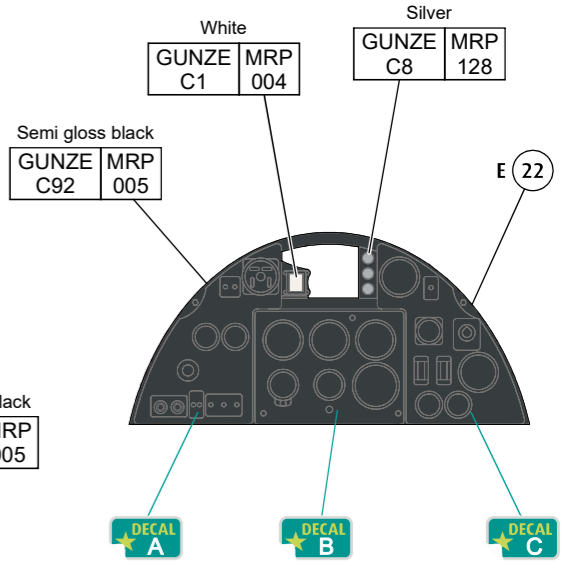

65

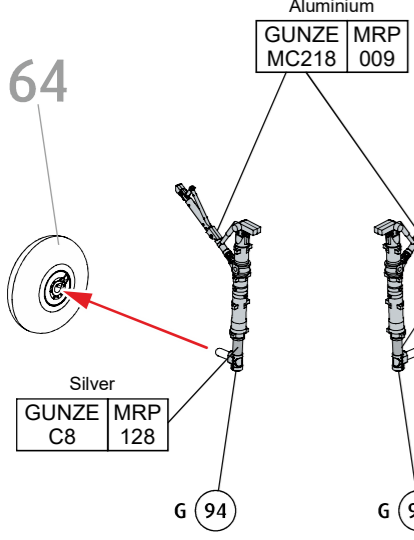

66

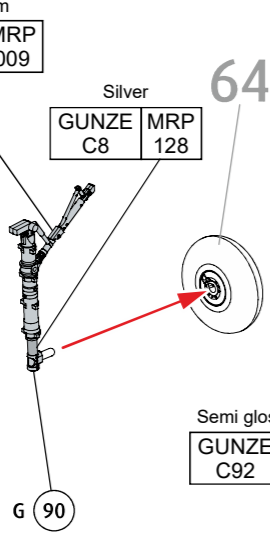

67

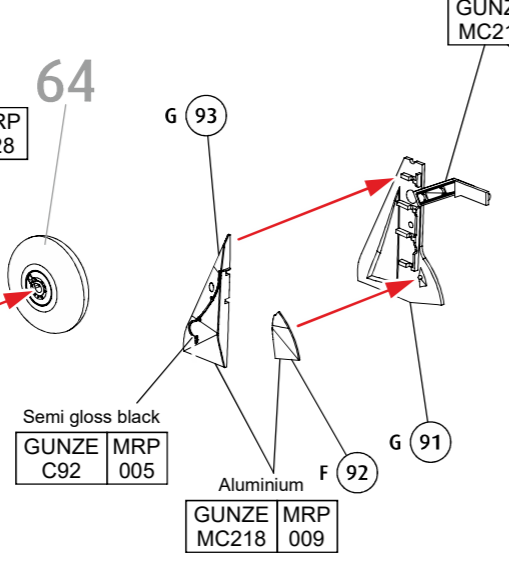

68

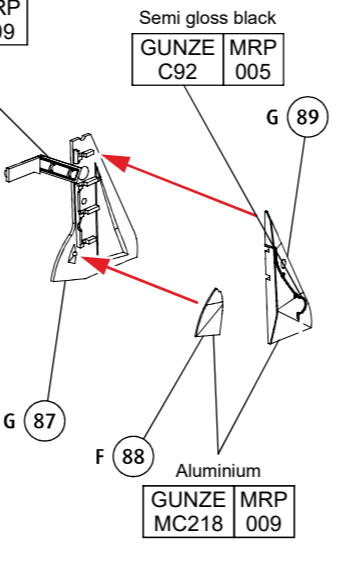

21

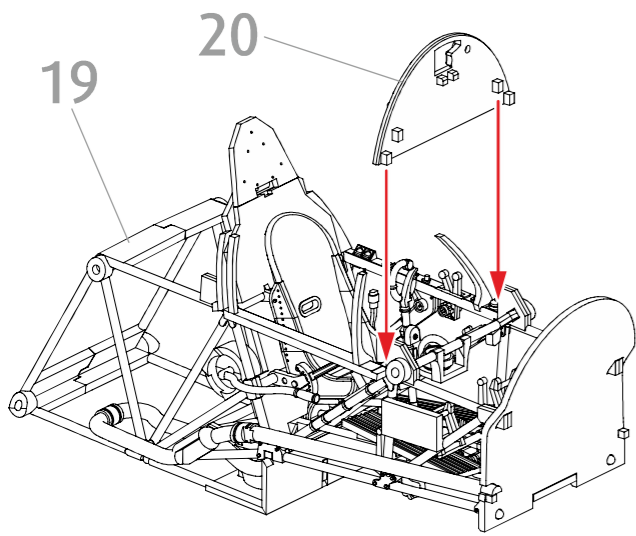

22

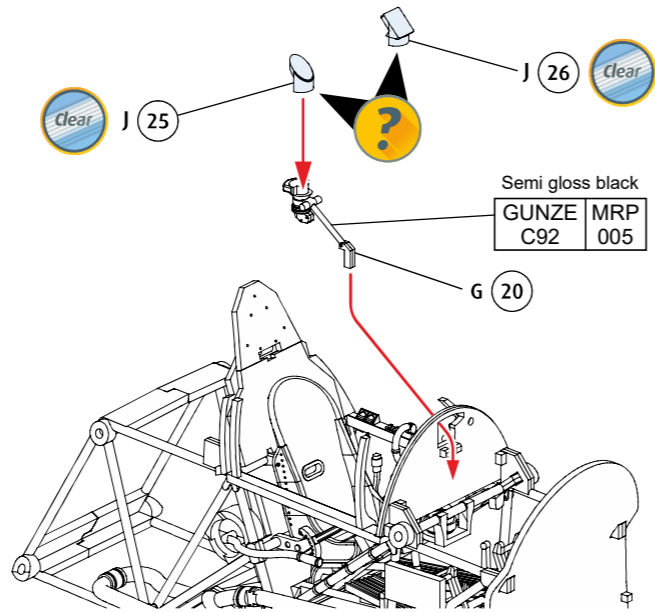

53

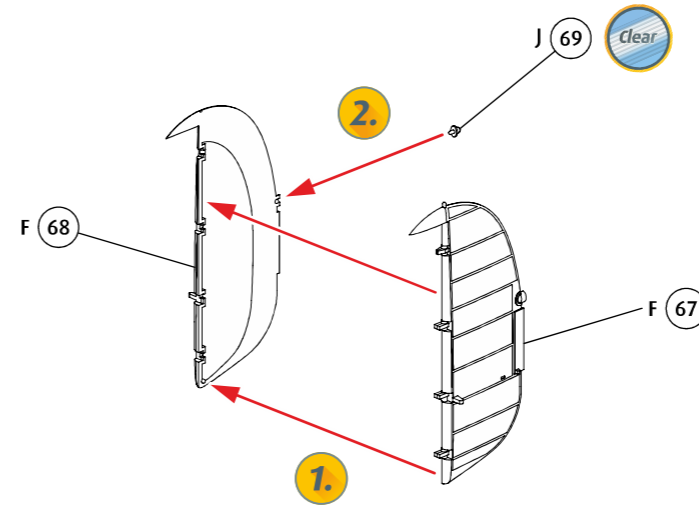

54

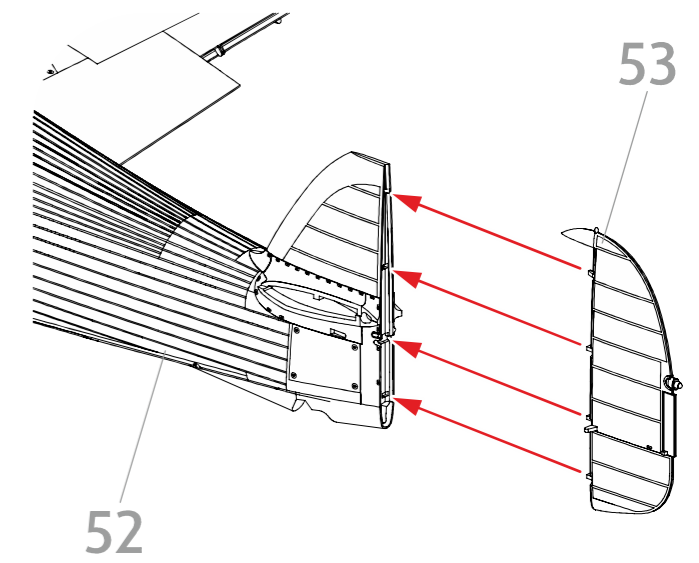

23

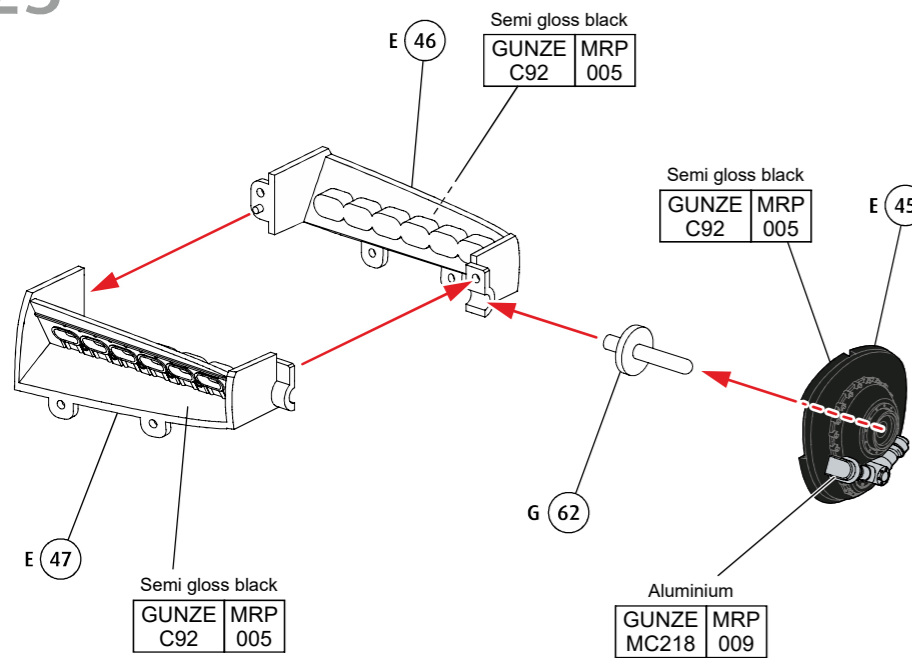

24

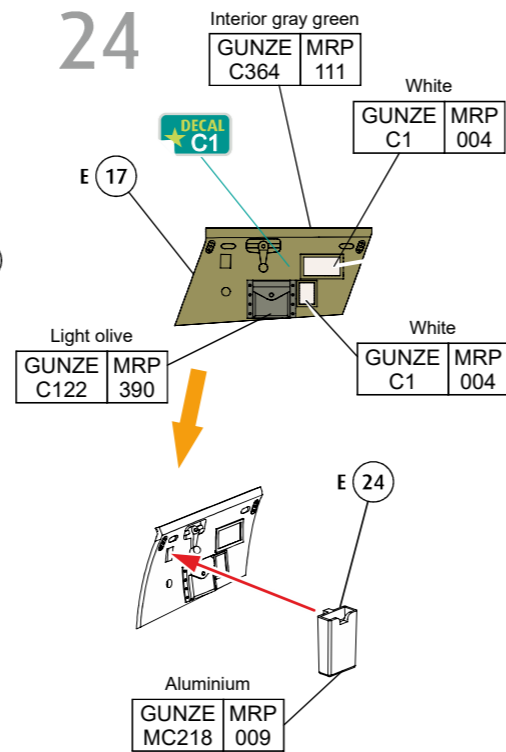

55

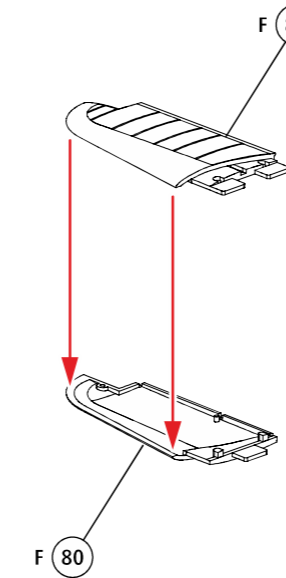

56

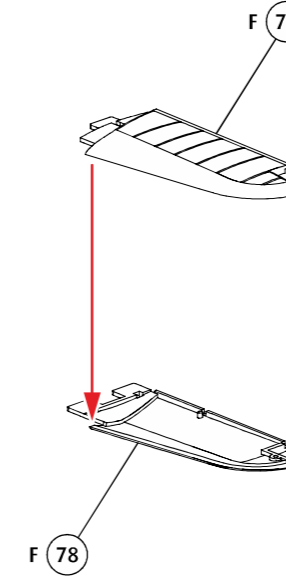

57

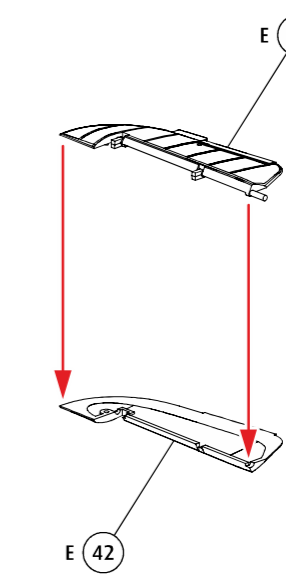

58

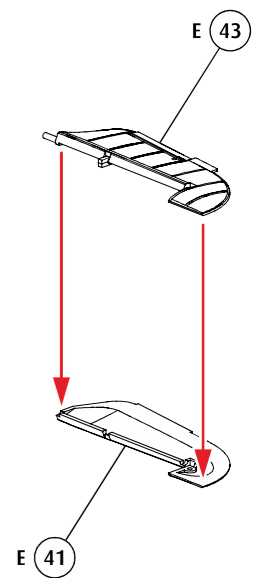

25

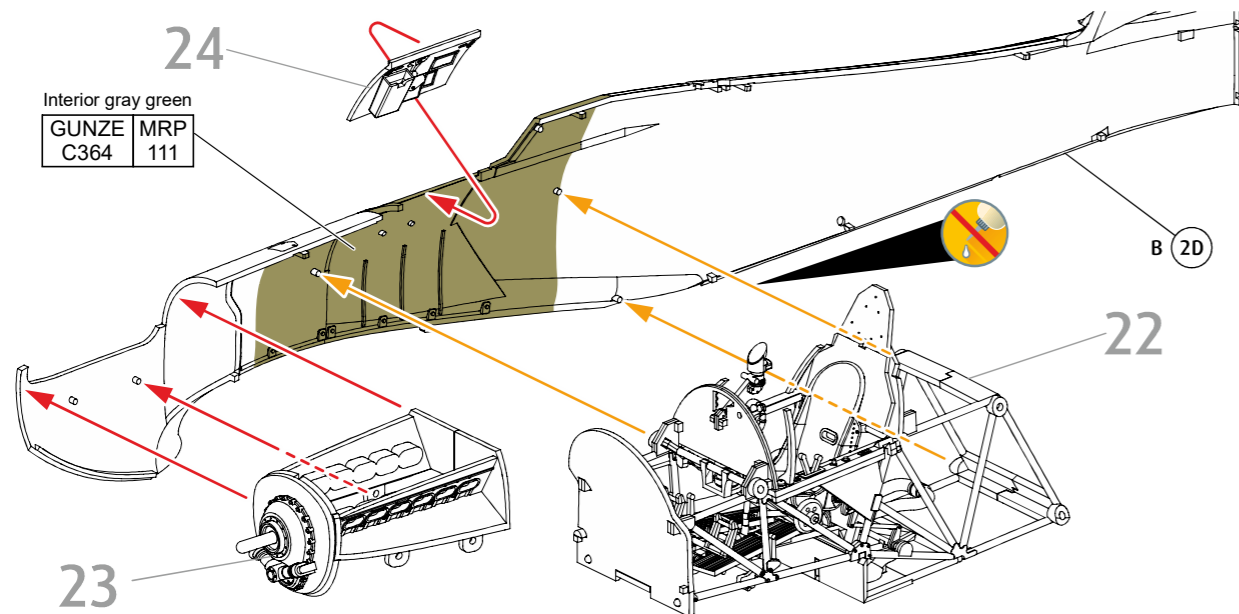

59

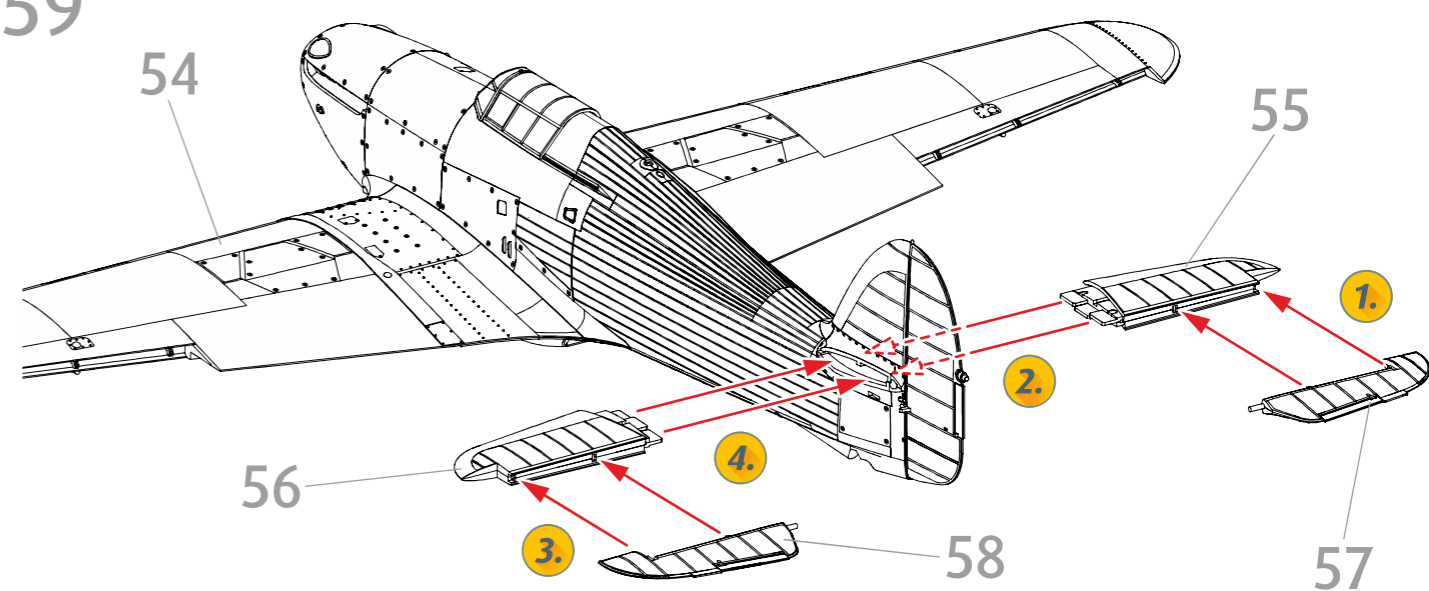

50

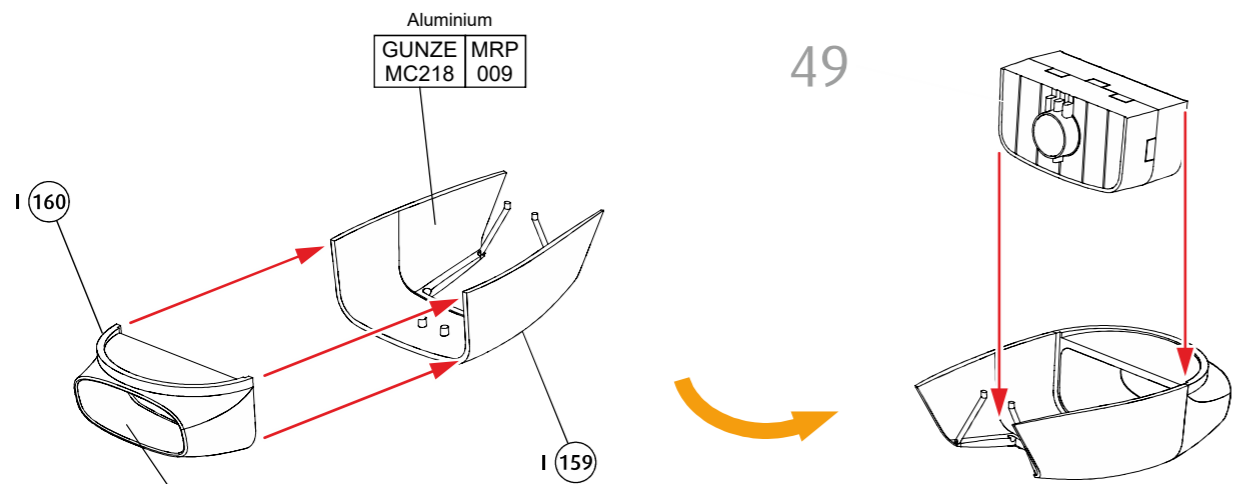

51

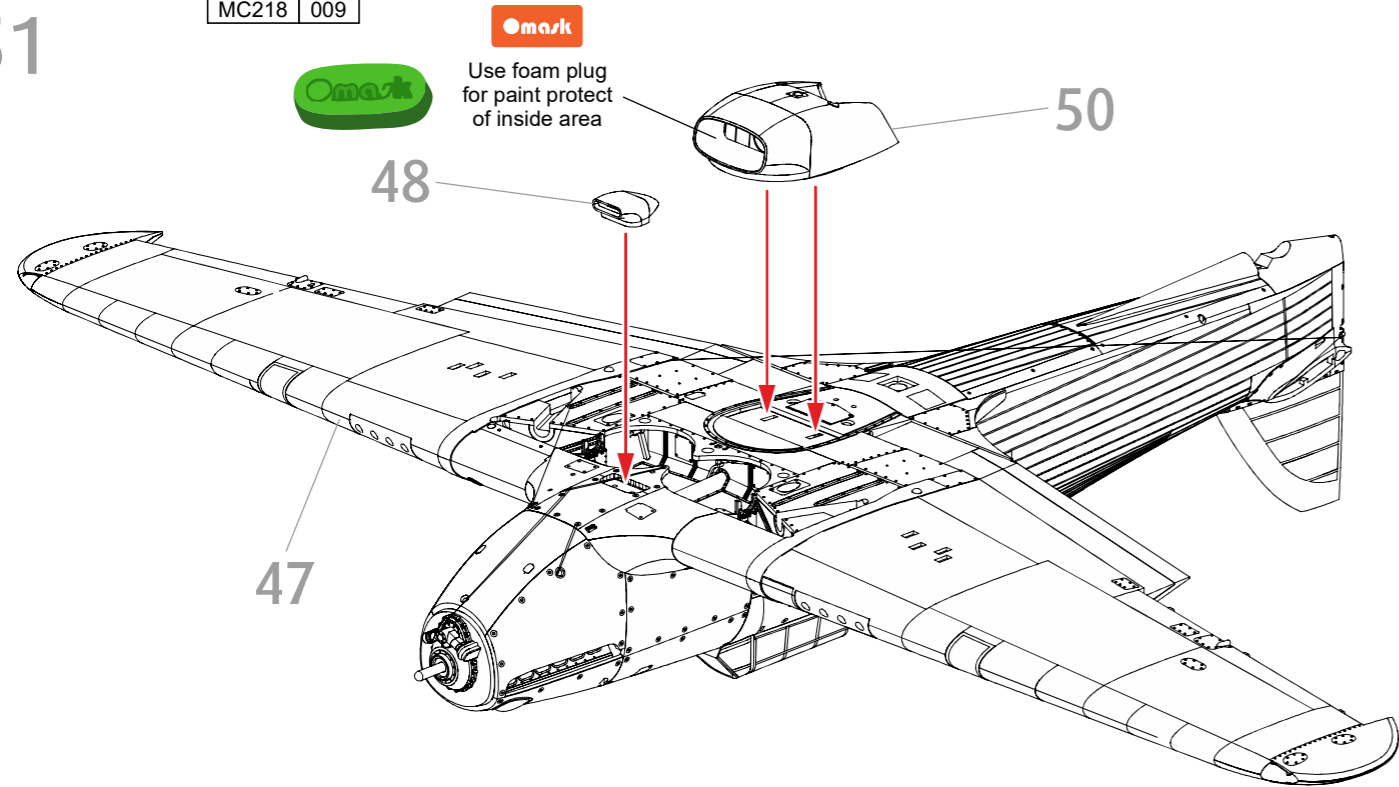

52

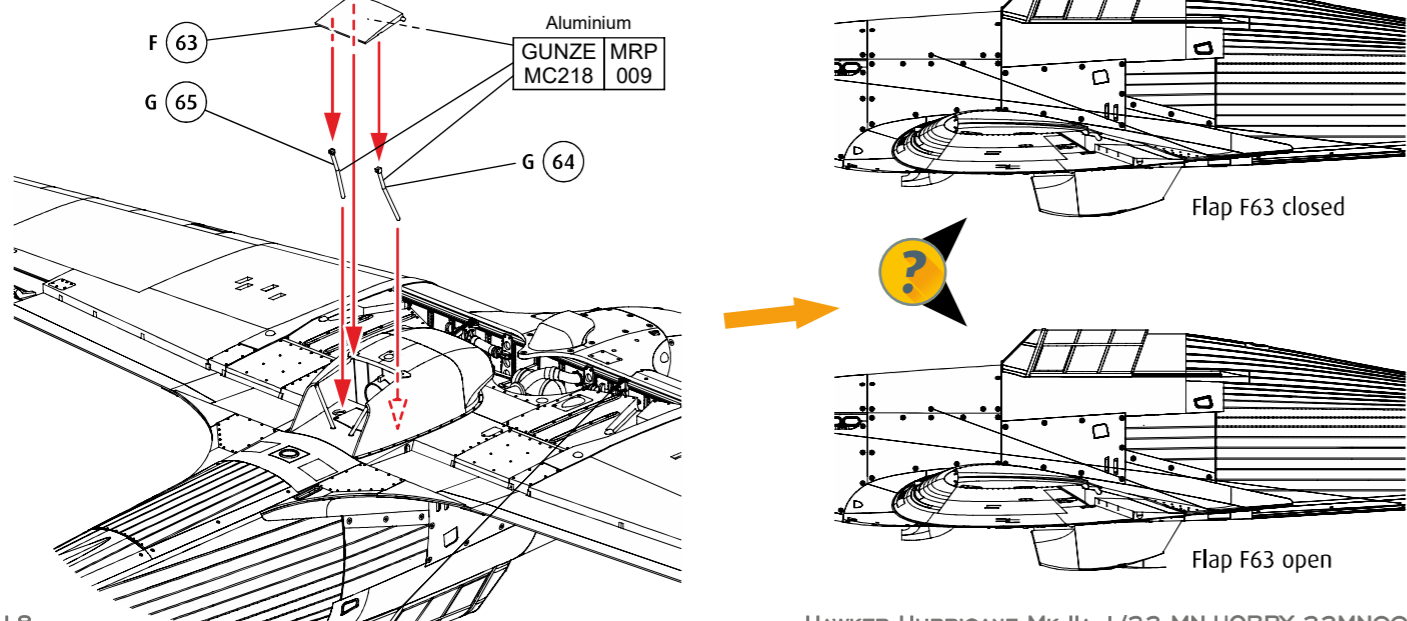

26

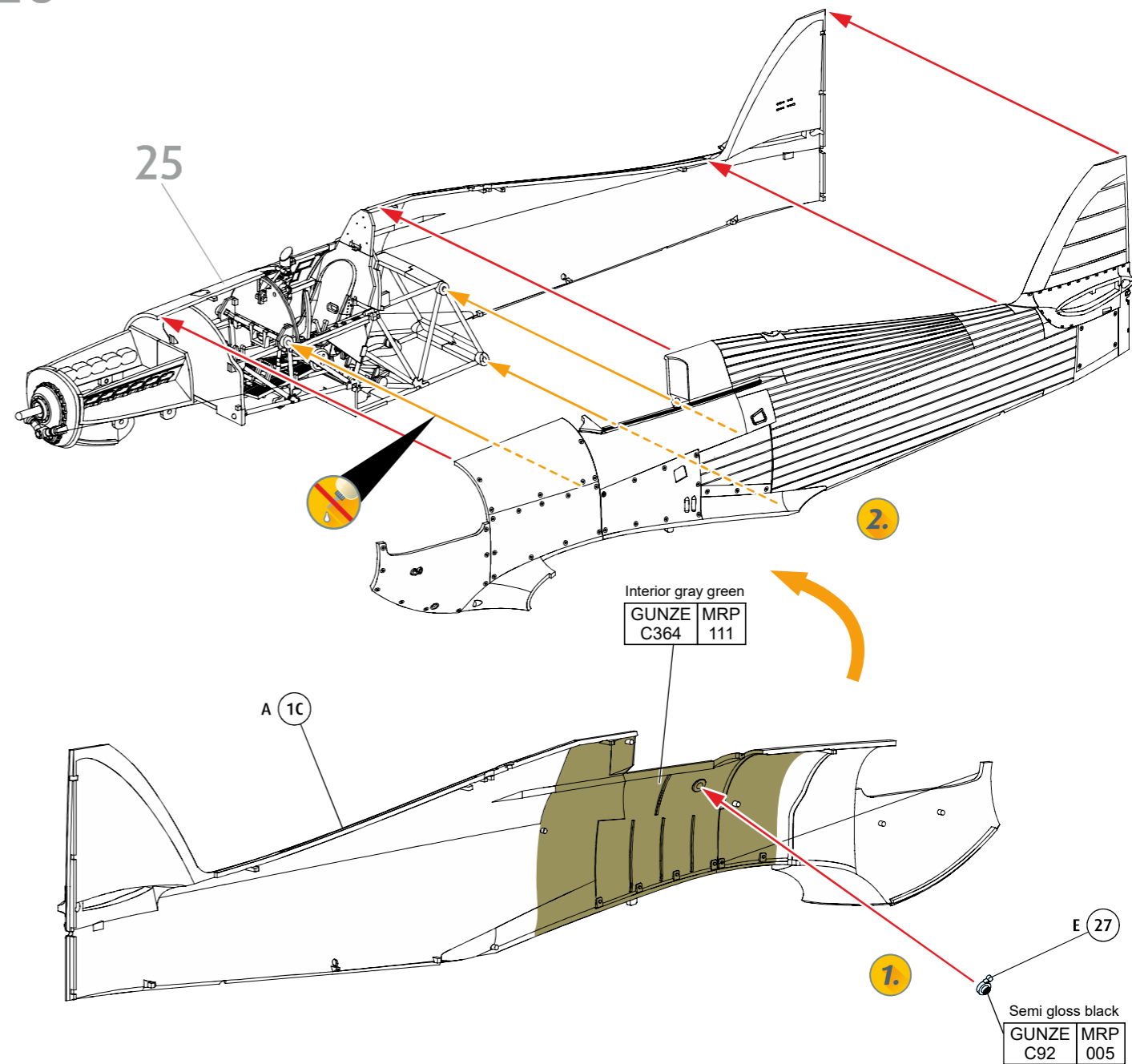

27

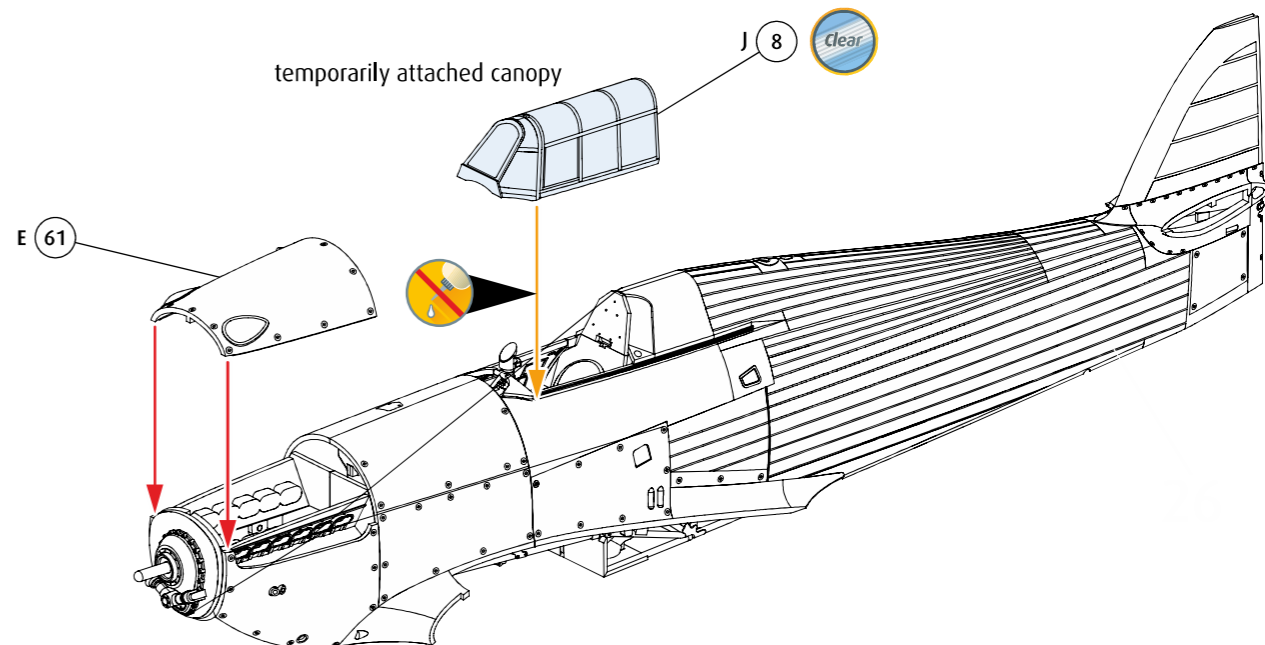

28

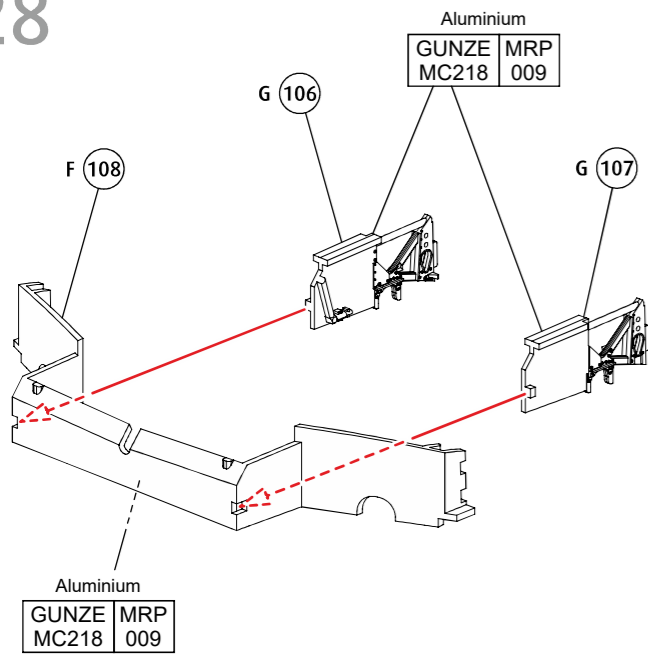

30

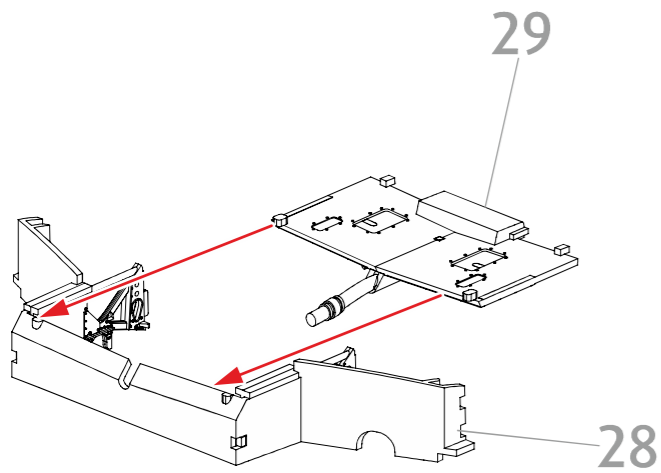

32

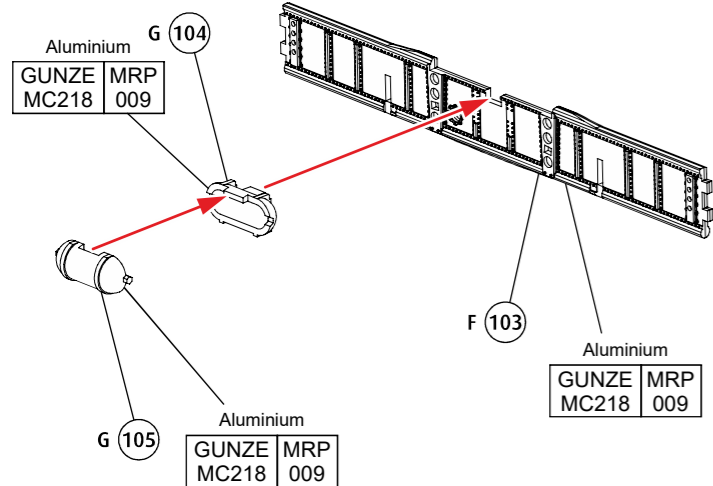

29

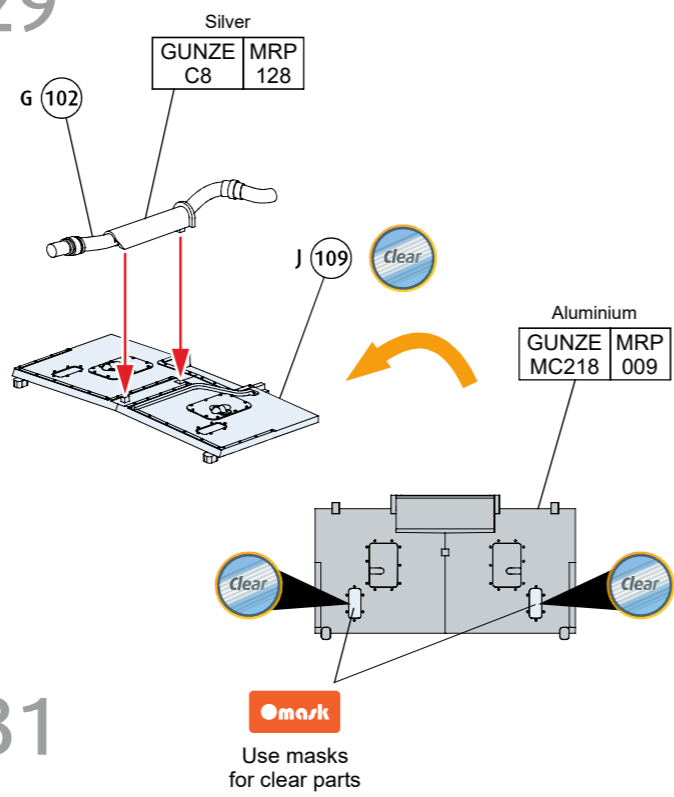

31

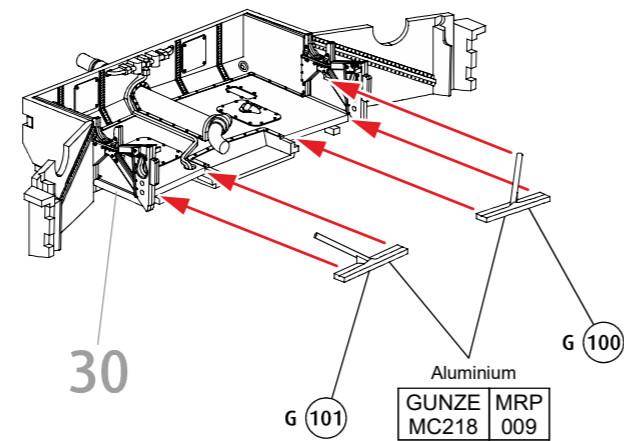

33

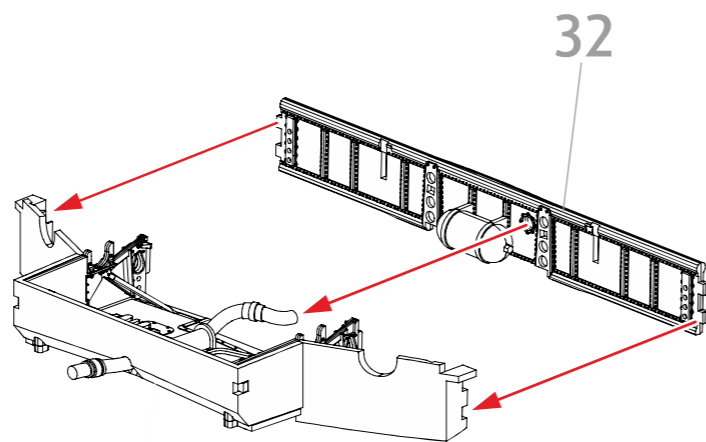

46

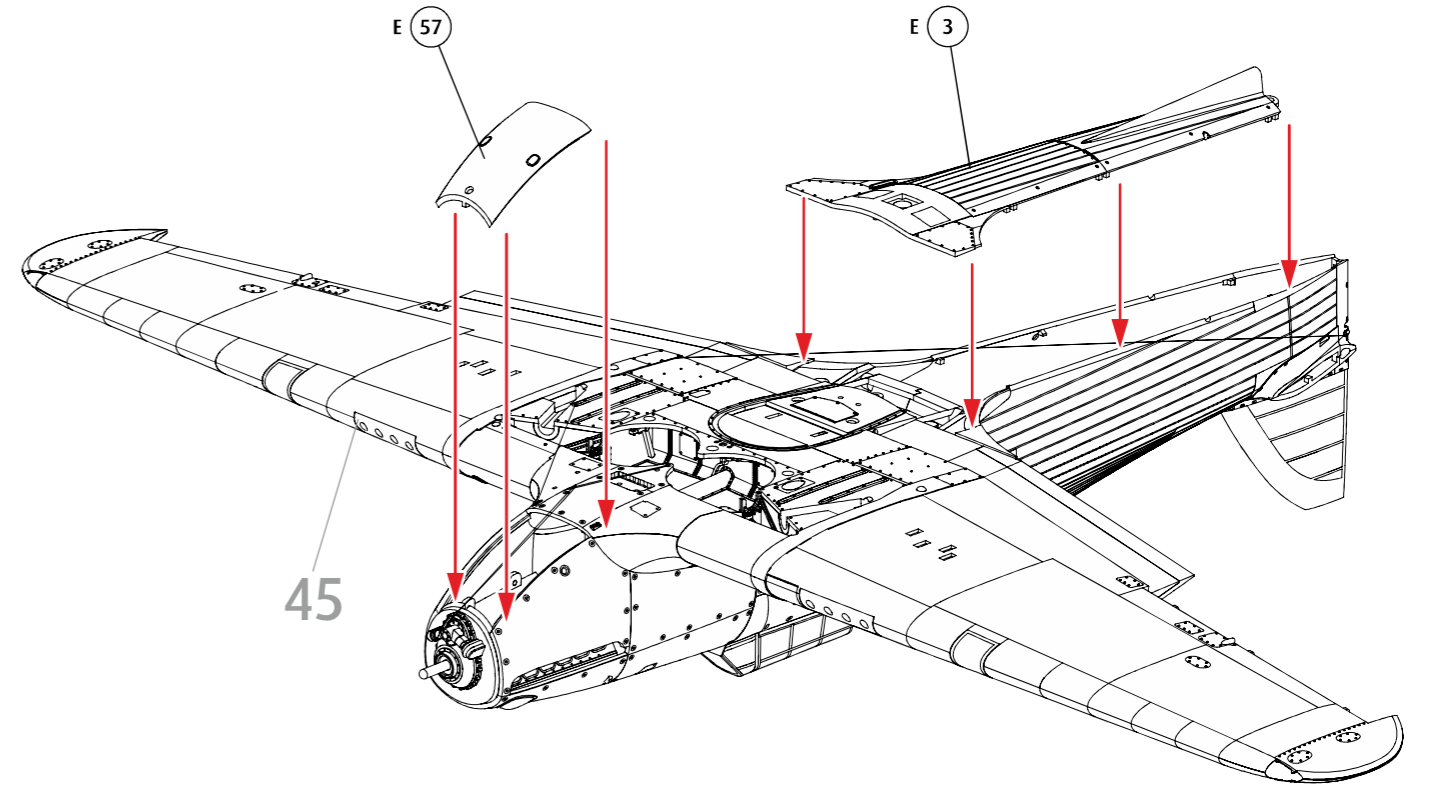

47

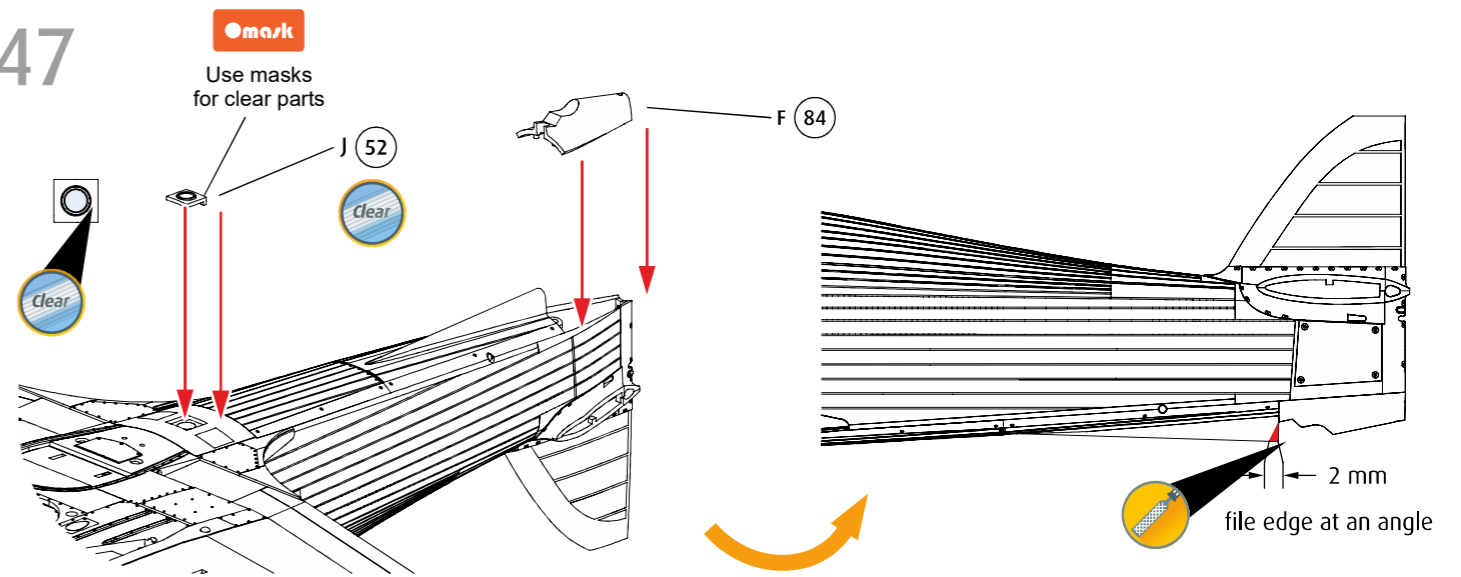

48

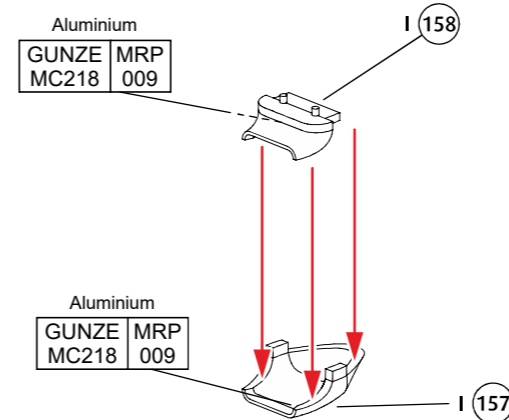

49

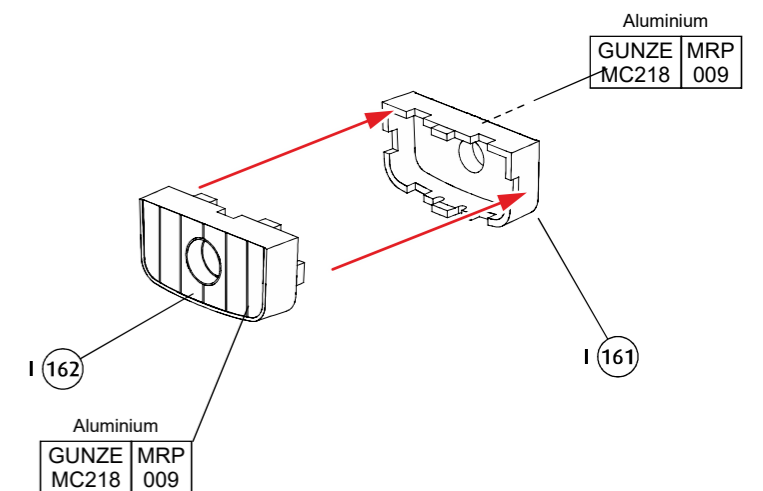

44

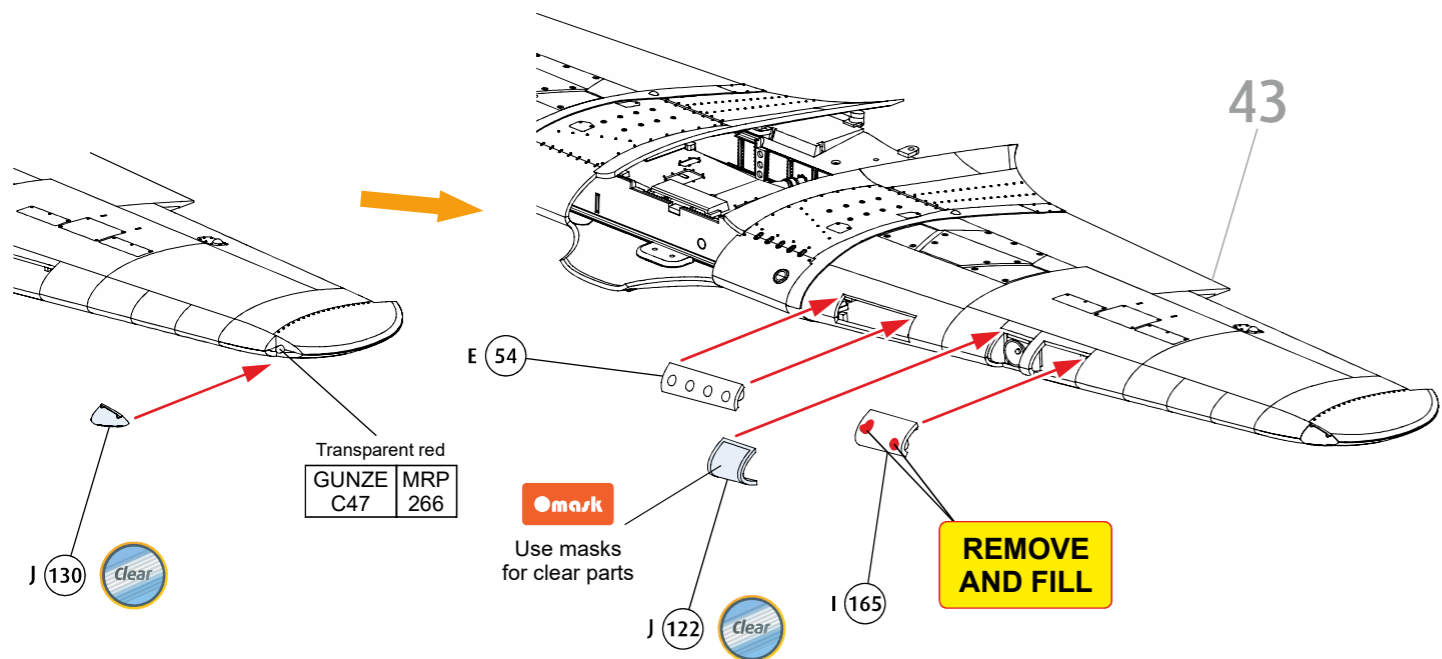

45

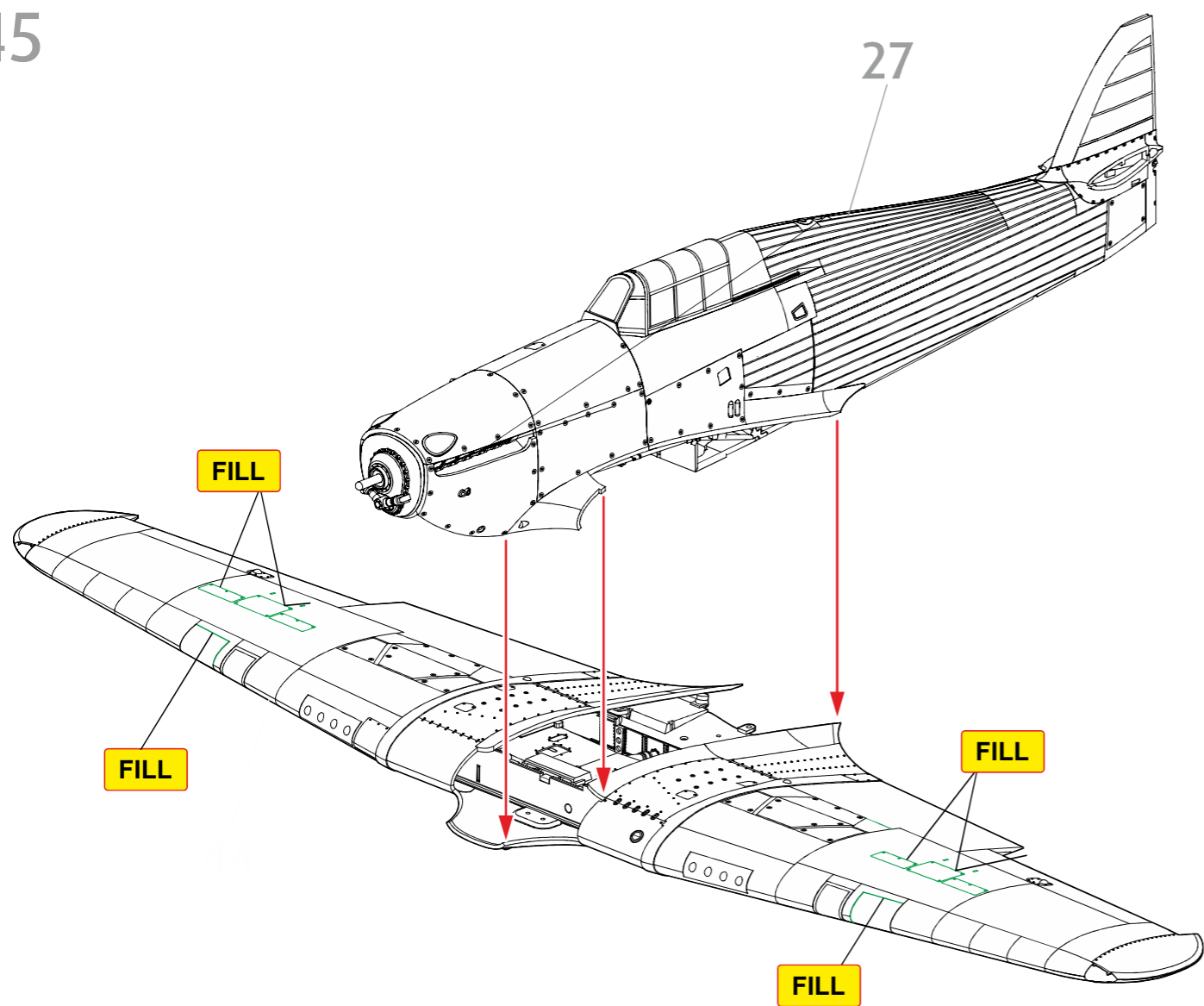

34

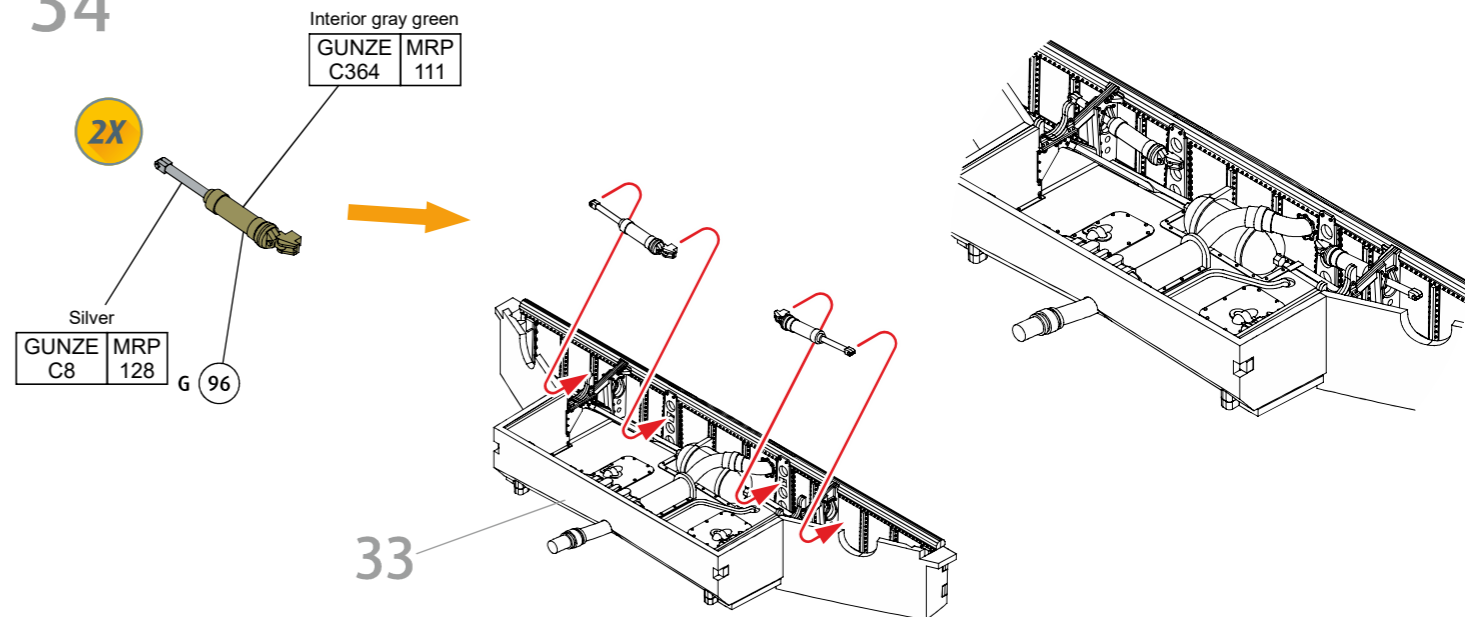

35

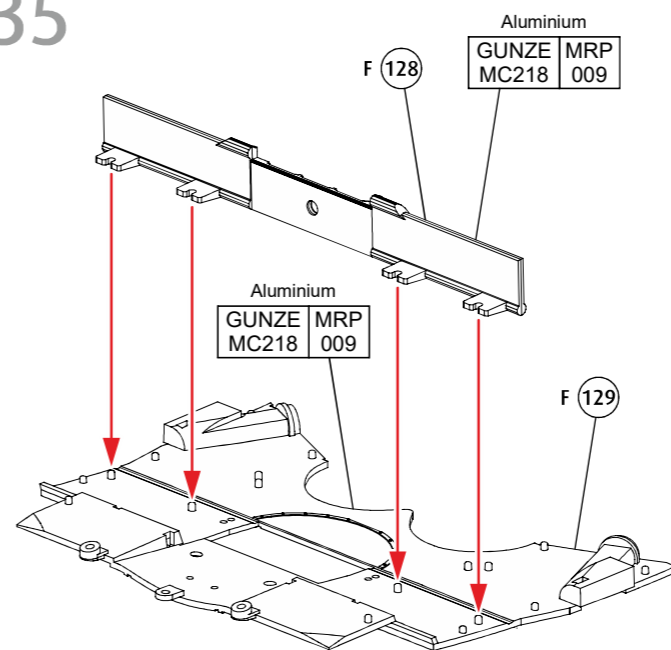

36

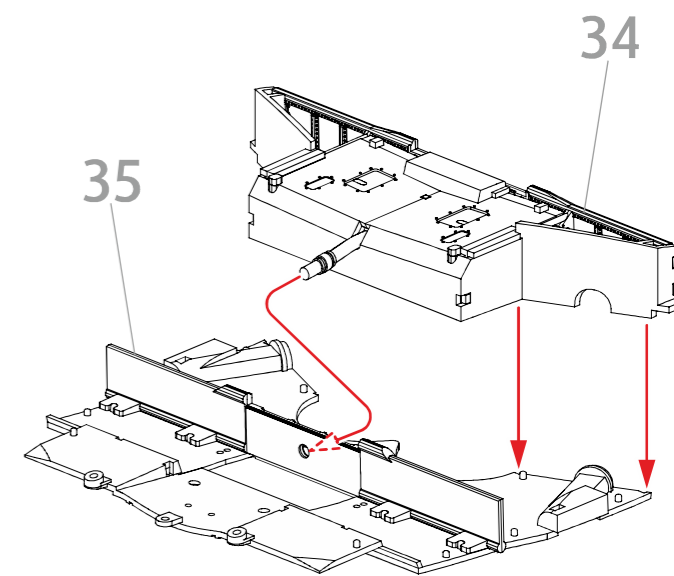

37

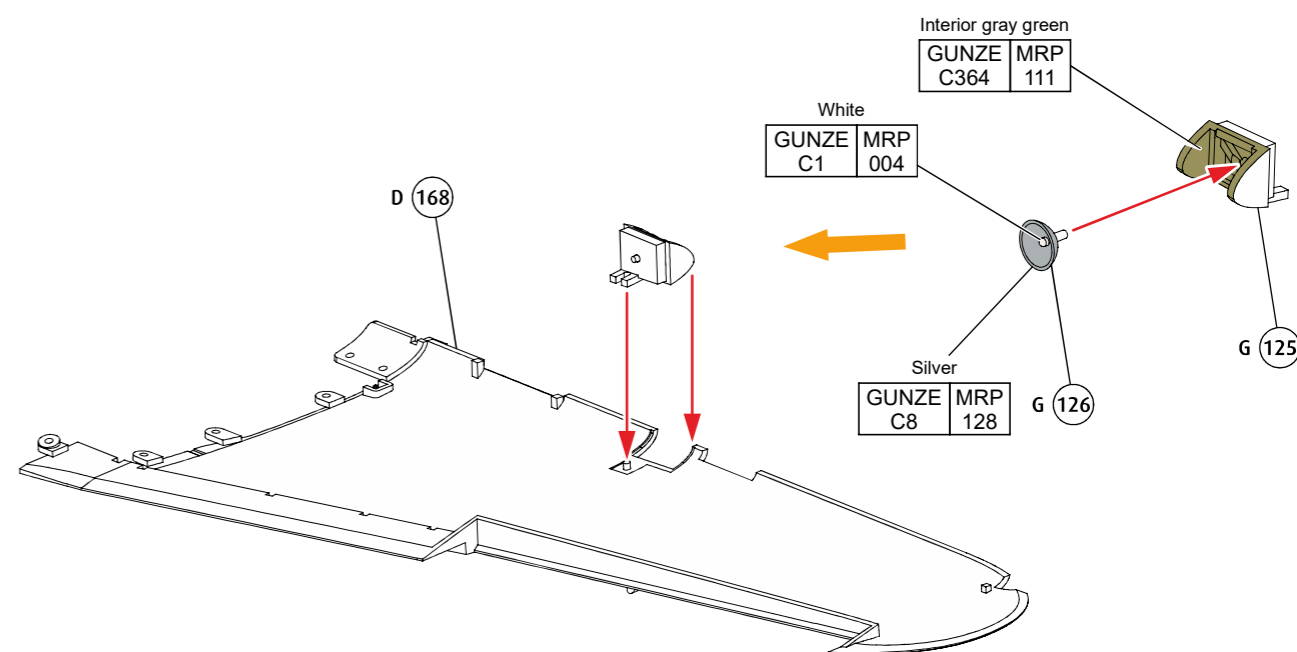

38

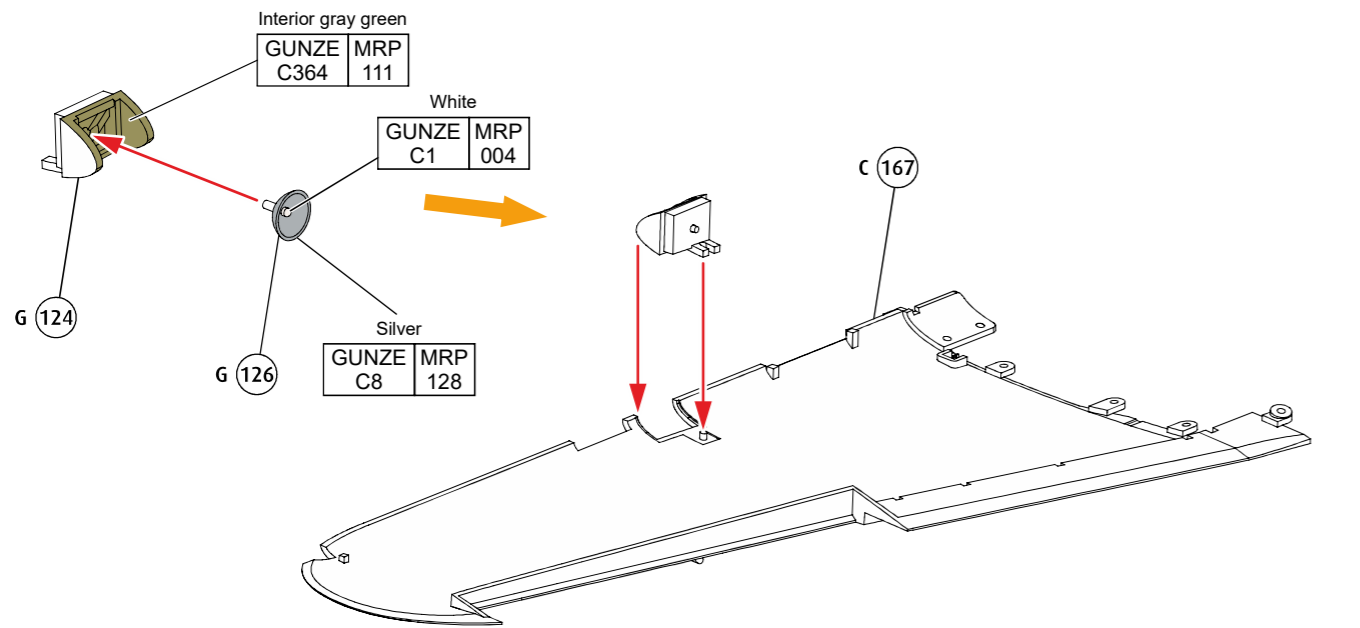

39

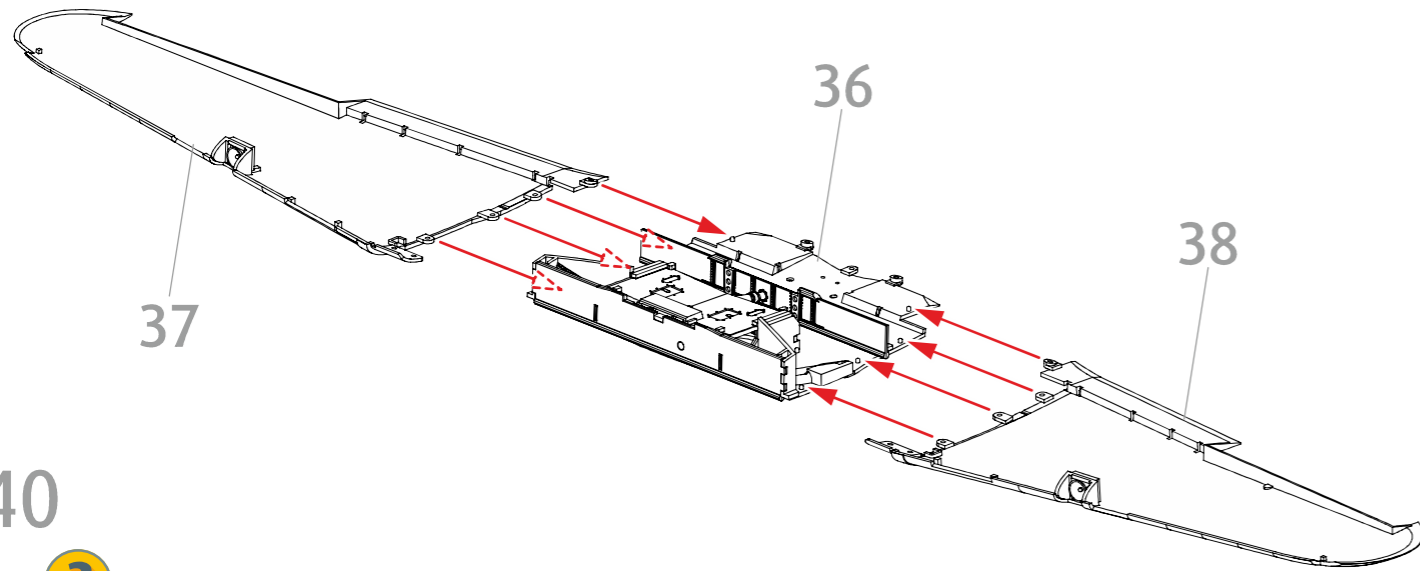

40

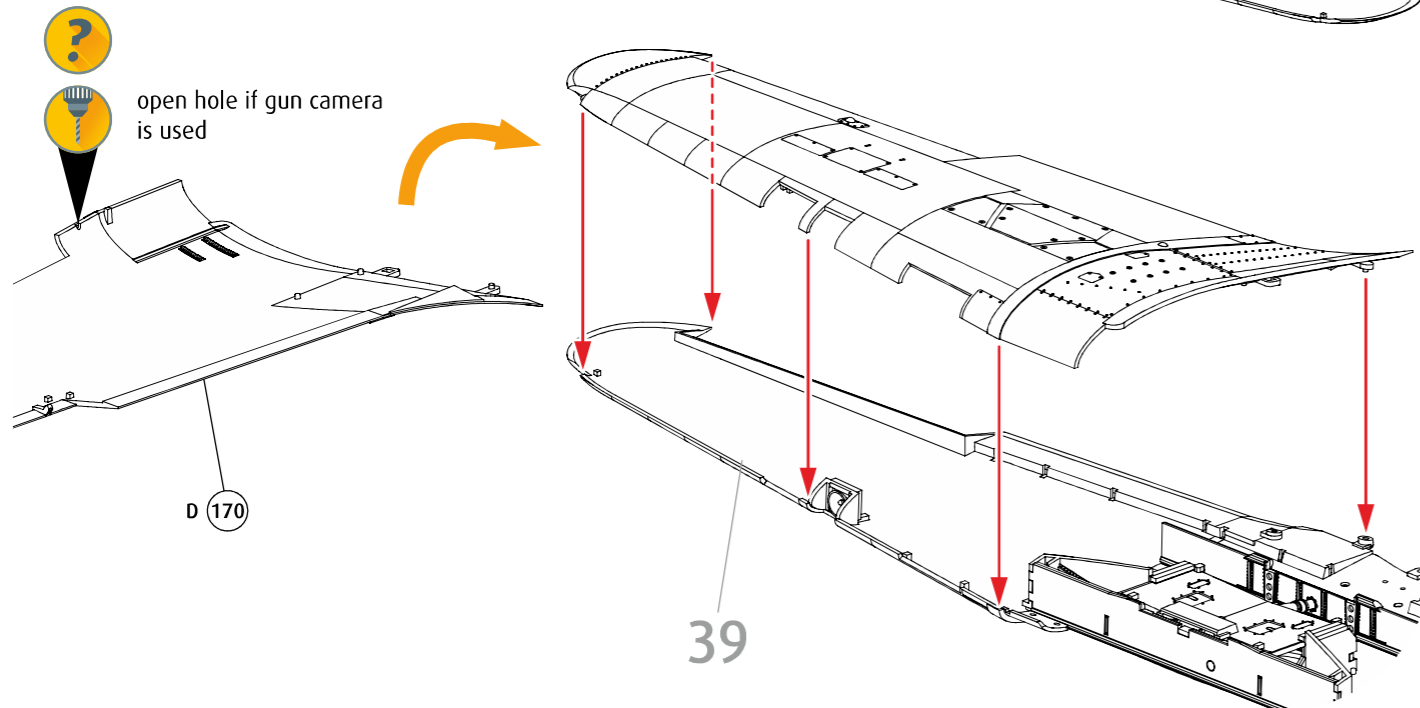

41

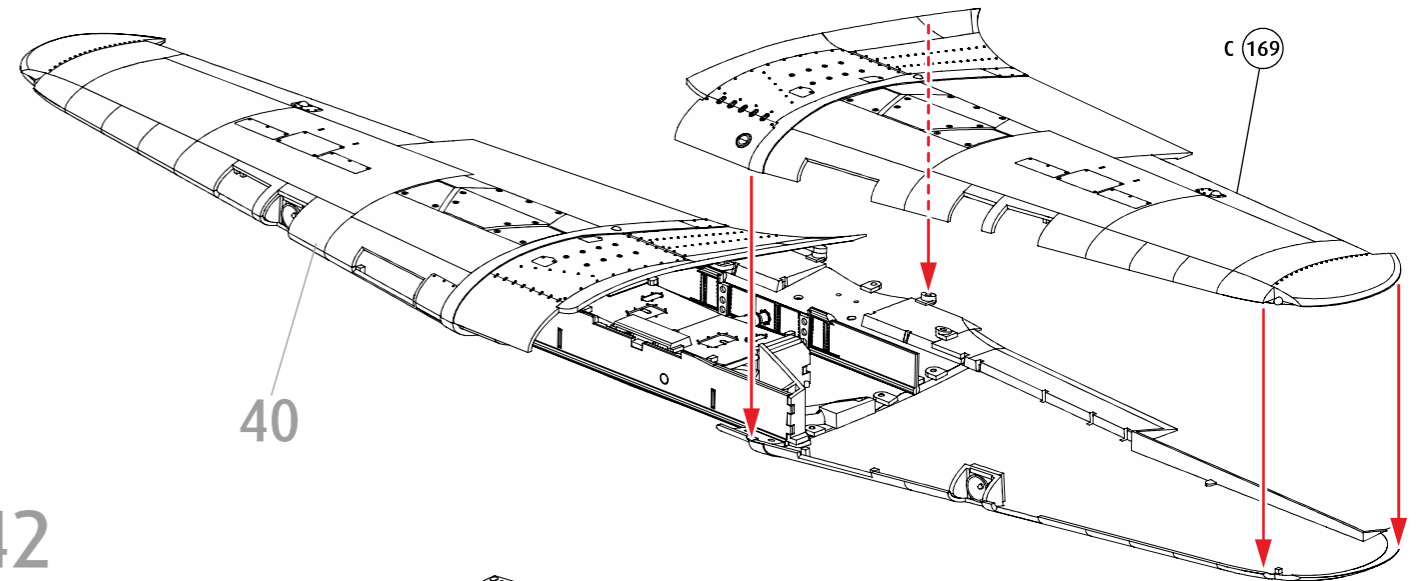

42

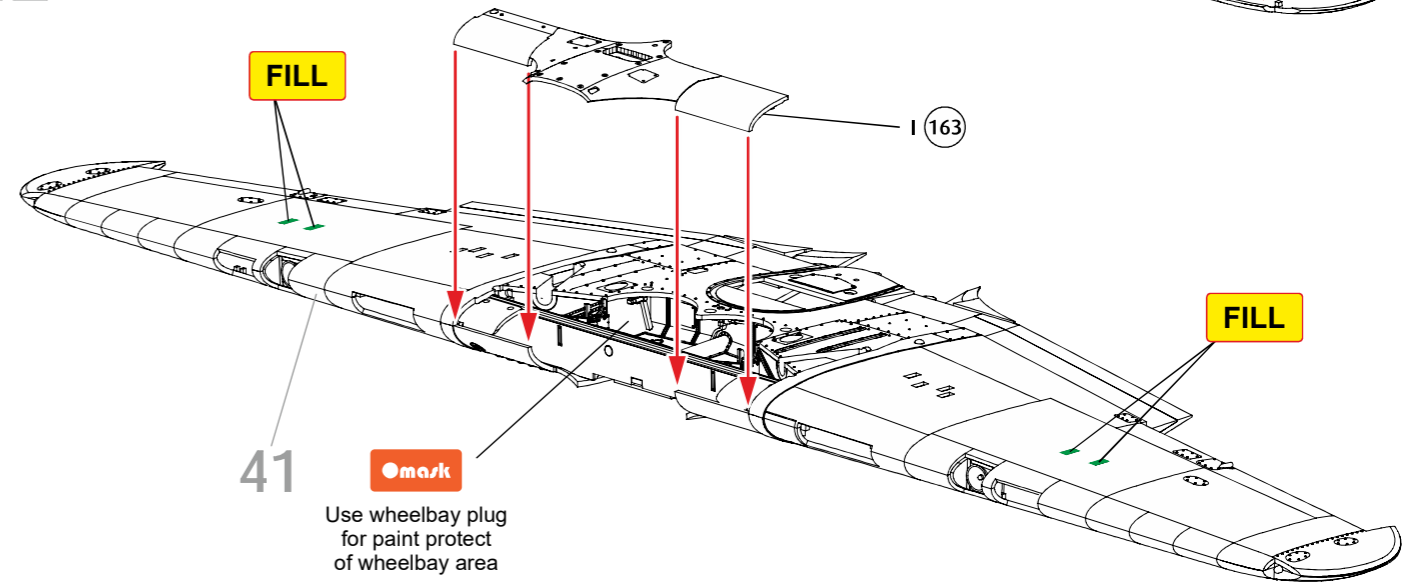

43

